

## **MINUTES OF THE SPECIAL MEETING OF MARCH 16, 2010**

### **BOARD OF TRUSTEES OF ST. PETERSBURG COLLEGE**

The Board of Trustees of St. Petersburg College met on Tuesday, March 16, 2010 at St. Petersburg College Midtown (Rm. 107), 1048 – 22<sup>nd</sup> Street South, St. Petersburg, Florida. The following Board members were present: Chairman Terrence E. Brett, Mrs. Evelyn M. Bilirakis, Mr. Deveron M. Gibbons and Mr. W. Richard Johnston. Also present was Dr. Thomas E. Furlong, Jr., President of St. Petersburg College and Secretary to the Board of Trustees, and Mr. Joseph H. Lang, Board Attorney. Vice Chairman Kenneth P. Burke participated by conference phone.

**10-064.** The meeting was convened by the chairman at 8:30 a.m. The invocation was given by Mr. Gibbons and was immediately followed by the pledge of allegiance.

**10-065.** In accordance with the Administrative Procedure Act, the following Agenda was prepared:

## **AGENDA**

**ST. PETERSBURG COLLEGE BOARD OF TRUSTEES  
TUESDAY, MARCH 16, 2010**

**MIDTOWN CENTER  
1048 – 22<sup>ND</sup> STREET SOUTH  
ST. PETERSBURG, FLORIDA**

**SPECIAL MEETING: 8:30 A.M.  
Hospitality: 8 A.M.**

(THIS MEETING IS OPEN TO THE PUBLIC.)

**PLEASE NOTE: Items contained herein are subject to change  
during a Board meeting before final Board action.**

- I. Call to Order
- II. Invocation
- III. Pledge of Allegiance
- IV. Preliminary Matters

**MINUTES OF THE SPECIAL MEETING OF MARCH 16, 2010**

**BOARD OF TRUSTEES OF ST. PETERSBURG COLLEGE**

- A. Presentation of Retirement Resolutions and Motion for Adoption
  - 1. Eileen Foley, Communications, St. Petersburg/Gibbs Campus
  - 2. Marilyn F. Scott, Criminal Justice In-Service, Allstate Center
- B. Introduction of Employees
- V. Review and Approval of Minutes – Board of Trustees’ Meetings of February 12, 2010 and February 23, 2010
- VI. Old Business (items previously considered but not finalized). NONE
- VII. Report of New Business from the Board Attorney – Joseph H. Lang. **NONE**
- VIII. Report of New Business from the General Counsel – Sydney H. McKenzie III
- IX. Report of New Business from the President
  - A. BIDS, EXPENDITURES AND CONTRACTS (through Purchasing). NONE**
  - B. OTHER EXPENDITURES AND CONTRACTS. NONE**
  - C. GRANTS/RESTRICTED FUNDS CONTRACTS. NONE**
  - D. CAPITAL OUTLAY, MAINTENANCE, RENOVATION, AND CONSTRUCTION**
    - 1. Disposition of Surplus or Obsolete Property (Survey #528)
    - 2. Review of Partial Phase III Construction Documents (Structural and Building Envelope), Project 597-D-10-5, Remodel/Renovate for Classrooms/Labs (College of Education), Olympia Building, Tarpon Springs Campus
    - 3. Amendment to Lease Agreement between St. Petersburg College and National University of Health Sciences (NUHS) for a Lease of Space at the Health Education Center
    - 4. Agreement between St. Petersburg College and BayCare Health System to Lease Space at the District Office

**MINUTES OF THE SPECIAL MEETING OF MARCH 16, 2010**

**BOARD OF TRUSTEES OF ST. PETERSBURG COLLEGE**

5. Amendment #3 to the Educational Plant Survey dated June 19, 2007, (Spot Survey #3) (Veterinary Technology Special Purpose Center, Site 18)
6. Revised CIP-2 Summary Form and CIP-3 Project Explanation Forms from the Capital Improvement Program for FY 2010-2011 through 2014-2015
7. Revised Amendment #2 to the Educational Plant Survey dated June 19, 2007 (Spot Survey #2) (Social Science Building, Clearwater Campus)

**E. AGENCY BILLINGS. NONE**

**F. PERSONNEL**

1. Personnel Report
2. Extension of Aetna Administrative Services
3. Life Insurance Provider

**G. PROPOSED CHANGES TO BOT RULES MANUAL – Public Hearing**

- Rule 6Hx23-4.32 General Education Requirements for Associate Degree Programs

**H. CURRICULUM**

1. Credit Curriculum
2. Noncredit Curriculum and Fees. **NONE**

**I. LEGISLATIVE UPDATE\***

**X. Other Business – Items of Interest from the Board of Trustees**

• **PRESENTATION ON STUDENT SERVICES**

**XI. Confirmation of Next Meeting – Scheduled for Wednesday, April 21, 2010, 8:30 a.m. at the EpiCenter, Largo, Florida**

## **MINUTES OF THE SPECIAL MEETING OF MARCH 16, 2010**

### **BOARD OF TRUSTEES OF ST. PETERSBURG COLLEGE**

If any person wishes to appeal a decision made with respect to any matter considered by the Board at its meeting Tuesday, March 16, 2010, he or she will need a record of the proceedings. It is the obligation of such person to ensure a verbatim record of the proceedings is made, §286.0105, Florida Statutes.

Items summarized on the Agenda may not contain full information regarding the matter being considered. Further information regarding these items may be obtained by calling the Board Clerk at (727) 341-3260.

**\*No packet enclosure**

**10-066.** On behalf of the Board, Chairman Brett commended Ms. Yvonne Ulmer, Campus Executive Officer, Downtown/Midtown, and her staff for the Midtown hospitality, and the Facilities staff for preparing such a beautiful site.

**10-067.** The Board unveiled a tribute to former SPC trustee Cecil B. Keene, Sr. in the Midtown lobby. In response to a Dec. 2008 request by Mr. Keene's Kappa Alpha Psi fraternity brothers, Mr. Gibbons, in the presence of the other trustees, President Furlong, and Mrs. Bernice Keene, honored Mr. Keene's legacy of longtime service to education.

**10-068.** President Furlong recommended adoption of retirement resolutions for Eileen Foley, Communications, St. Petersburg/Gibbs Campus, and Marilyn F. Scott, Criminal Justice In-Service, Allstate Center. Both were in attendance and, joined by colleagues, received their resolutions as presented by Chairman Brett and President Furlong. Mr. Gibbons moved to adopt the resolutions. Mrs. Bilirakis seconded the motion. Mr. Gibbons voted aye; Mr. Johnston voted aye; Mr. Brett voted aye; and Mrs. Bilirakis voted aye. Motion carried.

*Following this item, Mr. Burke joined in the meeting by conference phone.*

**10-069.** The minutes of the Meetings of the Board of Trustees of St. Petersburg College for February 12 and February 23, 2010 were presented by the chairman for approval. Mrs. Bilirakis moved approval of the minutes as submitted. Mr. Johnston seconded the motion. Mr. Gibbons voted aye; Mr. Johnston voted aye; Mr. Brett voted aye; Mr. Burke voted aye; and Mrs. Bilirakis voted aye. Motion carried.

**MINUTES OF THE SPECIAL MEETING OF MARCH 16, 2010**

**BOARD OF TRUSTEES OF ST. PETERSBURG COLLEGE**

**10-070.** Chairman Brett requested a report of any new business from the Board Attorney, Mr. Joseph H. Lang, who stated there was no report.

**10-071.** Chairman Brett requested a report of any new business from the General Counsel, Mr. Syd McKenzie, who stated there was no report.

**10-073.** The president presented Capital Outlay, Maintenance, Renovation, and Construction Items IX-D.1-D.7. Mr. Gibbons moved approval. Mr. Johnston seconded the motion. Mr. Burke confirmed his clarification of Item IX-D.4 (Agreement with BayCare Health System) as a new reduced-amount lease of space rather than a new partnership.

Ms. Susan Reiter, Vice President of Facilities Planning & Institutional Services, was joined by Mr. Michael Carter, Director of Design & Construction, in presenting plans for the Olympia Building at the Tarpon Springs Campus. Following the presentation and opportunity for trustee Q&A, Mr. Gibbons voted aye; Mr. Johnston voted aye; Mr. Brett voted aye; Mr. Burke voted aye; and Mrs. Bilirakis voted aye. Motion carried. *(A copy of the PowerPoint presentation is included as **Attachment A – 10-073.**)*

Information regarding these items is as follows:

Board Material Relating to  
Agenda Item IX-D.1  
Meeting: March 16, 2010

**BOARD OF TRUSTEES  
ST. PETERSBURG COLLEGE**

**Disposition of Surplus or Obsolete Property (Survey # 528)**

The items of tangible personal property that follow have been declared as surplus or obsolete and are of no further economical use to the College. Regarding the retirement of desktop computers, the College's Technology Oversight Group (TOG) recommends that any desktop computer comparable to or older than the Dell GX270 model be moved to surplus. Any laptop computer comparable to or older than the Dell D800 model, or any C series (or comparable) should be

**MINUTES OF THE SPECIAL MEETING OF MARCH 16, 2010**

**BOARD OF TRUSTEES OF ST. PETERSBURG COLLEGE**

moved to surplus. These older computers do not efficiently support the Windows 2000 and beyond operating systems and application suites.

**Pursuant to Board of Trustees Rule 6Hx23-5.13 (IV), the Property Survey Committee requests authorization to sell or otherwise dispose of this property in the manner prescribed by Chapter 274, Florida Statutes.**

Tag Number	Description	Acquisition Date	Condition	Sum Amount
11026	Superstack li Port Switch	4/21/1997	obsolete	\$1,187.66
11027	Superstack li Port Switch	4/21/1997	obsolete	\$1,187.67
11028	Superstack li Port Switch	4/21/1997	obsolete	\$1,187.67
14443	12 Port Ent Switch	11/19/1998	obsolete	\$1,500.00
14444	24 Port Ent Switch	11/19/1998	obsolete	\$2,500.00
14469	Projector:LCD Video/Data	4/7/1999	obsolete	\$1,995.00
14478	Projector:LCD Video/Data	4/7/1999	obsolete	\$1,995.00
14480	Projector:LCD Video/Data	4/7/1999	obsolete	\$1,995.00
14722	Projector:Epson	6/19/1999	obsolete	\$5,542.90
15638	Printer: Lexmark 1855N	8/26/1999	obsolete	\$1,308.91
15639	Printer: Lexmark 1855N	8/26/1999	obsolete	\$1,308.91
15640	Printer: Lexmark 1855N	8/26/1999	obsolete	\$1,308.91
15772	Computer: Dell PIII 500K GX1p/	9/30/1999	obsolete	\$1,707.00
15779	Computer: Dell PIII 500K GX1p/	9/30/1999	obsolete	\$1,499.00
16855	Computer:Dell 500 Pentium III	2/24/2000	obsolete	\$1,342.00
17084	24 Port 10MB Switch	4/18/2000	obsolete	\$1,167.52
17091	24 Port 10 Mb Switch	4/18/2000	obsolete	\$1,167.52
17093	24 Port 10 Mb Switch	4/18/2000	obsolete	\$1,167.51
17632	Computer: Dell GX240	11/28/2001	obsolete	\$1,598.00
17970	Computer: Dell GX240	12/7/2001	obsolete	\$1,598.00
18068	Switch:Cisco	8/11/2000	obsolete	\$1,152.60
18074	Switch:Cisco	8/11/2000	obsolete	\$1,152.60
18076	Switch:Cisco	8/11/2000	obsolete	\$1,152.60
18104	Laptop Computer:Dell Latitude	9/8/2000	obsolete	\$2,134.00
18803	Computer:Dell GX110	1/11/2001	obsolete	\$1,362.00

**MINUTES OF THE SPECIAL MEETING OF MARCH 16, 2010**

**BOARD OF TRUSTEES OF ST. PETERSBURG COLLEGE**

18867	Laptop Computer:Dell Latitude	2/22/2001	obsolete	\$2,281.00
19272	Laptop Computer:Dell Latitude	5/2/2001	obsolete	\$2,494.50
19407	Computer:Dell GX150	6/28/2001	obsolete	\$1,871.49
20092	Computer:Dell GX150	7/24/2001	obsolete	\$1,055.00
20499	Computer:Dell GX400	12/10/2001	obsolete	\$1,337.00
20510	Computer: Dell GX400	1/7/2002	obsolete	\$1,660.40
20539	Computer: Dell GX400	3/28/2002	obsolete	\$1,588.00
20542	Computer:Dell GX240	4/3/2002	obsolete	\$1,205.00
20558	Computer: Dell GX240	4/19/2002	obsolete	\$1,564.68
20559	Computer: Dell GX240	4/19/2002	obsolete	\$1,564.68
20565	Computer:Dell GX240	4/24/2002	obsolete	\$1,564.68
20855	Computer: Dell GX240	11/13/2001	obsolete	\$1,313.95
20949	Computer: Dell GX240	11/13/2001	obsolete	\$1,302.95
20974	Computer: Dell GX240	11/13/2001	obsolete	\$1,313.95
21076	Computer: Dell GX240	11/13/2001	obsolete	\$1,302.95
21078	Computer: Dell GX240	11/13/2001	obsolete	\$1,313.95
21079	Computer: Dell GX240	11/13/2001	obsolete	\$1,302.95
21120	Computer: Dell GX240	12/7/2001	obsolete	\$1,598.00
21124	Computer: Dell GX240	12/7/2001	obsolete	\$1,598.00
21125	Computer: Dell GX240	12/7/2001	obsolete	\$1,598.00
21128	Computer: Dell GX240	12/7/2001	obsolete	\$1,598.00
21130	Computer: Dell GX240	12/7/2001	obsolete	\$1,598.00
21131	Computer: Dell GX240	12/7/2001	obsolete	\$1,598.00
21137	Computer: Dell GX240	12/7/2001	obsolete	\$1,598.00
21145	Computer: Dell GX240	12/7/2001	obsolete	\$1,598.00
21150	Computer: Dell GX240	12/7/2001	obsolete	\$1,598.00
21151	Computer: Dell GX240	12/7/2001	obsolete	\$1,598.00
21155	Computer: Dell GX240	12/7/2001	obsolete	\$1,598.00
21156	Computer: Dell GX240	12/7/2001	obsolete	\$1,598.00
21160	Computer: Dell GX240	12/7/2001	obsolete	\$1,598.00
21161	Computer: Dell GX240	12/7/2001	obsolete	\$1,598.00
21162	Computer: Dell GX240	11/28/2001	obsolete	\$1,598.00

**MINUTES OF THE SPECIAL MEETING OF MARCH 16, 2010**

**BOARD OF TRUSTEES OF ST. PETERSBURG COLLEGE**

21163	Computer: Dell GX240	11/28/2001	obsolete	\$1,598.00
21166	Computer: Dell GX240	11/28/2001	obsolete	\$1,598.00
21167	Computer: Dell GX240	12/7/2001	obsolete	\$1,598.00
21169	Computer: Dell GX240	11/28/2001	obsolete	\$1,598.00
21172	Computer: Dell GX240	12/7/2001	obsolete	\$1,598.00
21173	Computer: Dell GX240	12/7/2001	obsolete	\$1,598.00
21175	Computer: Dell GX240	12/7/2001	obsolete	\$1,598.00
21176	Computer: Dell GX240	12/7/2001	obsolete	\$1,598.00
21177	Computer: Dell GX240	12/7/2001	obsolete	\$1,598.00
21180	Computer: Dell GX240	12/7/2001	obsolete	\$1,598.00
21270	Computer: Dell GX240	12/11/2001	obsolete	\$1,131.00
21271	Computer: Dell GX240	12/11/2001	obsolete	\$1,131.00
21272	Computer: Dell GX240	12/11/2001	obsolete	\$1,131.00
21273	Computer: Dell GX240	12/11/2001	obsolete	\$1,131.00
21276	Computer: Dell GX240	12/11/2001	obsolete	\$1,131.00
21281	Computer: Dell GX240	12/11/2001	obsolete	\$1,131.00
21283	Computer: Dell GX240	12/11/2001	obsolete	\$1,131.00
21285	Computer: Dell GX240	12/11/2001	obsolete	\$1,131.00
21288	Computer: Dell GX240	12/11/2001	obsolete	\$1,131.00
21290	Computer: Dell GX240	12/11/2001	obsolete	\$1,131.00
21373	Computer: Dell GX240	12/19/2001	obsolete	\$1,018.00
22122	Printer:Color Laser	4/29/2002	obsolete	\$3,252.87
22389	Laptop Computer:Dell Latitude	6/18/2002	obsolete	\$1,973.28
22390	Computer: Dell GX260T	6/20/2002	obsolete	\$1,226.00
22393	Computer: Dell GX260T	6/20/2002	obsolete	\$1,226.00
22394	Computer: Dell GX260T	6/20/2002	obsolete	\$1,226.00
22419	Computer: Dell GX260S	7/2/2002	obsolete	\$1,201.00
22597	Computer: Dell GX260T	6/12/2002	obsolete	\$1,513.00
22609	Computer: Dell GX260T	6/18/2002	obsolete	\$1,513.00
22626	Computer: Dell GX260T	6/19/2002	obsolete	\$1,513.00
22637	Computer: Dell GX260T	6/19/2002	obsolete	\$1,513.00
22659	Computer: Dell GX260T	6/27/2002	obsolete	\$1,513.00



**MINUTES OF THE SPECIAL MEETING OF MARCH 16, 2010**

**BOARD OF TRUSTEES OF ST. PETERSBURG COLLEGE**

22660	Computer: Dell GX260T	6/27/2002	obsolete	\$1,513.00
22695	Computer: Dell GX260T	6/25/2002	obsolete	\$1,281.95
22712	Computer: Dell GX260T	6/25/2002	obsolete	\$1,281.95
22715	Computer: Dell GX260T	6/25/2002	obsolete	\$1,281.95
22718	Computer: Dell GX260T	6/25/2002	obsolete	\$1,281.95
22836	Computer: Dell GX260T	6/27/2002	obsolete	\$1,731.00
22840	Computer: Dell GX260T	6/27/2002	obsolete	\$1,731.00
22850	Computer: Dell GX260T	6/27/2002	obsolete	\$1,731.00
23204	4-Slot Modular Router	5/23/2002	obsolete	\$12,122.50
23205	4-Slot Modular Router	5/23/2002	obsolete	\$12,122.50
23206	4-Slot Modular Router	5/23/2002	obsolete	\$12,122.50
23207	4-Slot Modular Router	5/23/2002	obsolete	\$12,122.50
23208	VPN Termination Device	5/23/2002	obsolete	\$2,600.00
23209	VPN Termination Device	5/23/2002	obsolete	\$2,600.00
23210	VPN Termination Device	5/23/2002	obsolete	\$2,600.00
23215	20-Port Token Ring Switch	6/10/2002	obsolete	\$5,388.50
23289	Computer: Dell GX260T	8/12/2002	obsolete	\$1,303.83
23309	Computer: Dell GX260T	9/12/2002	obsolete	\$1,655.41
23310	Computer: Dell GX260T	9/12/2002	obsolete	\$1,655.41
23317	Computer: Dell GX260T	9/23/2002	obsolete	\$880.02
23980	Laptop Computer: Dell Latitude	11/18/2002	obsolete	\$3,780.12
24452	Router: Cisco	8/22/2002	obsolete	\$3,965.15
24453	Router: Cisco	8/22/2002	obsolete	\$4,033.57
24632	Computer: Dell GX260T	2/13/2003	obsolete	\$1,422.00
24861	Computer: Dell GX260T	4/17/2003	obsolete	\$1,493.00
24914	Computer: Dell GX260T	4/21/2003	obsolete	\$1,269.00
24921	Computer: Dell GX260T	4/21/2003	obsolete	\$1,269.00
24982	Computer: Dell GX260T	4/22/2003	obsolete	\$1,554.00
24996	Computer: Dell GX260T	4/22/2003	obsolete	\$1,554.00
25128	Computer: Dell GX260T	5/30/2003	obsolete	\$1,269.00
25354	Computer: Dell GX260T	4/30/2003	obsolete	\$1,540.00
25386	Computer: Dell GX260T	5/9/2003	obsolete	\$933.00

**MINUTES OF THE SPECIAL MEETING OF MARCH 16, 2010**

**BOARD OF TRUSTEES OF ST. PETERSBURG COLLEGE**

25458	Computer: Dell 533	5/1/2003	obsolete	\$5,146.00
25474	Computer: Dell 533	5/1/2003	obsolete	\$5,146.00
25557	Computer: Dell GX260T	4/30/2003	obsolete	\$1,234.00
25561	Computer: Dell GX260T	4/30/2003	obsolete	\$1,234.00
25577	Computer: Dell GX260T	4/30/2003	obsolete	\$1,234.00
25587	Computer: Dell GX260T	4/30/2003	obsolete	\$1,234.00
25625	Computer: Dell GX260T	4/29/2003	obsolete	\$1,234.00
25631	Computer: Dell	4/30/2003	obsolete	\$1,234.00
25772	Computer: Dell GX260T	4/30/2003	obsolete	\$1,234.00
25773	Computer: Dell GX260T	4/30/2003	obsolete	\$1,234.00
25813	Computer: Dell GX260T	4/29/2003	obsolete	\$1,234.00
26397	Computer:Dell GX260S	6/25/2003	obsolete	\$1,369.00
26653	Cpu:Dell GX110*	1/4/2001	obsolete	\$82.36
26994	Computer:Dell GX270T	10/13/2003	obsolete	\$1,313.00
26999	Computer:Dell GX270T	10/13/2003	obsolete	\$1,313.00
27000	Computer:Dell GX270T	10/13/2003	obsolete	\$1,313.00
27222	Computer:Dell GX270T	12/17/2003	obsolete	\$1,327.17
27403	Computer:Dell GX270T	12/2/2003	obsolete	\$1,504.00
27407	Computer:Dell GX270T	12/2/2003	obsolete	\$1,504.00
27411	Computer:Dell GX270T	12/2/2003	obsolete	\$1,504.00
27425	Computer:Dell GX270T	12/2/2003	obsolete	\$1,504.00
27435	Computer:Dell GX270T	12/2/2003	obsolete	\$1,504.00
27442	Computer:Dell GX270T	12/2/2003	obsolete	\$1,504.00
27444	Computer:Dell GX270T	12/2/2003	obsolete	\$1,504.00
27743	Computer:Dell GX270	3/29/2004	obsolete	\$1,621.00
27744	Computer:Dell GX270	3/29/2004	obsolete	\$1,621.00
27746	Computer:Dell GX270	3/29/2004	obsolete	\$1,621.00
27748	Computer:Dell GX270	3/29/2004	obsolete	\$1,621.00
27752	Computer:Dell GX270	3/29/2004	obsolete	\$1,621.00
27754	Computer:Dell GX270	3/29/2004	obsolete	\$1,621.00
27757	Computer:Dell GX270	3/29/2004	obsolete	\$1,621.00
27758	Computer:Dell GX270	3/29/2004	obsolete	\$1,621.00

**MINUTES OF THE SPECIAL MEETING OF MARCH 16, 2010**

**BOARD OF TRUSTEES OF ST. PETERSBURG COLLEGE**

27760	Computer:Dell GX270	3/29/2004	obsolete	\$1,621.00
27765	Computer:Dell GX270	3/29/2004	obsolete	\$1,621.00
27767	Computer:Dell GX270	3/29/2004	obsolete	\$1,621.00
27768	Computer:Dell GX270	3/29/2004	obsolete	\$1,621.00
27770	Computer:Dell GX270	3/29/2004	obsolete	\$1,621.00
28353	Computer:Dell GX150*	7/18/2001	obsolete	\$121.52
28362	Computer:Dell GX150*	7/18/2001	obsolete	\$121.52
28373	Computer:Dell GX150*	7/18/2001	obsolete	\$121.52
32230	Computer:Dell 670	9/14/2005	obsolete	\$3,186.00
32734	Computer:Dell GX260T*	6/28/2002	obsolete	\$0.00
32737	Computer:Dell GX260T*	6/28/2002	obsolete	\$0.00
32738	Computer:Dell GX260T*	6/28/2002	obsolete	\$0.00
32739	Computer:Dell GX260T*	6/28/2002	obsolete	\$0.00
32740	Computer:Dell GX260T*	6/28/2002	obsolete	\$0.00
32744	Computer:Dell GX260T*	6/28/2002	obsolete	\$0.00
32761	Computer:Dell GX260T*	6/28/2002	obsolete	\$0.00
32765	Computer:Dell GX260T*	6/28/2002	obsolete	\$0.00
32769	Computer:Dell GX260T*	6/28/2002	obsolete	\$0.00
32775	Computer:Dell GX260T*	6/28/2002	obsolete	\$0.00
32777	Computer:Dell GX260T*	6/28/2002	obsolete	\$0.00
32778	Computer:Dell GX260T*	6/28/2002	obsolete	\$0.00
			TOTAL	\$303,559.16

\*Note: Asset was a leased computer. Acquisition price was remaining buyout amount.

The following list consists of equipment/furniture or supplies valued at less than \$1,000 individually, which are not accounted for on the property inventory. These items have also been declared surplus.

Miscellaneous Chairs, Tables and Furniture

Miscellaneous Computer & Telephone Parts

Miscellaneous Custodial Equipment

Miscellaneous Scientific, Medical, Exercise, Classroom and Kitchen Equipment

**MINUTES OF THE SPECIAL MEETING OF MARCH 16, 2010**

**BOARD OF TRUSTEES OF ST. PETERSBURG COLLEGE**

Thomas E. Furlong, Jr., President; Susan Reiter, Vice President, Facilities Planning & Institutional Services; Conferlete Carney, Provost, Tarpon Springs Campus; Paul Spinelli, Director of Purchasing; Daya Pendharkar, Associate Vice President of Information Systems; and Doug Duncan, Vice President, Administrative/Business Services & Information Systems, recommend approval.

djh0302102

Board Material Relating to  
Agenda Item IX-D.2  
Meeting: March 16, 2010

**BOARD OF TRUSTEES  
ST. PETERSBURG COLLEGE**

**Review of Partial Phase III Construction Documents (Structural and Building Envelope),  
Project 597-D-10-5, Remodel/Renovate for Classrooms/Labs (College of Education),  
Olympia Building, Tarpon Springs Campus**

On October 20, 2009, the Board of Trustees approved Phase I Schematic Design Documents and an early bid package to allow for the utility relocations, demolition and structural systems. The current Phase III Construction Documents include the final plans for the foundations, structural steel, roofing systems and building envelope.

This project will consist of approximately 39,232 square feet of two-story space at the center section of the Olympia Building Warehouse space (connecting to the existing bookstore and café) and leave the north side of the Olympia Building as approximately 40,000 SF Warehouse space. This will require installing new structural systems and exterior fenestration at the center of the Olympia Building and building out the interior of this space as a consolidated location for the College of Education at the Tarpon Springs Campus. This project includes a new main entry to the Olympia Building (College of Education, Bookstore and Café) from the parking at the east side of the Olympia Building. Additionally, this project will provide a new entry on the west side of the Olympia Building, providing a more direct connection of this new space to the balance of the Campus.

The total Preliminary Guaranteed Maximum Price (GMP) for this project remains at \$9,176,884 or \$233.91 per square foot with a total project budget of \$12,466,797 as approved on October 20, 2009. The date for substantial completion has been set for December 2, 2010. A final GMP will be brought to the Board for review and approval once the Phase III Construction Documents are completed for the entire project (May 2010).

**MINUTES OF THE SPECIAL MEETING OF MARCH 16, 2010**

**BOARD OF TRUSTEES OF ST. PETERSBURG COLLEGE**

These Phase III Construction Documents (Structural and Building Envelope) are presented today for your review and approval. The construction documents have been reviewed by Conferlete Carney, Provost, Tarpon Springs Campus; Sally Naylor, Dean, College of Education; Anne Cooper, Senior Vice President, Academic and Student Affairs; and Kay Burniston, Vice President Baccalaureate Programs and University Partnerships.

**Authorization is requested for the following:**

- **To approve Phase III Construction Documents (Structural and Building Envelope);**
- **To approve proceeding with the construction of the work detailed in the Phase III Construction Documents (Structural and Building Envelope).**

Thomas E Furlong, Jr., President; and Susan M. Reiter, Vice President, Facilities Planning and Institutional Services; recommend approval.

mdc0302103

Board Material Relating to  
Agenda Item IX-D.3  
Meeting: March 16, 2010

**BOARD OF TRUSTEES  
ST. PETERSBURG COLLEGE**

**Amendment to Lease Agreement between St. Petersburg College  
and National University of Health Sciences (NUHS) for a Lease  
of Space at the Health Education Center**

The Board previously approved a lease agreement between St. Petersburg College and the National University of Health Sciences (NUHS) for a portion of the first floor of the Bankers Insurance Group Orthotics and Prosthetics Building (O&P Building) located at the Health Education Center on April 21, 2009.

**Approval is sought to extend this lease agreement for an additional one (1) year term on the same terms and conditions of the original agreement except for the operating fee, which is being increased to match the current State-mandated Standard for Operation of Community College rates.** The operating fee will be increased to \$7.14 per square foot

**MINUTES OF THE SPECIAL MEETING OF MARCH 16, 2010**

**BOARD OF TRUSTEES OF ST. PETERSBURG COLLEGE**

(previously \$7.05) for Exclusive Use space and \$3.57 (previously \$3.52) per square foot for Concurrent Use space. The details of the Total Annual Lease Revenue are noted below:

Base Rent	\$	1.00
Exclusive Use Space (942 sf x \$7.14)	\$	7,625.88
Concurrent Use Space (432 sf x \$3.57)	\$	1,542.24
<b>Total Annual Lease Revenue:</b>	<b>\$</b>	<b>8,269.12</b>

The lease agreement amendment is being provided to the Board as required by Florida Statutes, Chapter 1013.15 Lease, rental, and lease-purchase of educational facilities and sites, Section (1):

Prior to entering into or executing any such lease, a board shall consider approval of the lease or lease-purchase agreement at a public meeting, at which a copy of the proposed agreement in its final form shall be available for inspection and review by the public, after due notice as required by law.

Thomas E. Furlong Jr., President; Susan M. Reiter, Vice President, Facilities Planning and Institutional Services; and Catherine Kennedy, Associate Vice President, University Partnership Center, recommend approval.

mdc0302102

**FIRSTAMENDMENT  
TO LEASE AGREEMENT  
NATIONAL UNIVERSITY OF HEALTH SCIENCES  
AND  
ST. PETERSBURG COLLEGE**

THIS FIRST AMENDMENT is entered into this \_\_\_\_\_ day of \_\_\_\_\_, 2010 by and between the Board of Trustees of St. Petersburg College, a Florida public body corporate, whose mailing address is P.O. Box 13489, St. Petersburg, Florida 33733, (hereinafter, the "College") and the National University of Health Sciences, an Illinois non-profit corporation, whose principal address is 200 E Roosevelt Road, Lombard, IL, 60148 (hereinafter, the "NUHS").

**WITNESSETH:**

**WHEREAS**, THE College and NUHS did enter into that certain Lease Agreement dated April 28th, 2009, whereby the College leased to NUHS a portion of the College's property

**MINUTES OF THE SPECIAL MEETING OF MARCH 16, 2010**

**BOARD OF TRUSTEES OF ST. PETERSBURG COLLEGE**

located at 7200 66<sup>th</sup> St. N, Pinellas Park, FL, 33781, in the O & P Building (the "Agreement"); and

**WHEREAS**, unless otherwise specifically stated in this First Amendment to the contrary, the terms and definitions used herein shall have the same meaning as set forth in the Agreement; and

**WHEREAS**, the Term is set to expire on May 10th, 2010; and

**WHEREAS**, the parties desire to extend the Agreement for an additional one (1) year term on such terms and conditions as are set forth in the Agreement, except as specifically modified herein;

**NOW, THEREFORE**, in consideration of the premises and one dollar and other good and valuable consideration, the receipt and sufficiency of which are hereby acknowledged, the parties further agree as follows:

1. The recitals are true and correct and are incorporated herein by reference.
2. The Term of the Agreement is hereby extended for an additional one (1) year term commencing on May 11th, 2010 and continuing through and until May 10th, 2011.
3. The Operating Fee for the Leased Premises is hereby increased to \$8,269.12. The Operating Fee will be paid in four quarterly installments of \$2,067.28 on May 11th, August 11th, November 11th, and February 11th during the Term. The Operating Fee increase is attributable to an increase in the fee for the Exclusive Use Space to \$7.14 per square foot and an increase in the fee for the Concurrent Use Space to \$3.57 per square foot.

All other terms and conditions of the Agreement shall remain in full force and effect except as specifically modified herein. If any of the provisions of this First Amendment conflict with any terms of the Agreement, the provisions of the First Amendment shall govern and control.

IN WITNESS WHEREOF, the parties have executed this First Amendment as of the dates indicated below.

**COLLEGE:**  
Witnesses as to the College:

Board of Trustees of St. Petersburg College

By: \_\_\_\_\_

**MINUTES OF THE SPECIAL MEETING OF MARCH 16, 2010**

**BOARD OF TRUSTEES OF ST. PETERSBURG COLLEGE**

By: \_\_\_\_\_  
Name: \_\_\_\_\_  
Petersburg  
By: \_\_\_\_\_  
Name: \_\_\_\_\_

Thomas E. Furlong, Jr., President  
and Secretary to the Board of Trustees of St.  
College

**NUHS:**

National University of Health Sciences

Witnesses as to the NUHS:

By: \_\_\_\_\_  
Name: \_\_\_\_\_  
Its: \_\_\_\_\_

By: \_\_\_\_\_  
Name: \_\_\_\_\_

By: \_\_\_\_\_  
Name: \_\_\_\_\_

Board Material Relating to  
Agenda Item IX-D.4  
Meeting: March 16, 2010

**BOARD OF TRUSTEES  
ST. PETERSBURG COLLEGE**

**Agreement between St. Petersburg College and BayCare Health System to  
Lease Space at the District Office**

St. Petersburg College (College) and BayCare Health System (BayCare) have agreed, under the following terms and conditions, to partner together at the District Office, EpiCenter, to provide a space to conduct training and educational seminars for their employees, staff and contractors related to the provision of health care services. The agreement is subject to the approval of each partners' respective Board, if any. The salient terms and conditions are set forth below:

- The College will lease to BayCare a portion of the first floor of the District Office consisting of approximately 4,686 square feet of Exclusive Use space and 2,301 square feet of Concurrent Use space. These spaces will be used by BayCare as classrooms and offices.
- The lease period runs from January 1, 2010 through December 31, 2010. The Agreement may be extended for consecutive one (1) year terms upon mutual agreement of the parties in writing before the end of any Term. BayCare will be retroactively charged for use of the space beginning January 1, 2010.



**MINUTES OF THE SPECIAL MEETING OF MARCH 16, 2010**

**BOARD OF TRUSTEES OF ST. PETERSBURG COLLEGE**

- BayCare shall pay to the College Base Rent for the Leased Premises in the amount of \$10.61 per square foot for Exclusive Use space and \$5.31 for Concurrent Use space; Therefore, the annual rent payments for the first year will be \$61,936.77 (4,686 square feet x \$10.61 + 2,301 square feet x \$5.31). Additionally, BayCare shall pay to the College its pro-rata share of any utility rate assessment, stormwater fee or other surcharge that may be assessed from time to time to the College for the District Office. The College reserves the right to increase Base Rent for any renewal term.
- As part of the Base Rent, the College shall provide utilities, including electrical, heating, ventilation and air conditioning, water, garbage and sewer, custodial services, and maintenance services, including maintenance of HVAC systems, roof, exterior walls and structural systems.

The lease agreement is being provided to the Board as required by Florida Statutes, Chapter 1013.15 Lease, rental, and lease-purchase of educational facilities and sites, Section (1):

Prior to entering into or executing any such lease, a board shall consider approval of the lease or lease-purchase agreement at a public meeting, at which a copy of the proposed agreement in its final form shall be available for inspection and review by the public, after due notice as required by law.

**Authorization is sought to enter into a Lease Agreement with BayCare Health System to lease a space from the College at the District Office.**

Thomas E. Furlong, Jr., President; and Susan M. Reiter, Vice President, Facilities Planning and Institutional Services, recommend approval.

mdc 0308104

**LEASE AGREEMENT  
ST. PETERSBURG COLLEGE AND  
BAYCARE HEALTH SYSTEM, INC.**

**THIS LEASE AGREEMENT** dated \_\_\_\_\_ is entered into by and between the Board of Trustees of St. Petersburg College, whose mailing address is P.O. Box 13489, St. Petersburg, Florida 33733, ("**College**") and BayCare Health System, Inc., a non-profit Florida corporation, whose principal address is 16255 Bay Vista Dr., Clearwater, Florida, 33760 ("**BayCare**").

**WITNESSETH:**

**WHEREAS**, BayCare is a not for profit entity committed to improving the health of all who they serve through community-owned health care services that set the standard for high quality compassionate care; and

## **MINUTES OF THE SPECIAL MEETING OF MARCH 16, 2010**

### **BOARD OF TRUSTEES OF ST. PETERSBURG COLLEGE**

**WHEREAS**, BayCare is in need of facilities to conduct training and educational seminars for their employees, staff and contractors related to the provision of health care services set forth in BayCare's mission statement; and

**WHEREAS**, the College desires to lease to BayCare, and BayCare desires to lease from the College, on such terms and conditions as set forth below, a portion of the College's premises located at the St. Petersburg College District Office, located at 6021 142<sup>nd</sup> Ave., Clearwater, Florida, 32760 ("District Office"), as is more fully described in Paragraph 2 below ("Leased Premises"); and

**NOW THEREFORE**, in consideration of the premises and one dollar and other good and valuable consideration, the receipt and adequacy of which is hereby acknowledged, and the promises and covenants contained herein, the parties hereto agree as follows:

1. **RECITALS.** The recitals set forth above are true and correct and are incorporated herein by reference.
2. **LEASED PREMISES.** The College hereby leases to BayCare and BayCare does hereby lease from the College a portion of the first floor of the District Office, as is more fully set forth on that site plan attached hereto and made a part hereof as Exhibit "A" ("Site Plan"). BayCare shall have exclusive use of Rooms 164a, 164b, 164c, 169, 170, 171, 173, 176 and 177 consisting of approximately 4,686 square feet (All references to Room Numbers in this Lease Agreement are as set forth and designated in the Site Plan). The College, Baycare and other occupants of the District Office and the employees and invitees of the aforementioned parties shall have concurrent access at all times to the restroom space, hallways, and corridors during the Term or any renewal thereof. The concurrent use space consists of approximately 2,301 square feet.
3. **TERM.** The initial term of this Lease shall be for a period of one (1) year commencing on January 1, 2010 and continuing through and until December 31, 2010 ("Term"); thereafter, this Lease Agreement may be renewed for subsequent one (1) year terms upon mutual agreement in writing by the parties hereto before the end of the Term or any renewal term.
4. **BASE RENT.** BayCare shall pay to the College base rent for the Leased Premises in the amount of Sixty One Thousand Nine Hundred Thirty Six and 77/100 Dollars (\$61,936.77) per year ("Base Rent"). Baycare shall pay the first installment of Base Rent in the amount of \$20,645.57 to the College by April 1<sup>st</sup>, 2010; thereafter, Baycare shall pay the remainder of the Base Rent in equal monthly installments of \$5,161.40 which shall be due on the first of each month for the remaining months left in the Term beginning May 1<sup>st</sup>, 2010. Additionally, BayCare shall pay to the College its pro-rata share of any utility rate assessment or surcharge that may be assessed from time to time to the College for the District Office. The College shall provide BayCare with monthly invoices outlining the sums due the College hereunder. Failure by the College to provide an invoice or to accurately reflect any amount due the College pursuant to this Lease Agreement in the invoice shall not act as a waiver or relieve

## **MINUTES OF THE SPECIAL MEETING OF MARCH 16, 2010**

### **BOARD OF TRUSTEES OF ST. PETERSBURG COLLEGE**

BayCare of its obligations to the College with respect to payment to the College of such sums.

5. **MAINTENANCE AND SECURITY:** The College shall provide BayCare for the Leased Premises: (i) utilities, including electrical, heating, ventilation and air conditioning, water, garbage and sewer; (ii) custodial services; (iii) maintenance services, including maintenance and repair of HVAC systems, roof, exterior walls and structural systems; and (iv) security, during the normal hours of operation of the College as defined in paragraph 7, below. In the event that BayCare requires any maintenance or repair services to the Leased Premises, the Director of BayCare's Education Services or his/her designee shall submit a Work Order to the College outlining the work to be performed through procedures set forth by the College and given to BayCare prior to the beginning of the Term.
6. **USE.** The Leased Premises shall be used and occupied by BayCare for educational, instructional and administrative office purposes, consistent with BayCare's normal business operations, and for no other purposes. BayCare shall not compete with the College with respect to offering courses or seminars that are similar to College programs. All use of the Leased Premises shall be in compliance with all laws. For purposes of this Agreement, "Laws" means all applicable present and future (i) federal, state, and local laws, statutes, ordinances, rules regulations, and codes and the federal and state constitutions; (ii) decrees, orders, applicable equitable remedies and decisions by courts in cases where such decisions are binding precedent in the State of Florida; (iii) decisions of federal courts applying the Laws of the State of Florida; and (iv) rules, regulations and orders of quasi official entities or bodies (e.g., boards and bureaus), as the same may be amended or supplemented from time to time.
7. **HOURS OF USE.** The District Office shall be open 7:00am to 10:00pm, Monday-Thursday, and 7:00am – 6:00pm Friday and 7:30am- 6:00pm on Saturday, unless on a case by case basis prior arrangements are made through the Director of Facilities, Planning and Institutional Services for hours of use other than as set forth herein. BayCare and the College shall coordinate with one another with respect to BayCare's access to the Leased Premises and services provided during official College holidays. BayCare shall have access to the Leased Premises at times other than as set forth above through electronic security cards. BayCare shall provide the College with a list of those persons in need of electronic security cards before the beginning of the Term.
8. **PARKING.** BayCare, its employees, agents, and invitees may utilize those parking spaces located at the District Office.
9. **ALTERATIONS TO THE PREMISES.** BayCare will not, without the College's prior written consent, make any material changes or alterations, additions or improvements in or about the Leased Premises. Such consent may be given in writing by the College's Vice President of Facilities, Planning and Institutional Services, and shall be subject to the College's building

## **MINUTES OF THE SPECIAL MEETING OF MARCH 16, 2010**

### **BOARD OF TRUSTEES OF ST. PETERSBURG COLLEGE**

and permitting department in compliance with the Florida Building Code (FBC), Florida Fire Prevention Code (FFPC), and the American's with Disability Act (ADA).

10. NO FURTHER ENCUMBRANCES. BayCare shall not have any right to encumber or mortgage the Leased Premises or otherwise place a lien or judgment upon its leasehold interest or the fee, and shall save the College harmless from any liens, claims judgments and demands, of whatsoever nature, made by any third party, including, but not limited to, any subcontractors, material men and vendors in connection with any work performed upon the Leased Premises by or on behalf of BayCare.
11. TENANT'S DEFAULT. "Default" shall be the occurrence of any one or more of the following events which shall permit the College, subject to the cure periods herein stated, to immediately terminate this Lease and take possession of the Leased Premises.
  - a. BayCare's failure to pay any sums payable to the College which shall be and remain unpaid for more than thirty (30) days after the same are due and payable.
  - b. BayCare's abandonment or vacation of the Leased Premises.
  - c. BayCare's voluntary or involuntary transfer of its leasehold interest hereunder to any other person or other entity, without the prior written approval of the College.
  - d. BayCare's material breach of the performance of any of the other covenants, agreements, stipulations or conditions herein and such breach shall not be cured within a period of thirty (30) days after written notice by the College to BayCare of such breach.
  - e. The filing of any bankruptcy proceedings on behalf of or against BayCare.
  - f. Use of the Leased Premises by BayCare other than as specified in Paragraph 6 or in non-compliance therewith.
  - g. BayCare's encumbrance of the Leased Premises or the fee, or its allowing the Leased Premises or fee to be encumbered, or any other breach of the provisions in paragraph 10, herein.
12. LANDLORD'S DEFAULT. A material breach by the College in its performance of the covenants, agreements, stipulations or conditions herein shall constitute a default under this Lease, unless the College cures such breach within thirty (30) days after written notice by BayCare to the College of such breach.
13. DISPUTE RESOLUTION. To the extent BayCare and the College cannot, after good faith attempts, resolve any controversy or dispute that may have arisen under this Lease Agreement, either party, to the extent its interests are adversely impacted, may refer the matter to non-binding mediation in Pinellas County, Florida. The dispute will be mediated by a mediator chosen jointly by the College and Bay Care within thirty (30) days after notice by one of the parties demanding non-binding mediation. Neither party may unreasonably withhold consent to the selection of a mediator. The College and BayCare will share the cost of mediation equally.

## **MINUTES OF THE SPECIAL MEETING OF MARCH 16, 2010**

### **BOARD OF TRUSTEES OF ST. PETERSBURG COLLEGE**

Any dispute that cannot be resolved between the parties through negotiation or mediation within sixty (60) days after the date of the initial demand for non-binding mediation may then be submitted by either party to a court of competent jurisdiction in Pinellas County, Florida. The use of mediation will not be considered under the doctrine of laches, waiver or estoppel to affect adversely the rights of either party. Either party may resort to submitting the dispute to a court of competent jurisdiction as set forth herein prior to the expiration of the 60 day period set forth above, if: (i) good faith efforts to attempt resolution of the dispute under those procedures have been unsuccessful; or (b) interim relief from the court is necessary to prevent serious and irreparable injury to such party or any of its affiliates, agents, employees, customers, suppliers or contractors.

14. **ASSIGNMENT.** BayCare shall not have the right to assign, sublease or otherwise dispose of this Lease or any part thereof, or of its right, title or interest therein or its power to execute this Lease or any amendment or modification thereto, to any person or entity, without the prior written consent of the College, which consent may be withheld in the sole discretion of the College.
15. **INSURANCE.** BayCare shall maintain liability insurance for personal injury and/or bodily injury including death, of not less than \$1,000,000 per person, \$2,000,000 per occurrence. BayCare shall be required to maintain hazard insurance on its personal property located on or about the Leased Premises. The College shall be named as additional insured on all liability policies and a certificate of insurance shall be provided to the College prior to occupancy by BayCare of the Leased Premises.
16. **TAXES.** BayCare shall be responsible for and shall pay before delinquency all municipal, county, state and federal taxes, if any, assessed during the Term against personal property of any kind owned by or placed in, upon or about the Leased Premises by BayCare. BayCare shall pay all applicable fees and taxes, if any, levied on the Leased Premises or the contents thereof including but not limited to sales taxes, property taxes and stormwater fees, and provide notice to the College of the payment of the same.
17. **LATE CHARGE.** If any payment due to the College is not paid within thirty (30) days after its due date, BayCare shall pay a late charge equal to five percent (5%) of the late amount to compensate the College for the additional administrative expense and loss occasioned thereby. In addition, the College may assess a charge at the maximum rate allowable by law for any check from BayCare returned to the College for insufficient funds. The late charge provided herein may be waived by the College upon a showing of good cause by BayCare for such late payment.
18. **FUNDING FOR COLLEGE.** The College represents that it is a political subdivision existing under the laws of the State of Florida and is funded and relies upon the State for its programs and services. Should legislative appropriations be insufficient, to continue the operation of the District Office, including the Leased Premises, the College may terminate this Lease with one (1) year notice to BayCare, without further liability to BayCare or any third party.

## **MINUTES OF THE SPECIAL MEETING OF MARCH 16, 2010**

### **BOARD OF TRUSTEES OF ST. PETERSBURG COLLEGE**

19. **THIRD PARTY CLAUSE.** This Lease Agreement is for the sole benefit of BayCare and the College and not for any third party. Except as expressly provided in this Lease Agreement, there are no third-party beneficiaries of this Lease Agreement. This Lease Agreement does not create or confer any legal claim or cause of action in favor of any party not a signatory to this Lease Agreement and the obligations and legal duties imposed on any party by this Lease Agreement are owed exclusively to the other party or parties and are not owed to any party not a signatory to this Lease Agreement.
20. **DISCRIMINATION.** Neither the College nor BayCare will discriminate in its employment practices, provision of services to the College's students and the general public or otherwise on the basis of race, color, religion, age, sex, marital status or national origin nor will either discriminate against any qualified person with a disability. The parties agree that sexual harassment constitutes discrimination on the basis of sex.
21. **ENVIRONMENTAL/HAZARDOUS WASTE.** BayCare shall not use, generate, manufacture, produce, store, release, discharge or dispose of, on, under or about the Leased Premises, or transport to or from the Leased Premises, any Hazardous Substances (as defined herein) or allow any other person or entity to do so. BayCare shall keep and maintain the Leased Premises in compliance with, and shall not cause or permit the Leased Premises to be in violation of, any applicable environmental laws. BayCare agrees to protect indemnify and hold harmless the College, its directors, officers, employees, agents, successors and assigns from and against any and all loss, damage, cost, expense or liability (including attorney's fees and costs) directly or indirectly arising out of or attributable to the use, generation, manufacture, production, storage, release, threatened release, discharge, disposal, transport or presence of a Hazardous Substance on, under, about, to or from the Leased Premises, including without limitation all foreseeable consequential damages and the costs of any necessary repair, cleanup or detoxification of the Leased Premises, in any way arising from the acts of BayCare. The College shall have the right to inspect the Leased Premises and audit BayCare's operations thereon at any reasonable time to ascertain BayCare's compliance with the provisions of this Lease Agreement, and BayCare shall provide periodic certifications to the College, upon request, that the College shall have the right but not the obligation, to enter upon the Leased Premises and perform any obligation of BayCare hereunder of which BayCare is in default, including without limitation any remediation necessary due to environmental impact of BayCare's operations on the Leased Premises, without waiving or reducing BayCare's liability for their default hereunder. All terms and provisions of this paragraph shall survive expiration or termination of the Lease for any reason whatsoever. "Hazardous Substance" means any substance, whether solid, liquid or gaseous which is listed, defined or regulated as a "hazardous substance," "hazardous waste" or "solid waste," or pesticide, or otherwise classified as hazardous or toxic, in or pursuant to any environmental requirement; or which is or contains asbestos, radon, any polychlorinated biphenyl, urea formaldehyde foam insulation, explosive or radioactive material, or motor fuel or other petroleum hydrocarbons; or which causes or poses a threat to cause a contamination

## **MINUTES OF THE SPECIAL MEETING OF MARCH 16, 2010**

### **BOARD OF TRUSTEES OF ST. PETERSBURG COLLEGE**

or nuisance on the Leased Premises or any adjacent property or a hazard to the environment or to the health or safety of persons on the Leased Premises.

22. **RADON GAS DISCLOSURE:** Radon is a naturally occurring radioactive gas that, when it has accumulated in a building in sufficient quantities, may present health risks to persons who are exposed to it over time. Levels of Radon that exceed federal and state guidelines have been found in buildings in Florida. Additional information regarding Radon and Radon testing may be obtained from your county public health unit.
23. **INSPECTION AND ACCESS TO PREMISES.** The College shall have the right to enter the premises at all times upon reasonable notice to BayCare (except in the case of an emergency, in which case no prior notice need be given), to examine the Leased Premises, to survey the Leased Premises and make such repairs, alterations, improvements, or additions as the College may deem necessary or desirable at the College's expense, except for expenses incurred for such examination, surveying, repairs, alterations improvements or additions due to the actions of BayCare, its officers, directors, agents, employees, contractors, invitees or licensees for which BayCare shall reimburse the College for expenses incurred in such an event.
24. **INDEMNITY.** BayCare covenants and agrees to indemnify, defend and hold harmless the Board of Trustees of St. Petersburg College and its students, faculty, employees, staff and invitees from and against any and all loss, claims, liabilities, fines, injury and/or damages to persons or property (including personal and real property of the College), penalties, suits, attorney's fees, including but not limited to fees incurred for service in trial and appellate courts, and expenses by reason of or arising out of any damage or injury to personal property, real property, or to persons (including death) caused by or resulting from BayCare's operation, use or occupancy of the Leased Premises.
25. **CONDEMNATION.** In the event of condemnation, this Lease Agreement shall terminate as of the date the condemning authority takes title or possession, whichever first occurs. Any award or payment made in connection with a condemnation shall be the property of the College, whether such award shall be made in settlement of contemplated condemnation proceedings or as compensation for diminution in value of the leasehold or for the taking of the fee, or as severance or other damages; provided, however, BayCare shall be entitled to any separate award made to BayCare which does not diminish the College's award, such as for loss of or damage to BayCare's trade fixtures and removable personal property and any business damages or moving expenses. In the event that this Lease is not terminated by reason of such condemnation, the College shall, to the extent of severance damages received by College in connection with such condemnation, repair any damage to the Leased Premises (except for trade fixtures and personal property of BayCare) caused by such condemnation, except to the extent that BayCare has been reimbursed therefore by the condemning authority.

**MINUTES OF THE SPECIAL MEETING OF MARCH 16, 2010**

**BOARD OF TRUSTEES OF ST. PETERSBURG COLLEGE**

26. CASUALTY.

(a) If the Leased Premises or any portion thereof is destroyed or substantially damaged by fire or other casualty, the College shall proceed with reasonable diligence to repair and restore the Leased Premises (exclusive of BayCare's trade fixtures, signs, contents and personal property) to substantially the same condition as the Leased Premises was in immediately before the happening of the casualty. However, the College shall not be required to restore any portion of the District Office which is not leased to BayCare.

(b) Anything contained in paragraph (a) above to the contrary notwithstanding, the College may terminate this Lease Agreement and shall have no obligation to BayCare to restore the Leased Premises in the event that the Leased Premises or any portion thereof is destroyed or substantially damaged by fire or other casualty, if: (i) the fire or other casualty is caused by the acts, omissions or negligence of BayCare, its officers, directors, employees, agents, contractors, or invitees; (ii) the Leased Premises is damaged in whole or in part as a result of a risk that is not covered by the College's insurance policies; or (iii) the insurance proceeds are inadequate to restore the Leased Premises to substantially the same condition as the Leased Premises was in immediately before the happening of the casualty.

27. PUBLIC RECORDS/STUDENT RECORDS. The provisions of Chapter 119, Florida Statutes; Family Educational Rights and Privacy Act (FERPA); and Section 1002.22, Florida Statutes shall apply to this Lease Agreement.

28. NOTICES. All notices given to BayCare hereunder shall be forwarded to BayCare at the following address, until the College is notified otherwise:

BayCare Health System, Inc.  
Attn: Stephen Mason  
16255 Bay Vista Drive  
Clearwater, Florida 33760

All notices given to the College hereunder shall be forwarded to the College by registered or certified mail, return receipt requested at the following address, until BayCare is notified otherwise:

St. Petersburg, College  
Attn: Vice President of Facilities, Planning & Institutional Services  
P. O. Box 13489  
St. Petersburg, FL 33733

29. CONSTRUCTION OF LEASE. This contract shall be governed by the laws of the State of Florida. Any changes in the applicable laws, which govern this Lease, will necessitate a



**MINUTES OF THE SPECIAL MEETING OF MARCH 16, 2010**

**BOARD OF TRUSTEES OF ST. PETERSBURG COLLEGE**

change in Lease terms and conditions, which may be effected thereby, at the time such changes may arise.

30. **LOSS; DAMAGE; INJURY; DEFECTS.** BayCare shall store its property in and shall occupy the Leased Premises at its own risk. The College shall not be responsible or liable at any time for damage to BayCare's merchandise, equipment, fixtures or other personal property of BayCare or BayCare's business regardless of the cause, unless such damage is due to the College's negligence or wrongful act. The College shall not be responsible or liable to BayCare for damage to either person or property that may be occasioned by or through the acts or omissions of third parties. Unless due to the College's negligence, wrongful act, or failure to comply with this Lease Agreement, the College shall not be liable for any defect in the District Office, or parking area or any of the equipment, machinery, utilities, appliances or apparatus therein, nor shall it be responsible or liable for any damage to any person or to any property of BayCare or other person caused by the running, backing up, seepage, or overflow of water or sewage in any part of the Leased Premises, the failure of any public utility in supplying utilities to the Leased Premises or for any damage caused by or resulting from any defect or negligence in the occupancy, construction, operation, use of any of the Leased Premises, District Office, equipment, machinery, utilities, appliances or apparatus by any other person or by or from the acts of negligence of any occupant of the Leased Premises or the District Office.
31. **SEVERABILITY.** If any clause or provision herein shall be adjudged invalid or unenforceable by a court of competent jurisdiction or by operation of any applicable law, it shall not affect the validity of any other clause or provision, which shall remain in full force and effect.
32. **WAIVER.** The failure of either party to enforce any of the provisions of this Lease shall not be considered a waiver of that provision or the right of the party to thereafter enforce the provision.
33. **COMPLETE AGREEMENT.** This Lease constitutes the entire understanding of the parties with respect to the subject matter hereof and may not be modified except by an instrument in writing and signed by the parties.
34. **COUNTERPARTS.** This Lease may be executed in any number of counterparts, each of which shall be effective only on delivery and thereafter shall be deemed an original, and all of which shall be taken to be one and the same instrument, for the same effect as if all parties hereto had signed the same signature page. Any signature page of this Lease may be detached from any counterpart of this Lease without impairing the legal effect of any signatures thereon and may be attached to another counterpart of this Lease identical in form hereto but having attached to it one or more additional signature pages.
35. **INSTALLATION OF TELECOMMUNICATIONS EQUIPMENT.** The College shall dedicate space in Room 162B, the Intermediate Distribution Facility, (the "IDF Room") for

**MINUTES OF THE SPECIAL MEETING OF MARCH 16, 2010**

**BOARD OF TRUSTEES OF ST. PETERSBURG COLLEGE**

BayCare to install the equipment necessary to provide wireless internet and intranet services. BrightHouse Networks shall connect the hard wiring to the equipment located in the IDF Room. The wiring shall initially be brought into the District Office facility by BrightHouse Networks through the College's Main Distribution Facility, and thereafter connected to BayCare's equipment in the IDF Room. The College shall be responsible for installation of the wiring from the IDF Room to each individual classroom comprising the Leased Premises necessary to bring wireless capabilities to those classrooms. BayCare shall be solely responsible for obtaining and installing antennas in each classroom which will transmit the wireless signals. In the event that there is problem with the wireless connection during the Term or any renewal thereof, BayCare shall be responsible for placing a Work Order to the College in accordance with Paragraph 5 Maintenance and Security to evaluate the problem. If the College is unable to determine the source of the problem or if the problem involves something other than the wiring installed by the College from the IDF Room to the classrooms, then BayCare shall be solely responsible for any and all costs and repairs, including the hiring of contractors approved by the College, to remedy the connection problems. BayCare shall indemnify and hold the College harmless from any and all losses or damages incurred by BayCare, its officers, employees, agents and invitees resulting from any failures or inability to connect to the wireless services, whether or not such failure in connection was caused by the College.

The College will provide BayCare with telephone equipment and service for each classroom and in the office spaces. Only Rooms 164b and 164c shall have long distance capabilities. The remaining Rooms where telephone service is provided as set forth herein shall have local and 911 dialing capabilities only. BayCare shall be charged a flat fee of \$50 per month for the phone services provided by the College to BayCare as set forth herein.

**IN WITNESS WHEREUNTO** the parties set their hands and seals on the dates set forth below.

**Board of Trustees  
St. Petersburg College**

Witnesses:

\_\_\_\_\_

\_\_\_\_\_

By: \_\_\_\_\_  
Thomas E. Furlong, Jr., President  
and Secretary to the Board of  
Trustees of St. Petersburg College

**BayCare Health System, Inc.**

Witnesses:

By: \_\_\_\_\_  
Name: \_\_\_\_\_  
Its: \_\_\_\_\_

**MINUTES OF THE SPECIAL MEETING OF MARCH 16, 2010**

**BOARD OF TRUSTEES OF ST. PETERSBURG COLLEGE**

\_\_\_\_\_

\_\_\_\_\_

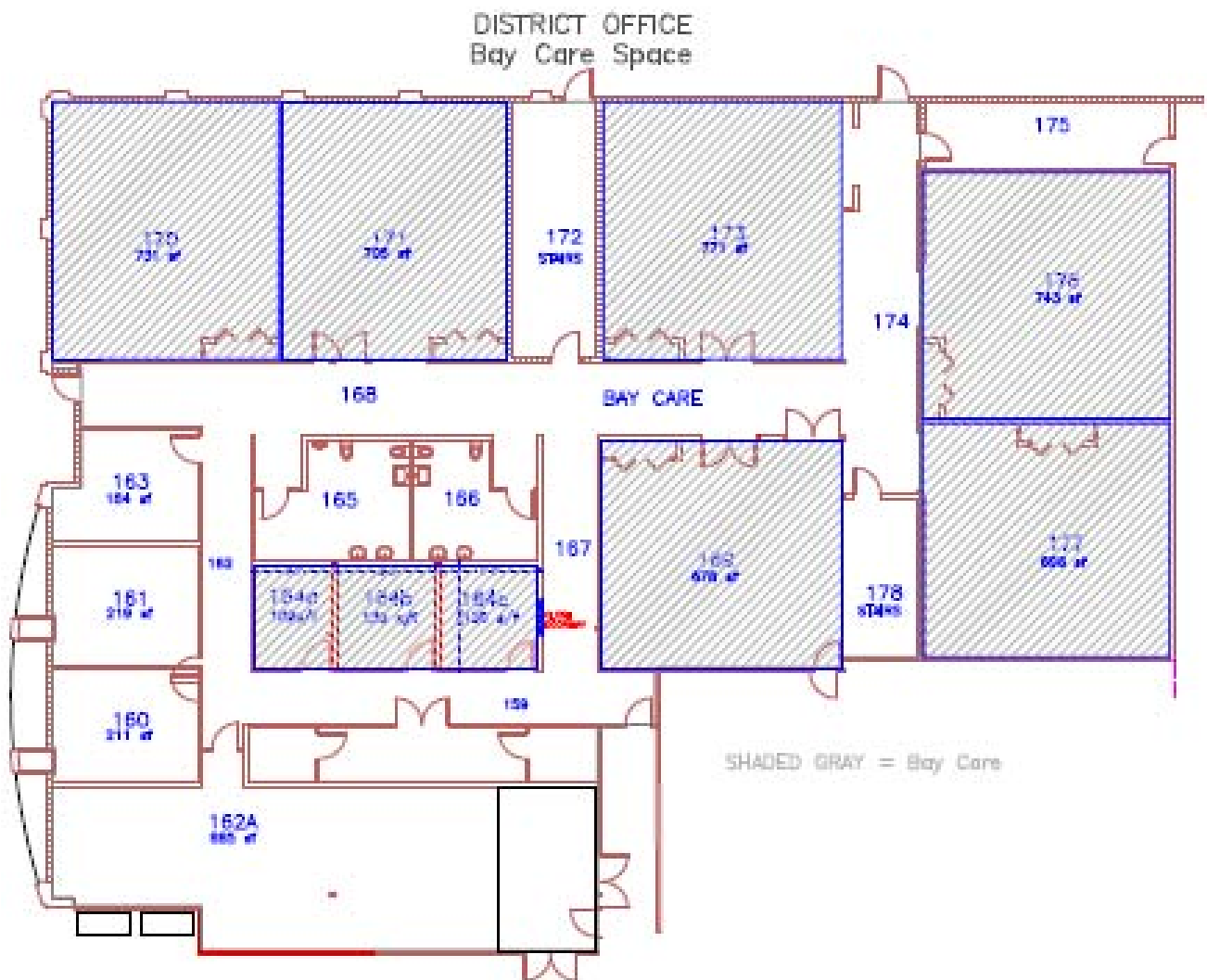

**MINUTES OF THE SPECIAL MEETING OF MARCH 16, 2010**

**BOARD OF TRUSTEES OF ST. PETERSBURG COLLEGE**

Board Material Relating to  
Agenda Item IX-D.5  
Meeting: March 16, 2010

**BOARD OF TRUSTEES  
ST. PETERSBURG COLLEGE**

**Amendment #3 to the Educational Plant Survey dated June 19, 2007, (Spot Survey #3)  
(Veterinary Technology Special Purpose Center, Site 18)**

Amendment #1 to the Educational Plant Survey dated June 19, 2007 (Spot Survey #1), was approved by the Board on March 18, 2008 (see attached). This Amendment established a new site as the Veterinary Technology Center, Site Number 18, at the School Board of Pinellas County Seminole Vocational Education Center.

It has now been determined that the Veterinary Technology Center will be located at a new site on Ulmerton Road. This Amendment changes the site location from the School Board of Pinellas County Seminole Vocational Educational Center to a new property on Ulmerton Road adjacent to the Pinellas County Animal Services Buildings. Further, this property is being purchased by the St. Petersburg College Foundation (partially funded by a private donation), and the College will enter into a 40-year lease agreement with the Foundation for the property.

This Amendment provides the ability for the College to request site acquisition funds to allow St. Petersburg College to purchase the Veterinary Technology Center Site from the St. Petersburg College Foundation once PECO funds become available. The amount requested for this purchase will be the difference between the purchase price of the property and the private donation, approximately \$175,000.

This amendment adds the following item to the Educational Plant Survey:

**Site 18: Veterinary Technology Special Purpose Center**

Site acquisition

18.05 Acquire vacant land on 12746 Ulmerton Road, Largo, FL 33774, PIN number 09/30/15/00000/230/0100; approximately 12.50 acres; in accordance with Section 1013.40(2)(3), Florida Statutes, and Section 1.4, State Requirements for Educational Facilities, 2008.

The Board of Trustees is required to amend the existing Educational Plant Survey utilizing the Spot Survey process. The attached Spot Survey is an official request for the State to accept the modifications to the Educational Plant Survey. Once this is approved by the Board of Trustees, the Department of Education is responsible for filing and updating the Educational Plant Survey as part of the official State record and future reference.

**MINUTES OF THE SPECIAL MEETING OF MARCH 16, 2010**

**BOARD OF TRUSTEES OF ST. PETERSBURG COLLEGE**

**Approval is sought for Amendment #3 (Spot Survey #3) to the Educational Plant Survey dated June 19, 2007.**

Thomas E. Furlong, Jr., President; and Susan M. Reiter, Vice President, Facilities Planning and Institutional Services, recommend approval.

Attachment  
mdc0309103

**AMENDMENT #3 (Spot Survey #3)**  
EDUCATIONAL PLANT SURVEY dated June 19, 2007  
St. Petersburg College  
March 16, 2010

Pursuant to Section 1013.31, Florida Statutes, administrative staff of St. Petersburg College has conducted an amendment to the current Educational Plant Survey for St. Petersburg College, dated June 19, 2007. In accordance with Section 1013.31, Florida Statutes, the amendment shall be reviewed and approved by the Board of Trustees.

The following new recommendation is made.

The College needs to amend the Educational Plant Survey dated June 19, 2007 to include the following item:

**Site 18: Veterinary Technology Special Purpose Center**

Site acquisition

18.05 Acquire vacant land on 12746 Ulmerton Road, Largo, FL 33774, PIN number 09/30/15/00000/230/0100; approximately 12.50 acres; in accordance with Section 1013.40(2)(3), Florida Statutes, and Section 1.4, State Requirements for Educational Facilities, 2008.

Approved by the Board of Trustees of St. Petersburg College on March 16, 2010.

---

Thomas E. Furlong, Jr., President of the College  
and Secretary to the Board of Trustees  
St. Petersburg College

**MINUTES OF THE SPECIAL MEETING OF MARCH 16, 2010**

**BOARD OF TRUSTEES OF ST. PETERSBURG COLLEGE**

Board Material Relating to  
Agenda Item IX-D.6  
Meeting: March 16, 2010

**BOARD OF TRUSTEES  
ST. PETERSBURG COLLEGE**

**Revised CIP-2 Summary Form and CIP-3 Project Explanation Forms from the  
Capital Improvement Program for FY2010-2011 through 2014-2015**

At this time, it is our understanding that funding may become available as part of the Fiscal Year 2010-2011 PECO appropriations for site acquisition of the Veterinary Technology Special Purpose Center property from the St Petersburg College Foundation. In order to take advantage of this funding opportunity, St. Petersburg College needs to modify the Capital Improvement Plan CIP-2 and CIP-3 to add this site acquisition and funding request. If appropriated, these funds would not be available until after next fiscal year.

The CIP-2 and CIP-3 forms have been updated to reflect the following project:

**Site 18: Veterinary Technology Special Purpose Center**

Site acquisition

18.06 Acquire vacant land on 12746 Ulmerton Road, Largo, FL 33774, PIN number 09/30/15/00000/230/0100; approximately 12.50 acres; in accordance with Section 1013.40(2)(3), Florida Statutes, and Section 1.4, State Requirements for Educational Facilities, 2008.

**Approval is sought for the revised CIP-2 Summary Form and CIP-3 Project Explanation Forms from the Capital Improvement Program for FY2010-2011 through 2014-2015 and to submit it to the Division of Community Colleges.**

Thomas E. Furlong, Jr., President; and Susan Reiter, Vice President, Facilities Planning and Institutional Services, recommend approval.

Attachments

bs0301101

**MINUTES OF THE SPECIAL MEETING OF MARCH 16, 2010**

**BOARD OF TRUSTEES OF ST. PETERSBURG COLLEGE**

**FINAL  
DIVISION OF COMMUNITY COLLEGES  
CIP - 2 SUMMARY  
Capital Improvement Plan and Legislative Budget Request  
2010-2011 TO 2014-2015  
Approved by District Board of Trustees on July 21, 2009  
Revised 2/26/10**

**COLLEGE: ST. PETERSBURG COLLEGE**

**RENOVATION PROJECTS:**

PRI	#	PROJECT DESCRIPTION	2010-11	2011-12	2012-13	2013-14	2014-15	FOR CIP 5YR TERM
	1	General Ren/Rem, Roofs, HVAC, ADA, Utilities, Site Improvements - Collegewide	\$6,726,531	\$2,000,000	\$1,000,000			\$9,726,531
	2	Major Ren/Rem, Emer. Replacement of Chiller Water Loop, Infrastructure-CL (partial)	2,771,111					2,771,111
	3	Ren/Rem New Roof/HVAC/Structural/Site - Annex 2 - EP	2,000,000					2,000,000
	4	Ren/Rem Classrooms and Related Space - Annex 3 - EP	2,500,000					2,500,000
	5	Ren/Rem Facility 51 - Technology Learning Center - SE	480,000					480,000
	6	Ren/Rem Student Activity, Administration, Maint., Site Imp. - CL	5,957,294	1,957,294				7,914,588
	7	Ren/Rem/Add Library Building, Site Imp. - CL		1,271,142	5,720,140	5,720,140		12,711,422
	8	Ren/Rem Administration - 1st & 2nd Floor, Site Imp. - SP/G	2,146,468					2,146,468
	9	Ren/Rem Gym, PE Bldgs., Site Imp-SP/G			4,530,331	4,530,331		9,060,662
<b>TOTAL RENOVATION PROJECTS</b>			<b>\$22,581,404</b>	<b>\$5,228,436</b>	<b>\$11,250,471</b>	<b>\$10,250,471</b>	<b>\$0</b>	<b>\$49,310,782</b>

**REMODELING PROJECTS:**

PRI	#	PROJECT DESCRIPTION	2010-11	2011-12	2012-13	2013-14	2014-15	FOR CIP 5YR TERM
	1	Rem/Rem Classrms/Labs/Inst. Sup./Site Dev. Phase II (w/ addition) - Downtown (partial)	\$3,879,392					\$3,879,392
	2	Rem/RemBusiness Technology - Clearwater	3,522,370	996,114				4,518,485
	3	Rem/Rem 2nd Floor Library - SE (partial)	3,878,100					3,878,100
<b>TOTAL REMODELING PROJECTS</b>			<b>\$11,279,862</b>	<b>\$996,114</b>	<b>\$0</b>	<b>\$0</b>	<b>\$0</b>	<b>\$12,275,976</b>

**NEW CONSTRUCTION PROJECTS:**

PRI	#	PROJECT DESCRIPTION	2010-11	2011-12	2012-13	2013-14	2014-15	FOR CIP 5YR TERM
	1	Construct Social Science Building - Clearwater Campus	\$8,200,000					\$8,200,000
	2	Adjacent Land and Facilities Acquisition - Collegewide (partial) spc	6,372,279					6,372,279
	3	Construct Student and Support Services - CL	7,756,943	1,305,192				9,062,135
	4	Construct Marine Science Lab/Classrooms and Site Improvements, Utilities - Bay Pines		2,144,010				2,144,010
	5	Construct Additional Parking 80 Spaces (once Vet Tech is Demolished) - HEC	350,000					350,000
<b>TOTAL NEW CONSTRUCTION PROJECTS</b>			<b>\$22,679,222</b>	<b>\$3,449,202</b>	<b>\$0</b>	<b>\$0</b>	<b>\$0</b>	<b>\$26,128,424</b>
<b>GRAND TOTAL OF ALL PROJECTS</b>			<b>\$56,540,488</b>	<b>\$9,673,752</b>	<b>\$11,250,471</b>	<b>\$10,250,471</b>	<b>\$0</b>	<b>\$87,715,182</b>

7/21/09

1a

**FLORIDA COLLEGE SYSTEM  
CIP-3 PROJECT EXPLANATION  
2010 - 11 Through 2014 - 15**

<b>College Name</b>	St. Petersburg College		
<b>Project Title</b>	Adjacent Land and Facilities Acquisition - Collegewide (partial) spc		
<b>Budget Entity Priority</b>	1		
<b>Statutory Authority</b>	Sec. 1013.64(4)(a)		
<b>Type of Project (*)</b>	Construct	Remodel	Acquisition X

**GEOGRAPHIC LOCATION** County wide **COUNTY:** Pinellas  
Site street address, City

**PROJECT NARRATIVE: (PURPOSE, NEED, SCOPE, PROGRAMS, FACILITIES AND EDUCATIONAL PLANT SURVEY RECOMMENDATIONS)**

**MINUTES OF THE SPECIAL MEETING OF MARCH 16, 2010**

**BOARD OF TRUSTEES OF ST. PETERSBURG COLLEGE**

This project purchases property per the following survey recommendations:

1.01 Acquire the property at 14155 58th Street North (Annex 2, formerly known as "Applied Fiber"), Largo, Florida, approximately 4.47 acres, adjacent to the existing center, in accordance with Section 1013.14, Florida Statutes, and Section 1.4, State Requirements for Educational Facilities, 1999.

1.02 Acquire the property at 6021 142nd Avenue North (District Office, formerly know as Annex 3 and "Homeland Security"), Largo, Florida, approximately 7.44 acres, including a two-story, masonry structure, approximately 79,100 square feet in size, in accordance with Section 1013.14, Florida Statutes, and Section 1.4, State Requirements for Educational Facilities, 1999.

15.01 Acquire approximately 10,000 square feet of existing retail property located adjacent to the west of the Downtown Center, and facing Williams Park.

8.01 Acquire adjacent parcel of land at 6710 Park Blvd., Pinellas Park, Florida, approximately 165 feet by 606 feet; in accordance with Section 1013.40(2)(3), Florida Statutes, and Section 1.4, State Requirements for Educational Facilities, 1999.

8.02 Acquire adjacent parcel of land at 7108 66th St. N, Pinellas Park, Florida; approximately 88 feet by 158feet; in accordance with Section 1013.40(2)(3), Florida Statues, and Section 1.4, State Requirements for Educational Facilities, 1999.

8.03 Acquire vacant land on 66th Street, Pinellas Park, Florida; PIN number 29/30/16/71082/091/01/0120; approximately 88 feet by 158 feet; in accordance with Section 1013.40(2)(3), Florida Statutes, and Section 1.4, State Requirements for Educational Facilities, 1999.

18.05 Acquire vacant land on 12746 Ulmerton Road, Largo, FL 33774, PIN number 09/30/15/00000/230/0100; approximately 12.50 acres; in accordance with Section 1013.40(2)(3), Florida Statutes, and Section 1.4, State Requirements for Educational Facilities, 2008.

This project purchases properties adjacent to existing sites.

**Projected Bid Date/Start of Construction (Month, Year):**

**Projected Occupancy Date (Month, Year):**

Funding Educational Specifications Section (must be completed for all first-year priority construction)				
Date of Survey	Recomm Number	Recomm Total NSF	NSF Used	Student Stations Used
June 17, 2007				

**CIP-3 CALCULATION WORKSHEET**

**St. Petersburg College**

**Adjacent Land and Facilities Acquisition - Collegewide (partial) spc**

NEW CONSTRUCTION					
CATEGORY	NSF	GSF	\$/GSF	LOCAL FACTOR	Const. Cost
Classroom		0	205.68		\$0
Teaching Lab		0	194.40		\$0
Physical Ed.		0	200.25		\$0
Vocational Lab		0	194.40		\$0
Library		0	182.49		\$0
Audio-Visual		0	166.74		\$0
Audit.-Exhibit		0	223.60		\$0
Student Services		0	204.17		\$0
Support Services		0	186.22		\$0
Offices		0	205.97		\$0
<b>TOTAL</b>	<b>0</b>	<b>0</b>			<b>\$0</b>
<b>New Construction Cost</b>					<b>\$0</b>
REMODELING/RENOVATION					
	NSF	GSF	\$/GSF		Const. Cost
					\$0
<b>Remodeling/Renovation Cost</b>					<b>\$0</b>



**MINUTES OF THE SPECIAL MEETING OF MARCH 16, 2010**

**BOARD OF TRUSTEES OF ST. PETERSBURG COLLEGE**

Base Construction - New & Rem/Rem \$0  
 Site development/improvement\*\* (2.6%) \$0  
 Total Base Construction Costs \$0

\*\*Note: If 2.6% is used for basic site dev/imp, do not request additional extraordinary construction costs for sitework below.

SCHEDULE OF PROJECT COMPONENTS	ESTIMATED EXPENDITURES				
	FY 10-11	FY 11-12	FY 12-13	FY 13-14	FY 14-15
<b>1. CONSTRUCTION COSTS</b>					
a. Base Construction Cost (from above)					
<b>Add'l Extraordinary Construction Costs</b>					
b. Environmental Impacts/Mitigation					
c. Site preparation					
d. Landscape/Irrigation					
e. Plaza/Walks					
f. Roadway improvements					
g. Parking spaces:					
h. Telecommunication					
i. Electrical service					
j. Water distribution					
k. Sanitary sewer system					
l. Chilled water system					
m. Storm water system					
n. Energy efficient equipment					
o. Other:					
<b>Subtotal: CONSTRUCTION COSTS</b>	\$0	\$0	\$0	\$0	\$0
<b>2. OTHER PROJECT COSTS</b>					
a. Land/existing facility acquisition*	\$6,372,279				
b. Professional Fees					
1) Planning/programming (1%)					
2) A/E fees (7.8%)					
3) Inspection Services*					
4) On-site representation (1.2%)					
5) Other prof. services* (sugg. 0.5%)					
c. Testing/surveys (2.2%)					
d. Permit/Environmental Fees*					
e. Miscellaneous cost* (sugg. 1-3%)					
f. Movable equipment/furnishings (10.2%)					
<b>Subtotal: OTHER PROJECT COSTS</b>	\$6,372,279	\$0	\$0	\$0	\$0
<b>TOTAL: COSTS BY YEAR (1+2)</b>	\$6,372,279	\$0	\$0	\$0	\$0

\*As needed

	<u>Year</u>	<u>Amount</u>	<u>Projected Costs beyond CIP</u>
<b>Appropriations to Date:</b>	2004-05	\$1,300,000	
	2005-06	\$1,804,594	
	2006-07	\$2,603,727	
	2007-08	\$1,500,000	
	2008-09	\$250,000	
<b>Subtotal Approp to date:</b>		<u>\$7,458,321</u>	<b>TOTAL:</b> _____

TOTAL PROJECT COSTS

**\$13,830,600**

Board Material Relating to  
 Agenda Item IX-D.7  
 Meeting: March 16, 2010

**BOARD OF TRUSTEES  
 ST. PETERSBURG COLLEGE**

**Revised Amendment #2 to the Educational Plant Survey Dated June 19, 2007  
 (Spot Survey #2) (Social Science Building, Clearwater Campus)**

**MINUTES OF THE SPECIAL MEETING OF MARCH 16, 2010**

**BOARD OF TRUSTEES OF ST. PETERSBURG COLLEGE**

The Master Plan and revised CIP-2 and CIP-3 (Agenda Item IX-D.3 from February 23, 2010 packet) for the Clearwater Campus includes a new building to replace the recently demolished Social Science Building #35. In order to construct this building, the College is required to amend the Educational Plant Survey dated June 19, 2007. This amendment adds the following items to the Educational Plant Survey:

**Site 2: Clearwater Campus**

- 2.44 Construct classroom facilities and service areas; use codes 110, 115, 120, and 125; 1,000 student stations; approximately 26,875 NSF (Net Square Feet); 38,431 GSF (Gross Square Feet);
- 2.45 Construct office facilities and service areas; use codes 310, 315, 350 and 355; 1,600 NSF; 2,288 GSF.

The Board of Trustees is required to amend the existing Educational Plant Survey utilizing the Spot Survey process. The attached revised Spot Survey is an official request for the State to accept the modifications to the Educational Plant Survey. Once this is approved by the Board of Trustees, the Department of Education is responsible for filing and updating the Educational Plant Survey as part of the official State record and future reference.

**Approval is sought for Revised Amendment #2 to the Educational Plant Survey dated June 19, 2007 (Spot Survey #2).**

Thomas E. Furlong, Jr., President; and Susan M. Reiter, Vice President, Facilities Planning and Institutional Services, recommend approval.

Attachment

mdc0310103

**REVISED**  
**AMENDMENT #2 (SPOT SURVEY #2)**  
EDUCATIONAL PLANT SURVEY dated June 19, 2007  
St. Petersburg College  
March 16, 2010

Pursuant to Section 1013.31, Florida Statutes, administrative staff of St. Petersburg College has conducted an amendment to the current Educational Plant Survey for St. Petersburg College,

**MINUTES OF THE SPECIAL MEETING OF MARCH 16, 2010**

**BOARD OF TRUSTEES OF ST. PETERSBURG COLLEGE**

dated June 19, 2007. In accordance with Section 1013.31, Florida Statutes, the amendment shall be reviewed and approved by the Board of Trustees.

The following new recommendation is made.

The College needs to amend the Educational Plant Survey dated June 19, 2007 to include the following items:

**Site 2: Clearwater Campus**

- 2.44 Construct classroom facilities and service areas; use codes 110, 115, 120, and 125; 1,000 student stations; approximately 26,875 NSF; 38,431GSF;
- 2.45 Construct office facilities and service areas; use codes 310, 315, 350 and 355; 1,600 NSF; 2,288 GSF.

Approved by the Board of Trustees of St. Petersburg College on March 16, 2010.

---

Thomas E. Furlong, Jr., President of the College  
and Secretary to the Board of Trustees  
St. Petersburg College

**10-074.** The president sought approval of Personnel Items IX-F.1-F.3. Mrs. Bilirakis moved approval. Mr. Johnston seconded the motion. Mr. Gibbons voted aye; Mr. Johnston voted aye; Mr. Brett voted aye; Mr. Burke voted aye; and Mrs. Bilirakis voted aye. Motion carried.

Information regarding these items is as follows:

Board Materials Relating to  
Agenda Item IX-F.1  
Meeting: March 16, 2010

**BOARD OF TRUSTEES  
ST. PETERSBURG COLLEGE**

**Personnel Report**

**Approval is sought for the following recommended personnel transactions:**

## MINUTES OF THE SPECIAL MEETING OF MARCH 16, 2010

### BOARD OF TRUSTEES OF ST. PETERSBURG COLLEGE

The report is organized by transaction type (hire, transfer, retire, etc.), name, department/location, and employee title. The "separation" transaction is further defined in the employee's record in the PeopleSoft HR Payroll system. Reasons for separation vary and could include such descriptions as: End of Contract; Resignation; Probationary Period; Death, etc.

<b>HIRE Budgeted</b>			
<b>Effect. Date</b>	<b>Name</b>	<b>Department/Location</b>	<b>Title</b>
3/1/2010	Bui,Anh Van	Custodial Services SPG	Custodian I
2/5/2010	Cayanan,Philip P	Human Resources	Administrative Generalist
3/1/2010	Childs-Brown,Deborah L	District Library DO	Library Assistant
2/15/2010	Graham,Gary W.	Education & Student Svcs DO	Coordinator I, Project
3/1/2010	Hughes,Michael E.	Criminal Justice AC	Instructor-12 month
3/1/2010	Korb,Tracy L	Counseling & Advisement SPG	Generalist, MAP
2/22/2010	McBride,Todd R.	Business Technologies CL	Technology Resource Specialist
3/1/2010	Popp Jr,John T	Custodial Services SE	Custodian I
2/22/2010	Przyborowski,Marta F	Scholarships/Stu Fin Assist DO	Administrative Specialist II
2/22/2010	Robinson,Diane J	Nursing HC	Nursing Skills Facilitator
2/8/2010	Waulk,Caridad Perez	Education & Student Svcs DO	Administrative Specialist I
<b>HIRE Temporary/Supplemental</b>			
<b>Effect. Date</b>	<b>Name</b>	<b>Department/Location</b>	<b>Title</b>
2/15/2010	Cigoi,Josef E	Provost SPG	OPS Career Level 6
2/5/2010	Cornett,Susan L	Letters TS	Non Instr Supplement-Not ECH
2/17/2010	Dinsdale,Patrick	Admin Info Systems - SE	OPS Technical Level 1
2/22/2010	Goswick,Kelly R	Florida Natl. Guard Grant - AC	Instructor- Temporary Non-Cred
2/19/2010	Grinnell,Lynn Dean	BA Programs/UPC	Non Instr Supplement-Not ECH
2/10/2010	Hatcherian,Rachel Lynn	Fine & Applied Arts SPG	Federal Work Study Student
2/15/2010	Kelley,Amy June	Letters SPG	Student Assistant
2/15/2010	Kelly,Christopher P	Facilities Plan & Inst Serv DO	OPS Career Level 3
2/22/2010	Laubaugh,Mark D	Criminal Justice AC	Instructor- Temporary Non-Cred
2/12/2010	Le,Minh Hoang	Provost CL	Federal Work Study Student
2/8/2010	Lewis Jr,Frank C	Fire Science AC	Instructor- Temporary Non-Cred
2/9/2010	Lockhart,Amy G.	Accounting Services	OPS Career Level 5
3/1/2010	Martinez,Adriana M	Enrollment Management DO	Federal Work Study Student
2/22/2010	McGill,James R	Criminal Justice AC	Instructor- Temporary Non-Cred
2/8/2010	Miller,William E	Health CE - AC	Instructor- Temporary Non-Cred
2/6/2010	O'Dowd,Cecelia Messina	Lifelong Learning NC - AC	Other Professional- Temporary
2/23/2010	Osterland Jr,Robert H	CJI AA/AS DOC AC	Instructor- Temporary Non-Cred
2/6/2010	Paden,Melanie Woods	Letters CL	OPS Career Level 5
2/15/2010	Sheldon,Justin	Natural Science CL	Federal Work Study Student
2/8/2010	Sicard,Renaud	Student Activities CL	General Service/Maint. (unskil
2/10/2010	Wainwright,Danielle	Corporate Training E&SS DO	Instructor- Temporary Non-Cred
<b>REHIRE Temporary/Supplemental</b>			
<b>Effect. Date</b>	<b>Name</b>	<b>Department/Location</b>	<b>Title</b>
2/15/2010	Bahret,Richard S	RCPI/COPS Grant - AC	Instructor- Temporary Non-Cred
2/22/2010	Brayley,Erin Renee	Mathematics SPG	Federal Work Study Student
2/5/2010	Cornett,Susan L	Letters TS	Non Instr Supplement-Not ECH
2/15/2010	Dibuono,Michael	CJI AA/AS DOC AC	Instructor- Temporary Non-Cred
2/4/2010	Finklea,Evelyn M	Letters SPG	Non Instr Supplement-Not ECH
3/1/2010	Fredenrich,Brent M	Provost TS	Technology Resource Specialist
2/26/2010	Jefferis,Bonnie L.	Letters CL	Non Instr Supplement-Not ECH
2/6/2010	Lentz,Carol A.	Letters CL	OPS Career Level 5
2/7/2010	Livingston,Michael T	Fire Science AC	Instructor- Temporary Non-Cred
2/8/2010	Newman,Roberta B	Provost SPG	OPS Career Level 2
2/5/2010	Nielsen,Polly K	Letters TS	Non Instr Supplement-Not ECH

## MINUTES OF THE SPECIAL MEETING OF MARCH 16, 2010

### BOARD OF TRUSTEES OF ST. PETERSBURG COLLEGE

2/6/2010 Sharpless, Donna Letters CL Exp Learning Assessment

#### **TRANSFER/PROMOTION Budgeted**

Effect. Date	Name	Department/Location	Title
2/20/2010	Beelman, T J	Landscape Services SE	Landscaper
2/22/2010	Gerst, Mary E	Student Activities HC	Coord, Student Activities
2/20/2010	Gibson, Greg L.	Landscape Services SE	Lndspr/Mch
2/22/2010	King, Merrian D.	Scholarships/Stu Fin Assist DO	Electronic Center Coordinator
2/20/2010	Marks, Alice M.	Scholarships/Stu Fin Assist CL	Asst Dir, Scholar&Stu Fin Asst

#### **RECLASSIFICATION Budgeted**

Effect. Date	Name	Department/Location	Title
1/25/2010	Bawell, Jennifer	District Library	Library Paraprofessional
3/1/2010	Kelley, Nancy	SPC-Downtown	Director of Student Success
2/20/2010	Kuhn, Carolyn G.	Education & Student Svcs DO	Sr. Exec. Staff Asst. to Sr.VP
2/22/2010	McLeod, Cynthia	Human Resources	HR Svcs Specialist
3/15/2010	Shirley, Hildegard E	Letters SPG	Administrative Specialist III
3/1/2010	Ulmer, Yvonne	SPC-Downtown	Campus Exec. Officer

#### **SEPARATION Budgeted**

Effect. Date	Name	Department/Location	Title
2/19/2010	Butler, Scott E.	Learning Mgt Network Sys	Systems Analyst
2/11/2010	Kornegay, Aaron Blake	Education & Student Svcs DO	Technology Resource Specialist
2/5/2010	Ogorek, Sheryl A.	Scholarships/Stu Fin Assist CL	Asst Dir, Scholar&Stu Fin Asst
2/5/2010	Reed, Tracy L.	Campus Security CL	Security Officer I

#### **RETIREMENT Budgeted**

Effect. Date	Name	Department/Location	Title
2/26/2010	Carter, Margaret A.	Provost HC	Administrative Specialist II
2/26/2010	Scott, Marilyn F	Criminal Justice AC	Academic Staff Assistant
2/26/2010	Slavin, Susan L.	District Library DO	Library Paraprofessional

#### **TERMINATION Temporary/Supplemental**

Effect. Date	Name	Department/Location	Title
2/26/2010	Arenas, Luis A.	Fine & Applied Arts SPG	Lump sum -Spec.Proj.
2/19/2010	Benoit, Rose M	Central Records DO	General Service/Maint. (unskil
2/16/2010	Cameron, Tonya Quinetta	District Library DO	Federal Work Study Student
2/26/2010	Carver, Eric H	Health Information Mgmt HC	Lump sum -Spec.Proj.
2/19/2010	De Meo, Mark F	Central Records DO	Mentor-CEX, PS, CROP
2/24/2010	Lang, Patricia Ann	Associate Provost TS	Federal Work Study Student
2/5/2010	Nicotera, Marianna	Students Activities TS	Student Assistant
2/19/2010	Przyborowski, Marta F	Associate Provost SP	OPS Career Level 2
2/14/2010	Sanders, Beth Ann	Enrollment Management DO	Federal Work Study Student
2/18/2010	Stevens, Craig A	Enrollment Management DO	Instructor- Temporary Non-Cred
2/19/2010	Thackrah, Melinda J	Clearwater Campus Provost	Federal Work Study Student
2/26/2010	Tuck, Sasha D.	Fine & Applied Arts SPG	Lump sum -Spec.Proj.
2/9/2010	Turner, Jasmine L	Social Science SE	Instructor - Temporary Credit
2/9/2010	Turner, Jasmine L	Social Science SE	Instructor - Temporary Credit
2/11/2010	Wilson, Heba Wasfi	Scholarships/Stu Fin Assist CL	Federal Work Study Student
2/12/2010	Irwin Jr, David E.	Fine & Applied Arts SPG	Lump sum -Spec.Proj.
2/12/2010	Prescott, Barbara	Fine & Applied Arts SPG	Lump sum -Spec.Proj.

#### **DEGREE CHANGE Budgeted**

Effect. Date	Name	Department/Location	Title
1/4/2010	Gillis, Alrene	BA Programs/UPC	Instructor

**MINUTES OF THE SPECIAL MEETING OF MARCH 16, 2010**

**BOARD OF TRUSTEES OF ST. PETERSBURG COLLEGE**

<b>RETURN FROM LEAVE Budgeted</b>			
<b>Effect. Date</b>	<b>Name</b>	<b>Department/Location</b>	<b>Title</b>

12/5/09-2/23/10	McHugh, Mark P.	Campus Security CL	Senior Security Officer
-----------------	-----------------	--------------------	-------------------------

Thomas E. Furlong, Jr., President; Patty Jones, Vice President, Human Resources & Public Affairs; and the Cabinet members bringing the actions forward, recommend approval.

emg 0310104

Board Material Relating to  
Agenda Item IX-F.2  
Meeting: March 16, 2010

**BOARD OF TRUSTEES  
ST. PETERSBURG COLLEGE**

**Extension of Aetna Administrative Services**

**Approval is sought for a three-month extension of the Aetna Administrative Services Agreement, through Sept. 30, 2010.**

This represents no increase in the monthly fees to Aetna for the medical or dental portions of the health plan. SPC is seeking alternative health plan options for 2010-11 and is also planning to switch the college's health plan year to 10/1-9/30.

Thomas E. Furlong, President, and Patty Curtin Jones, Vice President, Human Resources & Public Affairs, recommend approval.

Attachment  
pj0301101

# MINUTES OF THE SPECIAL MEETING OF MARCH 16, 2010

## BOARD OF TRUSTEES OF ST. PETERSBURG COLLEGE

### Administrative Service Fees

#### ASC

The Board of Trustees of St. Petersburg College

Contractholder Number - 727557

Renewal Period: 7/1/09 through 9/30/10

- The below Administrative Service Fees will become effective 7/1/09.
- The fees below exclude charges for items such as printing, special reports and late fees. These will be billed separately.
- The below ASC fees assume that Aetna will be Claim Fiduciary.
- Simple Steps to a Healthier Life is Included in the below ASC fees.
- Simple Steps Rewards Tracking has been ADDED to the below ASC fees
- Beginning Right<sup>SM</sup> Maternity Program has been REMOVED from the below ASC fees.
- Quit Tobacco has been ADDED to the below ASC fees
- The National Advantage programs have been included in the renewal at a charge of 40% of any attained savings (increased from 35%).
- Rx rebate share is 20% (based on the enrollment assumptions below).
- Renewal period has been extended through Sept. 30, 2010.

#### Service Fee Comparison

##### Projected Number of Enrolled Employees

OA Select / APM	1197
CPII / APM	82
Dental	1322

Current Period  
7/1/08-6/30/09

Projected Period  
7/1/09-9/30/10

##### Administrative Service Fees as Billed (PEPM)

OA Select / APM	44.59	45.93
CPII / APM	46.13	47.33
Dental	4.45	4.45

##### Administrative Service Fees as Total Contract Period Dollars

OA Select / APM	640,491	824,673
CPII / APM	45,392	58,216
Dental	70,595	88,244

<b>Total Service Fee</b>	<b>\$ 756,477</b>	<b>\$ 971,133</b>
--------------------------	-------------------	-------------------

Board Material Relating to  
Agenda Item IX-F.3  
Meeting: March 16, 2010

**BOARD OF TRUSTEES  
ST. PETERSBURG COLLEGE**

**Life Insurance Provider**

**MINUTES OF THE SPECIAL MEETING OF MARCH 16, 2010**

**BOARD OF TRUSTEES OF ST. PETERSBURG COLLEGE**

**Approval is sought for a three-month extension to the college's group term life insurance plan provided by Aetna, through Sept. 30, 2010.**

This represents no increase in the monthly fees to Aetna for the term life insurance plan for all budgeted employees. SPC is planning to switch the college's insurance plan year to 10/1-9/30.

Thomas E. Furlong, President, and Patty Curtin Jones, Vice President, Human Resources & Public Affairs, recommend approval.

Attachment  
pj0301101



The Board of Trustees of St. Petersburg College  
Customer Number: 727557

**Renewal Billing Rates and Annual Premium**

Rate Comparison	Volume	Existing Rates	Annual Premium	New Rates Effective 7/1/09	Premium for 15 months	% Change																																																																													
<b><u>Basic Term Life</u></b>																																																																																			
Employee per \$1,000 Active employees:	\$68,968,000	\$0.210	\$173,799	\$0.210	\$217,249	0.0%																																																																													
Retirees:	\$585,000	\$2.360	\$16,567	\$2.360	\$20,709	0.0%	<b><u>Supplemental Term Life</u></b>							Employee per \$1,000	\$26,014,000	\$0.250	\$78,042	\$0.250	\$97,553	0.0%	<b><u>Dependent Term Life</u></b>							Spouse per \$1,000	\$2,089,000	\$0.250	\$6,267	\$0.250	\$7,834	0.0%	Child per \$1,000	\$283,000	\$0.110	\$374	\$0.110	\$467	0.0%	<b><u>Basic AD&amp;D</u></b>							Employee per \$1,000 Active employees:	\$68,968,000	\$0.027	\$22,346	\$0.027	\$27,932	0.0%	Retirees:	\$180,000	\$0.060	\$130	\$0.060	\$162	0.0%	<b><u>Supplemental AD&amp;D</u></b>							Employee per \$1,000	\$26,014,000	\$0.027	\$8,429	\$0.027	\$10,536	0.0%	<b>Total Annual Premium</b>			<b>\$305,953</b>		<b>\$382,441</b>	<b>25.0%</b>
<b><u>Supplemental Term Life</u></b>																																																																																			
Employee per \$1,000	\$26,014,000	\$0.250	\$78,042	\$0.250	\$97,553	0.0%																																																																													
<b><u>Dependent Term Life</u></b>																																																																																			
Spouse per \$1,000	\$2,089,000	\$0.250	\$6,267	\$0.250	\$7,834	0.0%																																																																													
Child per \$1,000	\$283,000	\$0.110	\$374	\$0.110	\$467	0.0%																																																																													
<b><u>Basic AD&amp;D</u></b>																																																																																			
Employee per \$1,000 Active employees:	\$68,968,000	\$0.027	\$22,346	\$0.027	\$27,932	0.0%																																																																													
Retirees:	\$180,000	\$0.060	\$130	\$0.060	\$162	0.0%																																																																													
<b><u>Supplemental AD&amp;D</u></b>																																																																																			
Employee per \$1,000	\$26,014,000	\$0.027	\$8,429	\$0.027	\$10,536	0.0%																																																																													
<b>Total Annual Premium</b>			<b>\$305,953</b>		<b>\$382,441</b>	<b>25.0%</b>																																																																													

\*Rates will be effective until 9/30/2010





# MINUTES OF THE SPECIAL MEETING OF MARCH 16, 2010

## BOARD OF TRUSTEES OF ST. PETERSBURG COLLEGE

### NOTICE OF SPECIAL MEETING AND CANCELLATION OF REGULAR MEETING BOARD OF TRUSTEES, ST. PETERSBURG COLLEGE AND NOTICE OF ADOPTION, AMENDMENT OR REPEAL OF RULES AND HEARING

The Board of Trustees of St. Petersburg College announces a public meeting to which all persons are invited.

**DATE AND TIME:** March 16, 2010; Board meeting commencing at 8:30 a.m. (The meeting, which was previously scheduled to be held on the same date at 8:30 a.m. at the EpiCenter of St. Petersburg College, Conference Room 1-453, 13805 58th Street North, Largo, Florida, has been canceled.)

**PLACE:** The meeting will be held in Room 107 at SPC Midtown, 1048 22nd Street South, St. Petersburg, Florida 33712.

**PURPOSE:** The meeting will be held for the purpose of considering routine business and such other matters that come before the Board including adopting or amending rules of the Board of Trustees pursuant to its rule-making authority.

A copy of the Agenda, proposed rules and statement of regulatory costs may be obtained by writing the Board of Trustees in care of the Board Clerk, P.O. Box 13489, St. Petersburg, Florida 33733, or calling the Board Clerk at 727-341-3260 or may be reviewed at the Campus locations referred to below.

The proposed rules and/or amendments, together with the purpose and effect and specific legal authority, will be posted no later than Friday, February 19, 2010, on the official bulletin boards as follows: at the St. Petersburg/Gibbs and Clearwater Campuses in the entrance to the libraries; at the Tarpon Springs Campus in the Lyceum Building across from Room LY 104; at the EpiCenter—Services Building, in the north corridor across from Room 168; at the EpiCenter, in the hall near Room 1-108; in Work Room 147 at the EpiCenter—District Office; on the south wall, across from the waiting area under the stairs, at the Health Education Center; outside Room UP 156 at the Seminole Campus; outside the Florida Room at the Allstate Center; in the lobby across from the admissions and registration desk of the SPC Downtown Center; on the wall adjacent to Room 105 at SPC Midtown and advertised in a newspaper of general circulation and in the Blue and White Faculty and Staff Announcements.

The Notice(s) of Rule Development on the foregoing rule(s) appeared in the Blue & White Faculty & Staff Announcements and was posted on each of the College's official bulletin boards on January 22, 2010. Said Notice(s) also appeared in the Gulf Coast Business Review on January 22, 2010.

Please note that the proposed changes to the rules attached do not reflect changes (if any) which are pending or have recently been approved by the Board of Trustees.

Any person wishing to be heard on the proposed rule(s) and/or amendments will be provided an opportunity to do so by appearing before the Board at said meeting.

If requested within 21 days after the date of publication of this notice, a hearing on the proposed rule(s) or amendments thereto will be held at 8:30 a.m. or soon

thereafter on March 16, 2010, in Room 107 at SPC Midtown, 1048 22nd Street South, St. Petersburg, Florida. See Section 120.54(3)(c), Florida Statutes.

Any person who is substantially affected by the above rules may seek an administrative determination of the invalidity of any proposed rule on the ground that proposed rule is an invalid exercise of the Board's delegated legislative authority. Such request shall be by Petition in writing and filed within 21 days after the date of publication of this notice. See Section 120.56(2), Florida Statutes.

Any person who wishes to provide the Board with information regarding the statement of estimated regulatory costs, or to provide a proposal for a lower cost regulatory alternative as provided by Section 120.54(1), Florida Statutes, must do so in writing within 21 days after the date of publication of this notice.

If any person wishes to appeal a decision made with respect to any matter considered by the Board, he or she will need a record of the proceedings. It is the obligation of such person to ensure that a verbatim record of the proceedings is made. See Section 286.0105, Florida Statutes.

Pursuant to the provisions of the Americans with Disabilities Act, any person requiring special accommodations to participate in this workshop/hearing/meeting is asked to advise the agency two business days (at least 48 hours) before the workshop/hearing/meeting by contacting the Board Clerk at 727-341-3260. If you are planning to attend the workshop/hearing/meeting and are hearing impaired, please contact the agency by calling 727-791-2628 (V/TDD).

Information regarding the proposed rule(s) and/or amendments for consideration and intended action is attached to this Notice.

**NAME OF AGENCY:** BOARD OF TRUSTEES, ST. PETERSBURG COLLEGE

**RULE TITLE:** GENERAL EDUCATION REQUIREMENTS FOR ASSOCIATE DEGREE PROGRAMS

**RULE NO.:** 6Hx23-4.32

**RULE NOTICE DATE:** February 19, 2010

**PURPOSE AND EFFECT:** The proposed revisions will add the course AML1600 African-American Literature to the list of courses that may be taken as part of the Communications requirements for the A.A. Degree, A.S. Degree, and A.A.S. Degree.

**SUBJECT AREA TO BE ADDRESSED:** See Purpose and Effect above.

**SUMMARY:** See Purpose and Effect above.

**SPECIFIC AUTHORITY:** 1001.64 (2) & (4), F.S.

**LAW IMPLEMENTED:** 1004.03, 1007.24, 1007.25, 1004.65, 1004.68, 1009.23, 1009.25, 1009.26, 1001.64(10), 1007.263, F.S.; Rule 6A-14.030, F.A.C.

**SUMMARY STATEMENT OF ESTIMATED REGULATORY COSTS:** The proposed changes to the Rule will affect students taking A.A., A.S.; or A.A.S. degree programs. There is no cost to the College associated with this amendment. There is no anticipated adverse effect on state or local government. There are no transactional costs associated with this amendment. There is no anticipated adverse impact on small business.

**PROPOSED DATE TO BECOME EFFECTIVE:** Upon Board Approval  
February 19, 2010

10-01876

Board Material Relating to  
Agenda Item IX-G  
Meeting: March 16, 2010

**BOARD OF TRUSTEES  
ST. PETERSBURG COLLEGE**

**MINUTES OF THE SPECIAL MEETING OF MARCH 16, 2010**

**BOARD OF TRUSTEES OF ST. PETERSBURG COLLEGE**

**Board of Trustees' Rules**

**Approval is sought for the following proposed changes to the Rules and Procedures Manual, which are being submitted for your consideration:**

**6Hx23-4.32 General Education Requirements for Associate Degree Programs**

The proposed revisions will add the course AML 1600 African-American Literature to the list of courses that may be taken as part of the Communications requirements for the A.A. Degree, A.S. Degree, and A.A.S. Degree. *Submitted by Anne Cooper.*

Thomas E. Furlong, Jr., President and Sydney H. McKenzie, III, General Counsel recommend approval.

Attachment

ps0226101

- 6Hx23-4.32 I. GENERAL EDUCATION REQUIREMENTS FOR ASSOCIATE DEGREE PROGRAMS (Changes highlighted in yellow)
- A. Changes to course numbers and titles are made by the State Department of Education on a regular basis. Such changes to any courses will be effective when approved by the State Department of Education despite any delays in correcting the course numbers and titles. The Board hereby grants the President the authority, without further Board approval, to amend this Rule and other Board of Trustees' rules wherein course titles and numbers are listed, to provide for the correction of course numbers and titles as are approved by the State Department of Education.
  - B. To provide students with an enhanced world view in light of an increasingly globalized economy, students must include at least one of the following courses as part of the general education requirements for the Associate in Arts, Associate in Science, and Associate in Applied Science degrees.

**MINUTES OF THE SPECIAL MEETING OF MARCH 16, 2010**

**BOARD OF TRUSTEES OF ST. PETERSBURG COLLEGE**

LIT 2110 World Literature I  
LIT 2110H Honors World Literature I  
LIT 2120 World Literature II  
LIT 2120H Honors World Literature II  
HUM 2270 Humanities (East-West Synthesis)  
HUM 2270H Honors Humanities  
(East-West Synthesis)  
REL 2300 World Religions  
INR 2002 International Relations  
INR 2002H Honors International Relations  
WOH 2040 The Twentieth Century  
WOH 2040H Honors The Twentieth Century

II. GENERAL EDUCATION REQUIREMENTS FOR THE ASSOCIATE IN ARTS DEGREE

The general education requirements for the Associate in Arts degree consist of a minimum of 36 semester hours of credit. The minimum area requirements for the 36 semester hours are as follows:

Word Count

A. Area I COMMUNICATIONS (a minimum of 9 semester hours with a grade of "C" or higher). This requirement may be met by completing 1, 2, **and** 3 below:

6,000 words

1. ENC 1101 Composition I  
**or**  
ENC 1121H Honors Composition I

NOTE: ENC 1101 **or** ENC 1121H must be completed within the first 24 semester hours of coursework at St. Petersburg College in the A.A. Degree Program.

6,000 words

2. One of the following 3 semester hour courses:

**AML 1600 African-American Literature**  
ENC 1102 Composition II  
ENC 1122H Honors Composition II  
AML 2010 American Literature I **OR** (AML 2010 H)  
AML 2020 American Literature II **OR** (AML 2020H)

**MINUTES OF THE SPECIAL MEETING OF MARCH 16, 2010**

**BOARD OF TRUSTEES OF ST. PETERSBURG COLLEGE**

ENL 2012	British Literature I <b>OR</b> (ENL 2012H)
ENL 2022	British Literature II
LIT 2110	World Literature I <b>OR</b> (LIT 2110H)
LIT 2120	World Literature II <b>OR</b> (LIT 2120H)

NOTE: ENC 1102 **or** its equivalent course from this list must be completed within the first 36 semester hours of coursework at St. Petersburg College in the A.A. Degree Program.

2,000 words

3. One of the following 3 semester hour courses:

SPC 1600	Introduction to Speech Communication
SPC 1600H	Honors Introduction to Speech Communication
SPC 1016	Business and Professional Speaking
SPC 1060	Public Speaking
SPC 1060H	Honors Public Speaking

B. Area II HUMANITIES/FINE ARTS (a minimum of 6 semester hours with a grade of "C" or higher). This requirement may be met by completing 1 **and** 2 below:

2,000 words

- \*HUM 2210 Western Humanities I (Ancient through Renaissance)  
**or**  
\*HUM 2210H Honors Western Humanities I (Ancient through Renaissance)  
**or**  
\*HUM 2233 Western Humanities II ( Baroque to the Present)  
**or**  
\*HUM 2233H Honors Western Humanities II (Baroque to the Present)  
**or**  
\*\*HUM 2250 Humanities (Western Man)  
**or**  
\*\*HUM 2250H Honors Humanities (Western Man)

**MINUTES OF THE SPECIAL MEETING OF MARCH 16, 2010**

**BOARD OF TRUSTEES OF ST. PETERSBURG COLLEGE**

\*Students who have received credit for HUM 2250 cannot also receive credit for HUM 2210 **or** HUM 2233

\*\*For students who completed HUM 2250 prior to Session I, 1996-97

2,000 words

2. One of the following 3 semester hour courses:

ARH 1000	Understanding Art
ARH 2050	Art History I
ARH 2051	Art History II
HUM 2210	Western Humanities I (Ancient through Renaissance)
HUM 2210H	Honors Western Humanities I (Ancient through Renaissance)
HUM 2233	Western Humanities II (Baroque to the Present)
HUM 2233H	Honors Western Humanities II (Baroque to the Present)
HUM 2270	Humanities (East-West Synthesis)
HUM 2270H	Honors Humanities (East-West Synthesis)
MUH 1110	Introduction to Music
MUL 1010	Introduction to Music History
PHI 1010	Introduction to Philosophy
REL 2300	World Religions

C. Area III MATHEMATICS (a minimum of 6 semester hours with a grade of "C" or higher). This requirement may be met by completing a minimum of two courses with a MAC, MAP, MAS, MGF, **or** MTG prefix.

STA 2023 may be substituted for any one course.

D. Area IV NATURAL SCIENCES (a minimum of 6 semester hours including at least one laboratory course, shown with an "L" in the prefix, **or** a laboratory/lecture course shown with a "C" in the prefix). This requirement may be met by completing courses from 1 **and** 2 below (at

## MINUTES OF THE SPECIAL MEETING OF MARCH 16, 2010

### BOARD OF TRUSTEES OF ST. PETERSBURG COLLEGE

least one from biological sciences and one from physical sciences); **OR** 9 semester hours (if not including a laboratory experience) from a combination of the biological science field **and** the physical science field; **OR** a minimum of 12 semester hours from either field.

1. Biological Science field courses (a minimum of 3 semester hours from the following):

BOT 1000C Botany with Lab  
BSC XXXX/XXXXL Any course with a BSC  
(Biology) prefix  
HUN 1201 Science of Nutrition  
MCB 2010-2010L Microbiology and Lab  
OCB 1000C Biology of Marine Life

2. Physical Science field courses (a minimum of 3 semester hours from the following):

AST XXXX/XXXXL Any course with an AST  
(Astronomy) prefix

(Note: Students taking AST 1002 cannot also receive credit for AST 1003 or AST 1004)

CHM XXXX/XXXXL Any course with a CHM  
(Chemistry) prefix  
GLY XXXX/XXXXL Any course with a GLY  
(Geology) prefix  
PHY XXXX/XXXXL Any course with a PHY  
(Physics) prefix  
PSC XXXX/XXXXL Any course with a PSC  
(Physical science) prefix  
EVS 1001 Introduction to Environmental  
Science  
ISC 1001L Methods of Science Laboratory  
ESC 1000 Earth Sciences  
ESC 1000L Earth Science Lab  
MET 2010 Introductory Meteorology  
MET XXXXL Meteorology Lab

**MINUTES OF THE SPECIAL MEETING OF MARCH 16, 2010**

**BOARD OF TRUSTEES OF ST. PETERSBURG COLLEGE**

OCE 2001 Introduction to Oceanography  
OCE 2001L Oceanography Laboratory

E. Area V SOCIAL AND BEHAVIORAL SCIENCES (a minimum of 6 semester hours with a grade of "C" or higher). This requirement may be met by completing 1 **and** 2 below:

2,000 words

1. POS 2041 American National Government  
**or**  
POS 2050H Honors American Government

2,000 words

2. One of the following 3 semester hour courses:

AMH 1091 African-American History  
AMH 2010 History of the United States to 1865  
(or Honors)  
AMH 2020 History of the United States from  
1865 (or Honors)  
AMH 2059 The United States in Vietnam  
ANT 2000 Introduction to Anthropology  
ANT 2003 Survey of Anthropology  
ANT 2410 Cultural Anthropology  
ECO 2013 Principles of Macroeconomics (or  
Honors)  
ECO 2023 Principles of Microeconomics (or  
Honors)  
EUH 1000 Development of Western Civilization  
I to 1500  
EUH 1001 Development of Western Civilization  
II from 1500  
GEA 2172 Geography of the Developing World  
GEA 2174 Geography of the Developed World  
INR 2002 International Relations (or Honors)  
POS 2112 State and Local Government  
PSY 1012 General Psychology (or Honors)  
SYG 2000 Introductory Sociology  
SYG 2010 Social Problems  
SYG 2221 Women and Society  
SYG 2430 Marriage and Family  
WOH 2040 The Twentieth Century (or Honors)



**MINUTES OF THE SPECIAL MEETING OF MARCH 16, 2010**

**BOARD OF TRUSTEES OF ST. PETERSBURG COLLEGE**

- F. Area VI ETHICS (a minimum of 3 semester hours with a grade of "C" or higher).

2,000 words

This requirement may be met by completing any one of the following:

PHI 1600 Studies in Applied Ethics  
PHI 1602H Honors Studies in Applied Ethics  
PHI 1631 Studies in Professional Ethics  
PHI 2635 Health Care Ethics Applied  
PHI 2649 Applied Ethics in Public Safety Professions

**or** by completing:

PHI 1603 **and** either PHI 2621 **or** PHI 2622

- G. Area VII COMPUTER/INFORMATION LITERACY COMPETENCY (no minimum credit hours required). Computer/information literacy competency may be demonstrated by completing one of the following:

1. Passing a College-approved Basic Computer/Information Skills Competency Test; **or**
2. Successful completion of at least one of the following:
  - a. CTS 1101 Basic Computer and Information Literacy
  - b. CGS 1100 Microcomputer Applications (as revised in 2002) **or**  
  
LIS 1002, CGS 1510 **and** OST 1741;
  - c. EME 2040 Introduction to Educational Technology (as revised in 2002), preferred for Education majors.

**MINUTES OF THE SPECIAL MEETING OF MARCH 16, 2010**

**BOARD OF TRUSTEES OF ST. PETERSBURG COLLEGE**

- d. DEH 3730, DEH 3813, DEH 3814 **and** DEH 4607.

New courses approved by the Board of Trustees meeting the computer/information literacy criteria may be permitted to satisfy the computer competency requirement for graduation. The approved curriculum will be presented by amendment to this Rule within six months of approval by the Board of Trustees.

III. ALTERNATIVE PLAN FOR COLLEGE WRITING REQUIREMENTS IN THE ASSOCIATE IN ARTS DEGREE PROGRAM—INTERDISCIPLINARY STUDIES

[SBE Rule 6A-010.030(2)(a)]

The Board of Trustees of St. Petersburg College has submitted to the State Board of Education and had approved an alternative to the provision of this Rule requiring students to produce written work of at least 24,000 words in 12 semester hours of English coursework. Students who are eligible for honors courses or who have the permission of a dean may enroll in this option to the regular general education program. The alternative requires a grade of “C” or higher in each course, and the minimum area requirements for this 24-27 credit hour option are as follows:

A. Areas I, II and V above:

INTERDISCIPLINARY STUDIES (a minimum of 24 semester hours). This requirement may be met by completing 1, 2, **and** 3 below:

1. IDS 1101H Honors Interdisciplinary Studies – Ancient to Renaissance (9 semester hours)\*
2. IDS 1102H Honors Interdisciplinary Studies – Baroque to Modern (9 semester hours)\*
3. IDS 2103H Honors Interdisciplinary Studies – The American Experience (6 semester hours)\* **OR**
4. IDS 2106H America and the World (9 semester hours)\*

## MINUTES OF THE SPECIAL MEETING OF MARCH 16, 2010

### BOARD OF TRUSTEES OF ST. PETERSBURG COLLEGE

\*A grade of "C" or higher is required for each of these courses.

Note: Students partially completing the Interdisciplinary Studies will receive advanced standing credit toward the completion of the general education program, Section I above, as follows:

1. IDS 1101H - ENC 1121H, HUM 2210H, **and** SPC 1600H.
2. IDS 1102H - LIT 2120H, HUM 2233H, **and** AMH 2020H.
3. IDS 2103H - POS 2050H **and** AMH 2010H **OR**
4. IDS 2106H - POS 2050H, ECO2013H, **AND** AMH 2010H.

- B. Areas III, IV, **and** VII  
No general education alternatives for IDS Studies.

#### IV. GENERAL EDUCATION REQUIREMENTS FOR THE ASSOCIATE IN SCIENCE DEGREE

The general education requirements for the Associate in Science degree consist of a minimum of 17 transferable semester hours of credit. The minimum area requirements for the 17 transferable semester hours are as follows:

- A. Area I COMMUNICATIONS (6-9 semester hours with a grade of "C" or higher). This requirement may be met by completing either 1, 2 and 3 **or** 1 and 3 below:

1. ENC 1101 Composition I within the first 24 semester hours of coursework in the Associate in Science Program at St. Petersburg College **or** ENC 1121H Honors Composition I

#### **and IF REQUIRED BY PROGRAM**

2. ENC 1102 Composition II within the first 36 semester hours of coursework in the Associate in Science Program at St. Petersburg College **or**  
ENC 1122H Honors Composition II **or**  
**AML 1600 African-American Literature**

**MINUTES OF THE SPECIAL MEETING OF MARCH 16, 2010**

**BOARD OF TRUSTEES OF ST. PETERSBURG COLLEGE**

AML 2010	American Literature I	<b>or</b>
AML 2010H	Honors American Literature I	
AML 2020	American Literature II	<b>or</b>
AML 2020H	Honors American Literature II	
ENL 2012	British Literature I	<b>or</b>
ENL 2012H	Honors British Literature I	
ENL 2022	British Literature II	
LIT 2110	World Literature I	<b>or</b>
LIT 2110H	Honors World Literature I	
LIT 2120	World Literature II	<b>or</b>
LIT 2120H	Honors World Literature II	

3. SPC 1600 Introduction to Speech Communication  
**or**  
SPC 1600H Honors Introduction to Speech  
Communication  
**or**  
SPC 1016 Business and Professional  
Speaking  
**or**  
SPC 1060 Public Speaking  
**or**  
SPC 1060H Honors Public Speaking

- B. Area II HUMANITIES/FINE ARTS (3 semester hours with a grade of "C" or higher). This requirement may be met by completing one of the 3 semester hour courses below:

ARH 1000	Understanding Art
ARH 2050	Art History I
ARH 2051	Art History II
*HUM 2210	Western Humanities I (Ancient through Renaissance)
*HUM 2210H	Honors Western Humanities I (Ancient through Renaissance)
*HUM 2233	Western Humanities II (Baroque to the Present)
*HUM 2233H	Honors Western Humanities II (Baroque to the Present)

**MINUTES OF THE SPECIAL MEETING OF MARCH 16, 2010**

**BOARD OF TRUSTEES OF ST. PETERSBURG COLLEGE**

HUM 2270	Humanities (East-West Synthesis)
HUM 2270H	Honors Humanities(East-West Synthesis)
MUH 1110	Introduction to Music
MUL 1010	Introduction to Music History
PHI 1010	Introduction to Philosophy
REL 2300	World Religions
**HUM 2250	Humanities (Western Man) <b>or</b>
**HUM 2250H	Honors Humanities (Western Man)

\*Students who have received credit for HUM 2250 cannot also receive credit for HUM 2210 **or** HUM 2230

\*\*For students who completed HUM 2250 prior to Session I, 1996-97

C. Area III MATHEMATICS (3 semester hours with a grade of "C" or higher).

Any course with an MAC, MAP, MAS, MGF, STA **or** MTG prefix

D. Area IV NATURAL SCIENCES (no minimum credit hours required for general education for the A. S. degree except by the specific A.S. articulated programs).

E. Area V SOCIAL AND BEHAVIORAL SCIENCES (3 semester hours with a grade of "C" or higher). This requirement may be met by completing one of the 3 semester hour courses below:

AMH 1091	African-American History
AMH 2010	History of the United States I (or Honors)
AMH 2020	History of the United States II (or Honors)
AMH 2059	The United States in Vietnam
ANT 2000	Introduction to Anthropology

**MINUTES OF THE SPECIAL MEETING OF MARCH 16, 2010**

**BOARD OF TRUSTEES OF ST. PETERSBURG COLLEGE**

ANT 2003	Survey of Anthropology
ANT 2410	Cultural Anthropology
ECO 2013	Principles of Macroeconomics <b>or</b>
ECO 2013H	Honors Principles of Macroeconomics
EUH 1000	Development of Western Civilization I
EUH 1001	Development of Western Civilization II
GEA 2172	Geography of the Developing Worlds
GEA 2174	Geography of the Developed World
INR 2002	International Relations <b>or</b>
INR 2002H	Honors International Relations
POS 2041	American National Government <b>or</b>
POS 2050H	Honors American National Government
POS 2112	State and Local Government
PSY 1012	General Psychology <b>or</b>
PSY 1020H	Honors General Psychology
SYG 2000	Introductory Sociology
SYG 2010	Social Problems
SYG 2221	Women and Society
SYG 2430	Marriage and Family
WOH 2040	The Twentieth Century (or Honors)

F. Area VI ETHICS (2-3 semester hours with a grade of "C" or higher). This requirement may be met by completing one of the following as determined by the course of study:

PHI 1603	Applied Ethics
<b>or</b>	
PHI 1600	Studies in Applied Ethics,
<b>or</b>	
PHI 1602H	Honors Studies in Applied Ethics,
<b>or</b>	
PHI 1631	Studies in Professional Ethics
<b>or</b>	
PHI 2635	Health Care Ethics Applied
PHI 2649	Applied Ethics in Public Safety Professions

G. Area VII COMPUTER/INFORMATION LITERACY

**MINUTES OF THE SPECIAL MEETING OF MARCH 16, 2010**

**BOARD OF TRUSTEES OF ST. PETERSBURG COLLEGE**

COMPETENCY (no minimum credit hours required).  
Computer/information literacy competency may be demonstrated by completing one of the following:

1. Passing a College-approved Basic Computer/Information Skills Competency Test; **or**
2. Successful completion of at least one of the following:
  - a. CTS 1101 Basic Computer and Information Literacy
  - b. CGS 1100 Microcomputer Applications (as revised in 2002) **or**  
  
LIS 1002, CGS 1510 **and** OST 1741;
  - c. EME 2040 Introduction to Educational Technology (as revised in 2002), preferred for Education majors.
  - d. DEH 3730, DEH 3813, DEH 3814 **and** DEH 4607.

New courses approved by the Board of Trustees meeting the computer/information literacy criteria may be permitted to satisfy the computer competency requirement for graduation. The approved curriculum will be presented by amendment to this Rule within six months of approval by the Board of Trustees.

TOTAL (17 semester hours)

Programs may limit the options available under Mathematics, Humanities/Fine Arts, and Social and Behavioral Sciences.

V. GENERAL EDUCATION REQUIREMENTS FOR THE ASSOCIATE IN APPLIED SCIENCE DEGREE

## MINUTES OF THE SPECIAL MEETING OF MARCH 16, 2010

### BOARD OF TRUSTEES OF ST. PETERSBURG COLLEGE

The general education requirements for the Associate in Applied Science degree consist of a minimum of 18 semester hours of credit. The minimum area requirements for the 18 semester hours are as follows:

A. Area I COMMUNICATIONS (6-9 semester hours). This requirement may be met by completing either 1, 2 and 3 or 1 and 3 below:

1. ENC 1101 Composition I within the first 24 semester hours of coursework in the Associate in Applied Science Program at St. Petersburg College  
or ENC 1121H Honors Composition I

#### **and IF REQUIRED BY PROGRAM**

2. ENC 1102 Composition II within the first 36 semester hours of coursework in the Associate in Applied Science Program at St. Petersburg College  
or  
ENC 1122H Honors Composition II or  
**AML 1600 African-American Literature**  
AML 2010 American Literature I or  
AML 2010H Honors American Literature I  
AML 2020 American Literature II or  
AML 2020H Honors American Literature II  
ENL 2012 British Literature I or  
ENL 2012H Honors British Literature I  
ENL 2022 British Literature II  
LIT 2110 World Literature I or  
LIT 2110H Honors World Literature I  
LIT 2120 World Literature II or  
LIT 2120H Honors World Literature II
3. SPC 1600 Introduction to Speech Communication  
or  
SPC 1600H Honors Introduction to Speech Communication



**MINUTES OF THE SPECIAL MEETING OF MARCH 16, 2010**

**BOARD OF TRUSTEES OF ST. PETERSBURG COLLEGE**

**or**  
SPC 1016 Business and Professional  
Speaking

**or**  
SPC 1060 Public Speaking

**or**  
SPC 1060H Honors Public Speaking

B. Area II HUMANITIES/FINE ARTS (3 semester hours). This requirement may be met by completing one of the 3 semester hour courses below:

ARH 2050 Art History I  
ARH 2051 Art History II  
\*HUM 2210 Western Humanities I  
(Ancient through Renaissance)  
\*HUM 2210H Honors Western Humanities I  
(Ancient through Renaissance)  
\*HUM 2233 Western Humanities II  
(Baroque to the Present)  
\*HUM 2233H Honors Western Humanities II  
(Baroque to the Present)  
HUM 2270 Humanities (East-West Synthesis)  
HUM 2270H Honors Humanities(East-West  
Synthesis)  
MUH 1110 Introduction to Music  
ORI 2000 Oral Interpretation of Literature  
PHI 1010 Introduction to Philosophy  
REL 2300 World Religions  
THE 2000 Introduction to Theatre Arts  
\*\*HUM 2250 Humanities (Western Man)  
**or**  
\*\*HUM 2250H Honors Humanities (Western Man)

\*Students who have received credit for HUM 2250 cannot also receive credit for HUM 2210 **or** HUM 2233

\*\*For students who completed HUM 2250 prior to Session I, 1996-97

**MINUTES OF THE SPECIAL MEETING OF MARCH 16, 2010**

**BOARD OF TRUSTEES OF ST. PETERSBURG COLLEGE**

C. Area III MATHEMATICS (3 semester hours).

Any course with an MAC, MAP, MAS, MAT, MGF, STA, or MTG prefix

D. Area IV NATURAL SCIENCES (no minimum credit hours required for general education for the A.A.S. degree except by the specific A.S. articulated programs).

E. Area V SOCIAL AND BEHAVIORAL SCIENCES (3 semester hours). This requirement may be met by completing one of the 3 semester hour courses below:

AMH 1091	African-American History
AMH 2010	History of the United States I (or Honors)
AMH 2020	History of the United States II (or Honors)
ANT 2000	Introduction to Anthropology
ANT 2410	Cultural Anthropology
ECO 2000	Introduction to Economics
ECO 2013	Principles of Macroeconomics <b>or</b>
ECO 2013H	Honors Principles of Macroeconomics
EUH 1000	Development of Western Civilization I
EUH 1001	Development of Western Civilization II
POS 2041	American National Government or
POS 2050H	Honors American National Government
POS 2112	State and Local Government
PSY 1012	General Psychology <b>or</b>
PSY 1020H	Honors General Psychology
SYG 2000	Introductory Sociology
SYG 2010	Social Problems
WOH 2040	The Twentieth Century (or Honors)

F. Area VI ETHICS (3 semester hours)

PHI 1600	Studies in Applied Ethics,
<b>or</b>	
PHI 1602H	Honors Studies in Applied Ethics,
<b>or</b>	

**MINUTES OF THE SPECIAL MEETING OF MARCH 16, 2010**

**BOARD OF TRUSTEES OF ST. PETERSBURG COLLEGE**

PHI 1631        Studies in Professional Ethics,  
**or**  
PHI 2635        Health Care Ethics Applied  
PHI 2649        Applied Ethics in Public Safety  
                         Professions

G. Area VII COMPUTER/INFORMATION LITERACY  
COMPETENCY (no minimum credit hours required).  
Computer/information literacy competency may be  
demonstrated by completing one of the following:

1. Passing a College-approved Basic  
Computer/Information Skills Competency Test; **or**
2. Successful completion of at least one of the  
following:
  - a. CTS 1101 Basic Computer and Information  
Literacy
  - b. CGS 1100 Microcomputer Applications (as  
revised in 2002) **or**  
  
LIS 1002, CGS 1510 **and** OST 1741;
  - c. EME 2040 Introduction to Educational  
Technology (as revised in 2002), preferred for  
Education majors.
  - d. DEH 3730, DEH 3813, DEH 3814 **and** DEH  
4607.

New courses approved by the Board of Trustees  
meeting the computer/information literacy criteria  
may be permitted to satisfy the computer  
competency requirement for graduation. The  
approved curriculum will be presented by  
amendment to this Rule within six months of  
approval by the Board of Trustees.

TOTAL (18 semester hours)

**MINUTES OF THE SPECIAL MEETING OF MARCH 16, 2010**

**BOARD OF TRUSTEES OF ST. PETERSBURG COLLEGE**

Programs may limit the options available under Mathematics, Humanities/Fine Arts, and Social and Behavioral Sciences.

Specific Authority: 1001.64(2) & (4), F.S.

Law Implemented: 1004.03, 1007.24, 1007.25, 1004.65, 1004.68, 1009.23, 1009.25, 1009.26, 1001.64(10), 1007.263, F.S.; Rule 6A-14.030, F.A.C.

History: ...Filed – 5/19/09. Effective – Session I, 2009-10; 3/16/10. To Be Filed – 3/16/10. Proposed Date To Become Effective – 3/16/10.

**10-076.** The president sought approval of Curriculum Item IX-H.1. Mrs. Bilirakis moved approval. Mr. Gibbons seconded the motion. Mr. Gibbons voted aye; Mr. Johnston voted aye; Mr. Brett voted aye; Mr. Burke voted aye; and Mrs. Bilirakis voted aye. Motion carried.

Information regarding this item is as follows:

Board Material Relating to  
Agenda Item IX-H.1  
Meeting: March 16, 2010

**BOARD OF TRUSTEES  
ST. PETERSBURG COLLEGE**

**Credit Curriculum**

**Confirmation is sought to add the following courses effective Term II, 2009-2010, subject to Board of Trustees' approval:**

EGS 1001 INTRODUCTION TO ENGINEERING 3 credits  
Prerequisite: MAC 1105 or any MAC prefix. This is an introductory course with an overview of the engineering professions and the skills required to become a good engineer. The student is introduced to engineering work habits, responsibilities, engineering communication, engineering fundamentals, and problem solving techniques used across all engineering disciplines. 47 contact hours.

## MINUTES OF THE SPECIAL MEETING OF MARCH 16, 2010

### BOARD OF TRUSTEES OF ST. PETERSBURG COLLEGE

Confirmation is sought to change the following courses effective Term II, 2009-2010, subject to Board of Trustees' approval:

MAN 3930 SEMINARS IN BUSINESS AND MANAGEMENT 1 credit

Prerequisite: Admission to Banking BAS, International Business BAS, Management and Organizational Leadership BAS, Sustainability Management BAS, or Technology Management BAS. Admission to any BAS Program in the College of Technology and Management, or permission of the Dean. This course focuses on current and emerging issues in business and management. Its format and topics will vary but will typically be a full day or a half-day seminar conducted by one or more industry subject-matter experts who will address a specific business and management topic such as financial markets, international trade, human resources, cultural issues, or economic subjects, etc. The requirements of each student will vary with the topics in question. This course may be taken 3 times for a total of 3 credits using different seminar topics. 16 contact hours.

GLOBALIZATION: NEW CHALLENGES FOR TAMPA BAY AREA 1 credit

Prerequisite: Admission to Banking BAS, International Business BAS, Management and Organizational Leadership BAS, Sustainability Management BAS, or Technology Management BAS. Admission to any BAS Program in the College of Technology and Management, or permission of the Dean. This specific section of the Seminars in Business and Management course focuses on current and emerging globalization challenges confronting the local region. Its format and topics will include a half-day to one-day seminar by a practicing economic development professional or regulator, a pre-seminar activity involving the reading of relevant literature related to the subject globalization issues, and a post-seminar activity to reinforce the information, concepts, and issues presented at the seminar. 16 contact hours.

INTERNATIONAL STUDY ABROAD 1 credit

Prerequisite: Admission to Banking BAS, International Business BAS, Management and Organizational Leadership BAS, Sustainability Management BAS, or Technology Management BAS. Admission to any BAS Program in the College of Technology and Management, or permission of the Dean. The student may participate in a "study abroad trip" respective to their studies in ~~International Business, Technology Management or Banking~~. The nature and location of the trip will be approved by the College Dean and faculty. Typically a two week study abroad trip will explore various issues pertaining to international business (globalization), marketing, entrepreneurship, law or technology related to the country or location visited. The student may earn 1 credit for the seminar/study. 16 contact hours.

## MINUTES OF THE SPECIAL MEETING OF MARCH 16, 2010

### BOARD OF TRUSTEES OF ST. PETERSBURG COLLEGE

E-GOVERNANCE 1 credit

Prerequisite: Admission to Banking BAS, International Business BAS, Management and Organizational Leadership BAS, Sustainability Management BAS, or Technology Management BAS. Admission to any BAS program in the College of Technology and Management or permission of the Dean. This seminar focuses on the use of information and communications technology to create and transfer knowledge on electronic governance (e-governance) and electronic democracy (e-democracy) associated with the e-Governance Academy and the Government of Estonia. E-governance and e-democracy provides a mechanism for analyzing and systematizing international and domestic experiences allowing the creation of a knowledge base and experience model where the knowledge can be transferred to interested parties and government agencies. 16 contact hours.

ENTREPRENEURSHIP: FOCUSING ON INNOVATION 1 credit

Prerequisite: Admission to Banking BAS, International Business BAS, Management and Organizational Leadership BAS, Sustainability Management BAS, or Technology Management BAS. Admission to any BAS program in the College of Technology and Management or permission of the Dean. This seminar focuses on key elements of successful Entrepreneurship. Entrepreneurship concepts in the seminar may include issues such as new market venture ideas, financing options for a new business, how to get a new product to market, product branding, business leadership and innovation, defining business development and successfully using incubators in a new business. 16 contact hours.

IMPORTING AND EXPORTING OF TECHNOLOGY AND SECURITY 1 credit

Prerequisite: Admission to Banking BAS, International Business BAS, Management and Organizational Leadership BAS, Sustainability Management BAS, or Technology Management BAS. Admission to any BAS program in the College of Technology and Management or permission of the Dean. This seminar focuses on the emerging topics and considerations associated with import and export controls on high technology. Current legal requirements as governed by the Bureau of Industry and Security (BIS) and regulations under the Export Administration Act (EAA) will be examined. Emerging technology and exports to outlawed countries will be explored. 16 contact hours.

SUSTAINABILITY/GREEN MANAGEMENT CONCEPTS 1 credit

Prerequisite: Admission to Banking BAS, International Business BAS, Management and Organizational Leadership BAS, Sustainability Management BAS, or Technology Management BAS. Admission to any BAS Program in the College of Technology and Management, or permission of the Dean. This course focuses on current and emerging issues in business sustainability/green. Its format will vary but will typically include a ½ day to one day seminar by one or more industry experts. Depending on the seminar specific topic, the expert(s) will

## **MINUTES OF THE SPECIAL MEETING OF MARCH 16, 2010**

### **BOARD OF TRUSTEES OF ST. PETERSBURG COLLEGE**

address specific business and management topics pertaining to sustainable business planning, such as social and environmental challenges, marketing and supply chain decisions, recycling, reusing, reconditioning, product and service decisions in order to realize a natural competitive advantage within their operating strategies, international policies and regulations, and other key sustainability/green issues, as well as laws associated with this subject matter. 16 contact hours.

DOMESTIC TO GLOBAL 1 credit

Prerequisite: Admission to Banking BAS, International Business BAS, Management and Organizational Leadership BAS, Sustainability Management BAS, or Technology Management BAS. This will be a special topics conference focusing on issues surrounding expansion of domestic companies to multinational status, with a particular concentration on Dubai. This specific conference will address the issues from both Dubai's standpoint as well as the United States. The participants will be industry experts, government officials and academic representatives discussing the overall objectives of an expansion and the risk involved in the expansion. It may also include a focus on basic market research to determine an initial country fit as well as the knowledge necessary to determine whether the potential host country's government is stable and will support the expansion. Of primary importance may be a discussion regarding the main issues affecting expansion including the potential host country's economy, financial markets, risk analysis, business culture and legal system. The home country's laws and the "process for success" will also need to be addressed in order to properly evaluate the expansion. 16 contact hours.

#### **Approval is sought for the following courses to be added effective Term III, 2009-2010:**

- ACG 2940 ACCOUNTING INTERNSHIP 1-4 credits  
Prerequisite: Academic Department Coordinator/Chair Approval. This course is to be taken after the student has completed 9 credit hours in their major field of study. The purpose of this course is to allow students a "real world" experience with major-related, supervised, evaluated practical work experiences which may be paid or voluntary. Students are graded on the basis of documented learning acquired through hands-on experiences in an actual work setting. Variable credits are available, one to four per course. The student must fulfill the requirement of 60 on-the-job hours for each credit earned in addition to written assignments. This course may be repeated for a total of 4 credits.
- BRC 2940 FINANCIAL SERVICES INTERNSHIP 1-4 credits  
Prerequisite: Academic Department Coordinator/Chair Approval. This course is to be taken after the student has completed 9 credit hours in their major field of

## **MINUTES OF THE SPECIAL MEETING OF MARCH 16, 2010**

### **BOARD OF TRUSTEES OF ST. PETERSBURG COLLEGE**

study. The purpose of this course is to allow students a “real world” experience with major-related, supervised, evaluated practical work experiences which may be paid or voluntary. Students are graded on the basis of documented learning acquired through hands-on experiences in an actual work setting. Variable credits are available, one to four per course. The student must fulfill the requirement of 60 on-the-job hours for each credit earned in addition to written assignments. This course may be repeated for a total of 4 credits.

- CET 2940      NETWORKING ENGINEERING INTERNSHIP      1-4 credits  
Prerequisite: Academic Department Coordinator/Chair Approval. This course is to be taken after the student has completed 9 credit hours in their major field of study. The purpose of this course is to allow students a “real world” experience with major-related, supervised, evaluated practical work experiences which may be paid or voluntary. Students are graded on the basis of documented learning acquired through hands-on experiences in an actual work setting. Variable credits are available, one to four per course. The student must fulfill the requirement of 60 on-the-job hours for each credit earned in addition to written assignments. This course may be repeated for a total of 4 credits.
- CGS 2940      WEB DESIGN/MANAGEMENT INTERNSHIP      1-4 credits  
Prerequisite: Academic Department Coordinator/Chair Approval. This course is to be taken after the student has completed 9 credit hours in their major field of study. The purpose of this course is to allow students a “real world” experience with major-related, supervised, evaluated practical work experiences which may be paid or voluntary. Students are graded on the basis of documented learning acquired through hands-on experiences in an actual work setting. Variable credits are available, one to four per course. The student must fulfill the requirement of 60 on-the-job hours for each credit earned in addition to written assignments. This course may be repeated for a total of 4 credits.
- COP 2940      COMPUTER/WEB PROGRAMMING INTERNSHIP      1-4 credits  
Prerequisite: Academic Department Coordinator/Chair Approval. This course is to be taken after the student has completed 9 credit hours in their major field of study. The purpose of this course is to allow students a “real world” experience with major-related, supervised, evaluated practical work experiences which may be paid or voluntary. Students are graded on the basis of documented learning acquired through hands-on experiences in an actual work setting. Variable credits are available, one to four per course. The student must fulfill the requirement of 60 on-the-job hours for each credit earned in addition to written assignments. This course may be repeated for a total of 4 credits.



## **MINUTES OF THE SPECIAL MEETING OF MARCH 16, 2010**

### **BOARD OF TRUSTEES OF ST. PETERSBURG COLLEGE**

- CTS 2940      NETWORKING ADMINISTRATOR INTERNSHIP      1-4 credits  
Prerequisite: Academic Department Coordinator/Chair Approval. This course is to be taken after the student has completed 9 credit hours in their major field of study. The purpose of this course is to allow students a “real world” experience with major-related, supervised, evaluated practical work experiences which may be paid or voluntary. Students are graded on the basis of documented learning acquired through hands-on experiences in an actual work setting. Variable credits are available, one to four per course. The student must fulfill the requirement of 60 on-the-job hours for each credit earned in addition to written assignments. This course may be repeated for a total of 4 credits.
- GEB 2940      BUSINESS INTERNSHIP      1-4 credits  
Prerequisite: Academic Department Coordinator/Chair Approval. This course is to be taken after the student has completed 9 credit hours in their major field of study. The purpose of this course is to allow students a “real world” experience with major-related, supervised, evaluated practical work experiences which may be paid or voluntary. Students are graded on the basis of documented learning acquired through hands-on experiences in an actual work setting. Variable credits are available, one to four per course. The student must fulfill the requirement of 60 on-the-job hours for each credit earned in addition to written assignments. This course may be repeated for a total of 4 credits.
- MAN 2940      MANAGEMENT INTERNSHIP      1-4 credits  
Prerequisite: Academic Department Coordinator/Chair Approval. This course is to be taken after the student has completed 9 credit hours in their major field of study. The purpose of this course is to allow students a “real world” experience with major-related, supervised, evaluated practical work experiences which may be paid or voluntary. Students are graded on the basis of documented learning acquired through hands-on experiences in an actual work setting. Variable credits are available, one to four per course. The student must fulfill the requirement of 60 on-the-job hours for each credit earned in addition to written assignments. This course may be repeated for a total of 4 credits.
- MKA 2940      MARKETING INTERNSHIP      1-4 credits  
Prerequisite: Academic Department Coordinator/Chair Approval. This course is to be taken after the student has completed 9 credit hours in their major field of study. The purpose of this course is to allow students a “real world” experience with major-related, supervised, evaluated practical work experiences which may be paid or voluntary. Students are graded on the basis of documented learning

## **MINUTES OF THE SPECIAL MEETING OF MARCH 16, 2010**

### **BOARD OF TRUSTEES OF ST. PETERSBURG COLLEGE**

acquired through hands-on experiences in an actual work setting. Variable credits are available, one to four per course. The student must fulfill the requirement of 60 on-the-job hours for each credit earned in addition to written assignments. This course may be repeated for a total of 4 credits.

- RMI 2940      INSURANCE SERVICES INTERNSHIP      1-4 credits  
Prerequisite: Academic Department Coordinator/Chair Approval. This course is to be taken after the student has completed 9 credit hours in their major field of study. The purpose of this course is to allow students a “real world” experience with major-related, supervised, evaluated practical work experiences which may be paid or voluntary. Students are graded on the basis of documented learning acquired through hands-on experiences in an actual work setting. Variable credits are available, one to four per course. The student must fulfill the requirement of 60 on-the-job hours for each credit earned in addition to written assignments. This course may be repeated for a total of 4 credits.

#### **Approval is sought for the following courses to be changed effective Term III, 2009-2010:**

- NUR 3066C      HEALTH ASSESSMENT AND PHYSICAL APPRAISAL      4 credits  
Prerequisites: Admission to the Nursing BS program, NUR 3125, NUR 3805. This course focuses on client assessment, health risks and formation of nursing diagnoses and health teaching. Emphasis is on the process of client interaction and use of appraisal skills in the collection of bio-psychosocial data across the life span. Application of pathophysiological concepts is required. 75 contact hours.
- NUR 4636      COMMUNITY HEALTH NURSING THEORY      3 credits  
Prerequisite: Admission to the Nursing BS program, NUR 3805. Corequisite: NUR 4636L. This course focuses on the holistic nursing role in the community. Emphasis is on concepts and theories related to community health nursing. Special attention is given to the community as client with emphasis on health promotion/disease prevention and teaching of groups in community settings. 45 contact hours.
- NUR 4636L      COMMUNITY HEALTH NURSING PRACTICUM      4 credits  
Prerequisite: Admission to the Nursing BS program, NUR 3805, NUR 3066C and corequisite: NUR 4636. This course offers opportunities to practice the principles and theory of community health nursing in a variety of health care settings. Included are the identification of health care needs of the community as a client, and the nurse’s role as a facilitator, teacher, and evaluator in promoting and maintaining health and wellness. 60 contact hours.

## **MINUTES OF THE SPECIAL MEETING OF MARCH 16, 2010**

### **BOARD OF TRUSTEES OF ST. PETERSBURG COLLEGE**

- NUR 4835 LEADERSHIP THEORY 3 credits  
Prerequisite: NUR 3805 and admission to the Nursing BS program; corequisite: NUR 4835L. This course includes a focus on theories, concepts, and principles of leading and managing as well as pertinent legal issues faced by nursing leaders and managers. Emphasis will be on the methods to become an effective leader/manager including interpersonal skills needed for effective leadership and management, the different types of organizations delivering health care, outcomes management, and analysis of current research findings. 45 contact hours.
- NUR 4835L LEADERSHIP PRACTICUM 4 credits  
Prerequisite: Admission to the program, NUR 3145, NUR 3655, ~~NUR 3826~~, NUR 4165, NUR 4606, NUR 4636, NUR 4636L. Co or prerequisite: NUR 4835, NUR 3826. This course focuses on the application of the theories, concepts, and principles of leading and managing. Emphasis in the course will be on the development of skills needed for effective leadership and management. Opportunities will be provided to demonstrate appropriate leadership and management ability. 60 contact hours.

#### **Approval is sought for the following courses to be deleted effective Term III, 2009-2010:**

- ACG 2949 Co-op Work Experience Accounting  
BRC 2949 Co-op Work Experience Financial Services  
COP 2949 Co-op Work Experience Computer Programming  
GEB 2949 Co-op Work Experience Business  
MAN 2949 Co-op Work Experience Management  
MKA 2949 Co-op Work Experience Marketing

#### **Approval is sought for the following programs to be changed effective Term III, 2009-2010:**

##### AS Degrees:

- Business Administration (BUS-AS) – See attached  
Computer Networking (COMPNET-AS) – See attached  
Computer/Web Programming and Analysis (CWPA-AS) – See attached  
Financial Services/Banking (FINSV-AS) – See attached  
Insurance Services (INSVS-AS) – See attached  
Web Site Design and Management (WEBSDM-AS) – See attached

##### AAS Degrees:

- Business Administration and Management – See Attached

**MINUTES OF THE SPECIAL MEETING OF MARCH 16, 2010**

**BOARD OF TRUSTEES OF ST. PETERSBURG COLLEGE**

Management Option (MGMT-AAS)  
Marketing Option (MKT-AAS)  
Industrial Management Technology (INMG-AAS) – See attached

CT Programs:

Business Administration (BUSADM-CT) – See attached  
Computer Web Planning Specialist (CWPS-CT) – See attached

**Approval is sought for the following programs to be changed effective Term I, 2010-2011:**

AS Degrees:

Human Services – See attached  
Social Services (HSDIS-AS)  
Alcohol/Substance Abuse (HSM-AS)

The following regarding Flexible Access and Delivery is being supplied to the Board as **information only**. These are classes such as telecourses, courses delivered through the Internet, and “blended” courses which include multiple delivery and media. The courses are defined as those that include substantial components of distance and/or asynchronous learning as a substitute for, rather than as a complement to, traditional delivery where students and faculty are in the same place at the same time. These courses match the same high standards as any course offered at St. Petersburg College and have been approved by the Flexible Access Review Committee. Those currently being taught are:

ATE 4000	Veterinary PreCapstone
CAP 2134	Database Security
CET 2691	Laws and Legal Aspects of Information Technology Security
CGS 2811	Incident Response and Disaster Recovery
CIS 2352	Ethical Hacking
CJE 1669	Identity Theft Investigations
CTS 1314	Network Defense and Countermeasures
EEC 2271	Introduction to Working with Young Children with Special Needs
HSA 3170	Health Care Finance
REE 3043	Real Estate Business Fundamentals
RMI 1112	Fundamentals of Insurance Planning

Thomas E. Furlong, Jr., President and Tonjua Williams, Vice President for Academic and Student Affairs recommend approval.

slc 0211101

**PROGRAM CHANGE – AS DEGREE**

**MINUTES OF THE SPECIAL MEETING OF MARCH 16, 2010**

**BOARD OF TRUSTEES OF ST. PETERSBURG COLLEGE**

**BUSINESS ADMINISTRATION  
(BUS-AS)**

**ASSOCIATE IN SCIENCE DEGREE**

<http://www.spcollege.edu/program/BUS-AS>

**Dr. Sharon Setterlind, Dean, SP/G (727) 341-4724 or Dr. Holly Hoopes, Academic Chair, CL (727) 791-2530 or Nancy Russell, Academic Coordinator, SP/G (727) 341-4724**

(Subplan A is transferable to a Bachelor's Degree in Business, General at UCF and USF or Business Administration & Management at FAMU, FAU, FGCU, FIU, FSU, UF, UNF, UWF)

(Subplans B and C are transferable to a Bachelor's Degree in Business Administration, Banking, International Business or Management and Organizational Leadership at SPC)

**COURSES IN THE PROGRAM ARE OFFERED IN ALL MODALITIES (FACE-TO-FACE, BLENDED, ONLINE) AND IN 8, 10 AND 16 WEEK FORMATS.**

**\*\*\*\*GENERAL EDUCATION COURSES (24 CREDITS)**

ENC	1101	Composition I or (Honors)	3
ENC	1102	Composition II or (Honors)	3
Humanities/Fine Arts Approved Course ****			3
SPC	1017	Introduction to Speech Communication or (Honors)	3
MAC	1105	College Algebra	3
MAC	2233	Applied Calculus I	3
ECO	2013	Principles of Macroeconomics or (Honors)	3
ECO	2023	Principles of Microeconomics or (Honors)	3
Computer/Information Literacy Competency Requirement			

**CORE AND SUPPORT COURSES (40 CREDITS) SUGGESTED SEQUENCING IS AS FOLLOWS:**

**SUBPLAN A: BUSINESS ADMINISTRATION (BUS) (40 credits)**

**YEAR 1 TERM I (9 credits)**

CGS	1100	<sup>a</sup> Microcomputer Applications	3
MAN	2021	Principles of Management	3
GEB	1011	Introduction to Business	3

**YEAR 1 TERM II (9 credits)**

ACG	2021	Financial Accounting	3
ACG	2071	Managerial Accounting	3
MAR	2011	Principles of Marketing	3

**YEAR 1 TERM III (6 credits)**

OST	2335	Professional Communication Skills	3
PHI	1631	Studies in Professional Ethics <b>OR</b> (PHI 1600, 1602H, 2635, or 2649)	3

**YEAR 2 TERM I (9 credits)**

STA	2023	Elementary Statistics or (Honors)	3
BUL	2241	Business Law I	3
MAN	2582	Introduction to Project Management	3

**YEAR 2 TERM II (7 credits)**

FIN	2000	Principles of Finance	3
MAN	2940	Internship <b>OR</b>	4
GEB	2940	Internship	(4)
MAN	2949	Co-Op Work Experience	(4)

**OR**

**SUBPLAN B: INTERNATIONAL BUSINESS (INTBUS) (40 credits)**

**YEAR 1 TERM I (9 credits)**

CGS	1100	<sup>a</sup> Microcomputer Applications	3
-----	------	---	---

## MINUTES OF THE SPECIAL MEETING OF MARCH 16, 2010

### BOARD OF TRUSTEES OF ST. PETERSBURG COLLEGE

MAN	2021	Principles of Management	3
GEB	1011	Introduction to Business	3

#### **YEAR 1 TERM II (9 credits)**

ACG	2021	Financial Accounting	3
ACG	2071	Managerial Accounting	3
GEB	2350	Survey of International Business	3

#### **YEAR 1 TERM III (6 credits)**

MAN	2604	Intercultural Relations in Business	3
PHI	1631	Studies in Professional Ethics <b>OR</b> (PHI 1600, 1602H, 2635, or 2649)	3

#### **YEAR 2 TERM I (9 credits)**

STA	2023	Elementary Statistics or (Honors)	3
BUL	2241	Business Law I	3
MAN	2582	Introduction to Project Management	3

#### **YEAR 2 TERM II (7 credits)**

MAR	1142	Global Marketing	3
MAN	2940	Internship <del>OR</del>	4
MAN	2949	Co-Op Work Experience	(4)

#### **OR**

#### **SUBPLAN C: ACCOUNTING (ACCTG) (40 credits)**

#### **YEAR 1 TERM I (9 credits)**

CGS	1100	<sup>a</sup> Microcomputer Applications	3
CGS	1515	Spreadsheet Techniques and Programming	3
GEB	1011	Introduction to Business	3

#### **YEAR 1 TERM II (9 credits)**

ACG	2021	Financial Accounting	3
MAN	2021	Principles of Management	3
STA	2023	Elementary Statistics or (Honors)	3

#### **YEAR 1 TERM III (6 credits)**

OST	2335	Professional Communication Skills	3
PHI	1631	Studies in Professional Ethics <b>OR</b> (PHI 1600, 1602H, 2635, or 2649)	3

#### **YEAR 2 TERM I (9 credits)**

ACG	2071	Managerial Accounting	3
BUL	2241	Business Law I	3
FIN	2000	Principles of Finance	3

#### **YEAR 2 TERM II (7 credits)**

ACG	2450	Microcomputer Accounting	3
ACG	2940	Internship <del>OR</del>	4
ACG	2949	Co-Op Work Experience	(4)

#### **TOTAL PROGRAM HOURS**

**64**

<sup>a</sup> Will apply towards General Education Requirements

\*\*\*\* To provide students with an enhanced world view in light of an increasingly globalized economy, students must include at least one of the following courses as part of the general education requirements for the Associate in Science degree:

LIT	2110	World Literature I
LIT	2110H	Honors World Literature I
LIT	2120	World Literature II
LIT	2120H	Honors World Literature II
HUM	2270	Humanities (East-West Synthesis)
HUM	2270H	Honors Humanities (East-West Synthesis)
REL	2300	World Religions
INR	2002	International Relations

# MINUTES OF THE SPECIAL MEETING OF MARCH 16, 2010

## BOARD OF TRUSTEES OF ST. PETERSBURG COLLEGE

INR 2002H Honors International Relations  
WOH 2040 The Twentieth Century  
WOH 2040H Honors The Twentieth Century

### PROGRAM CHANGE – AS DEGREE

## COMPUTER NETWORKING (COMPNET-AS)

### ASSOCIATE IN SCIENCE DEGREE

<http://www.spcollege.edu/program/COMPNET-AS>

(Transferable to College of Technology & Management Bachelor's programs at SPC.)

Dr. Sharon Setterlind, Dean, SP/G (727) 341-4724 or Dr. Holly Hoopes, Academic Chair, CL (727) 791-2530

**COURSES IN THE PROGRAM ARE OFFERED IN ALL MODALITIES (FACE-TO-FACE, BLENDED, ONLINE)  
AND IN 8, 10 AND 16 WEEK FORMATS.**

#### **\*\*\*\*GENERAL EDUCATION COURSES (18 credits)**

ENC	1101	Composition I or (Honors)	3
SPC	1017	Introduction to Speech Communication <b>OR</b> (SPC 1017H, 1065, 1608, or 1608H)	3
Humanities/Fine Arts Approved Course ****			3
Mathematics One college-level course with MAC, MAP, MAS, MGF, MTG or STA prefix			3
Social and Behavioral Sciences Approved Course ****			3
PHI	1631	Studies in Professional Ethics <b>OR</b> (PHI 1600, 1602H, 2635 or 2649)	3
Computer/Information Literacy Competency Requirement			

#### **CORE AND SUPPORT COURSES (45 CREDITS) SUGGESTED SEQUENCING IS AS FOLLOWS:**

##### **SUBPLAN A: NETWORKING ADMINISTRATOR TRACK (NETADM) (45 credits)**

###### **YEAR 1 TERM I (9 credits)**

CNT	1000	Local Area Network Concepts	3
CTS	1327	Installing and Configuring Microsoft Windows Client	3
CTS	1328	Planning and Administering Windows	3

###### **YEAR 1 TERM II (12 credits)**

CTS	2106	Fundamentals of the Linux/Unix Operating Environment	3
CTS	1334	Configuring and Troubleshooting a Windows Server Network Infrastructure	3
CET	1171C	Computer Repair Essentials	3
CTS	1303	Configuring and Troubleshooting Windows Server Active Directory Domain Services	3

###### **YEAR 1 TERM III (6 credits)**

ACG	2021	Financial Accounting	3
Elective		See List Below	3

###### **YEAR 2 TERM I (9 credits)**

CGS	1000	Introduction to Computers and Programming	3
GEB	1011	Introduction to Business	3
CTS	2321	Linux System Administration I	3

###### **YEAR 2 TERM II (9 credits)**

CTS	2322	Linux System Administration II	3
MAN	2582	Introduction to Project Management	3
Elective		See List Below	3

###### **ELECTIVES (6 credits)**

ACG	2071	<sup>a</sup> Managerial Accounting <b>OR</b>	3
FIN	2000	Principles of Finance <b>(1 or the other)</b>	(3)
BUL	2241	<sup>b</sup> Business Law I	3
CET	1172C	Computer Support Technician	3

## MINUTES OF THE SPECIAL MEETING OF MARCH 16, 2010

### BOARD OF TRUSTEES OF ST. PETERSBURG COLLEGE

CGS	1100	<sup>c</sup> Microcomputer Applications	3
CIS	2321	Systems Analysis and Design	3
MAN	2340	Human Factors in Supervision	3
CTS	2940	Internship	3
CTS	2949	Co-op Work Experience	3

OR

#### **SUBPLAN B: NETWORKING ENGINEERING TRACK (NETEN) (45 credits)**

##### **YEAR 1 TERM I (9 credits)**

CET	1600	Network Fundamentals	3
CET	1610	Routing Protocols and Concepts	3
ACG	2021	Financial Accounting	3

##### **YEAR 1 TERM II (9 credits)**

CET	2615	LAN Switching and Wireless	3
CET	2620	Accessing the WAN	3
CET	1171C	Computer Repair Essentials	3

##### **YEAR 1 TERM III (6 credits)**

CET	2670	Scalable Routing Protocols and IPv6	3
CGS	1000	Introduction to Computers and Programming	3

##### **YEAR 2 TERM I (12 credits)**

CET	2856	Enterprise Switching and Wireless Networking	3
CET	2685	Implementing Secure Converged WANs	3
CET	2682	Fundamentals of Voice Over IP (VoIP)	3
Elective		See List Below	3

##### **YEAR 2 TERM II (9 credits)**

GEB	1011	Introduction to Business	3
MAN	2582	Introduction to Project Management	3
Elective		See List Below	3

##### **ELECTIVES (6 credits)**

ACG	2071	<sup>a</sup> Managerial Accounting	3
FIN	2000	Principles of Finance (1 or the other)	(3)
BUL	2241	<sup>b</sup> Business Law I	3
CET	1172C	Computer Support Technician	3
CGS	1100	<sup>c</sup> Microcomputer Applications	3
CIS	2321	Systems Analysis and Design	3
MAN	2340	Human Factors in Supervision	3
CET	2940	Internship	3
CET	2949	Co-op Work Experience	3

#### **TOTAL PROGRAM HOURS**

**63**

<sup>a</sup> Students transferring to a four-year institution must take ACG 2071.

<sup>b</sup> Required for BAS transfer.

<sup>c</sup> Satisfies the general education computer literacy requirement.

\*\*\*\* To provide students with an enhanced world view in light of an increasingly globalized economy, students must include at least one of the following courses as part of the general education requirements for the Associate in Science degree:

LIT	2110	World Literature I
LIT	2110H	Honors World Literature I
LIT	2120	World Literature II
LIT	2120H	Honors World Literature II
HUM	2270	Humanities (East-West Synthesis)
HUM	2270H	Honors Humanities (East-West Synthesis)
REL	2300	World Religions
INR	2002	International Relations
INR	2002H	Honors International Relations



# MINUTES OF THE SPECIAL MEETING OF MARCH 16, 2010

## BOARD OF TRUSTEES OF ST. PETERSBURG COLLEGE

WOH 2040 The Twentieth Century  
WOH 2040H Honors The Twentieth Century

### PROGRAM CHANGE – AS DEGREE

## COMPUTER/WEB PROGRAMMING AND ANALYSIS (CWPA-AS)

### ASSOCIATE IN SCIENCE DEGREE

<http://www.spcollege.edu/program/CWPA-AS>

(Transferable to College of Technology & Management Bachelor's programs at SPC)

Dr. Sharon Setterlind, Dean, SP/G (727) 341-4724 or Dr. Holly Hoopes, Academic Chair, CL (727) 791-2530 or Nancy Russell, Academic Coordinator, SP/G (727) 341-4724

COURSES IN THE PROGRAM ARE OFFERED IN ALL MODALITIES (FACE-TO-FACE, BLENDED, ONLINE)  
AND IN 8, 10 AND 16 WEEK FORMATS.

#### **\*\*\*\*GENERAL EDUCATION REQUIREMENTS (18 credits)**

ENC 1101	Composition I or (Honors)	3
SPC 1065	Business and Professional Speaking <b>OR</b> (SPC 1017, 1017H, 1608 or 1608H)	3
Humanities/Fine Arts Approved Course ****		3
Mathematics	One college-level course with an MAC, MAP, MAS, MGF, MTG or STA prefix	3
Social and Behavioral Sciences Approved Course ****		3
PHI 1631	Studies in Professional Ethics <b>OR</b> (PHI 1600, 1602H, 2635 or 2649)	3
Computer/Information Literacy Competency Requirement		

#### **CORE AND SUPPORT COURSES (45 CREDITS) SUGGESTED SEQUENCING IS AS FOLLOWS:**

##### **YEAR 1 TERM I (12 credits)**

COP 1822	Introduction to Web Page Creation (Topic: HTML)	1
CGS 1822	Web Site Essentials	2
COP 2823	Advanced Web Page Creation	3
CGS 1000	Introduction to Computers and Programming	3
CGS 1100	<sup>a</sup> Microcomputer Applications	3

##### **YEAR 1 TERM II (12 credits)**

CNT 1000	Local Area Network Concepts	3
ACG 2021	Financial Accounting <b>OR</b>	3
CTS 1120	Introduction to Network Security Foundations <b>OR</b>	(3)
MAN 2582	Introduction to Project Management	(3)
CGS 1545	Database Techniques and Programming	3
Programming Language – See List Below		3

##### **YEAR 1 TERM III (6 credits)**

CIS 2321	System Analysis and Design	3
Programming Language – See List Below		3

##### **YEAR 2 TERM I (6 credits)**

Programming Language – See List Below		3
Programming Language – See List Below		3

##### **YEAR 2 TERM II (9 credits)**

COP 2940	Internship <del>OR</del>	<del>3</del>
COP 2940	Co-op Work Experience	(3)
Programming Language – See List Below		3
Programming Language – See List Below		3

##### **PROGRAMMING LANGUAGE (18 credits)**

CGS 1178	Web Scripting with CGI/PERL and JavaScript	3
----------	--	---

## MINUTES OF THE SPECIAL MEETING OF MARCH 16, 2010

### BOARD OF TRUSTEES OF ST. PETERSBURG COLLEGE

CGS	2402	Programming in C++ for Business	3
COP	1842	Developing Web Sites with PHP/MySQL	3
COP	2360	Introduction to C# Programming	3
COP	2362	Advanced Programming with C#	3
COP	2250	Java Programming I	3
COP	2800	Java Programming II	3
COP	2801	JavaScript	3
COP	2806	Java Server Pages and Servlets	3
COP	2837	Visual Basic.Net Programming I	3
COP	2838	Visual Basic.Net Programming II	3
COP	2839	ASP.NET Programming with VB.NET	3
COP	2843	Advanced PHP/MySQL	3

### **TOTAL PROGRAM HOURS**

**63**

<sup>a</sup> Satisfies the general education computer literacy requirement.

\*\*\*\*To provide students with an enhanced world view in light of an increasingly globalized economy, students must include at least one of the following courses as part of the general education requirements for the Associate in Science degree:

LIT	2110	World Literature I
LIT	2110H	Honors World Literature I
LIT	2120	World Literature II
LIT	2120H	Honors World Literature II
HUM	2270	Humanities (East-West Synthesis)
HUM	2270H	Honors Humanities (East-West Synthesis)
REL	2300	World Religions
INR	2002	International Relations
INR	2002H	Honors International Relations
WOH	2040	The Twentieth Century
WOH	2040H	Honors The Twentieth Century

### **PROGRAM CHANGE – AS DEGREE**

### **FINANCIAL SERVICES-BANKING (FINSV-AS)**

#### **ASSOCIATE IN SCIENCE DEGREE**

<http://www.spcollege.edu/program/FINSV-AS>

**(Transferable to Bachelor's Degree in Banking, Business Administration, International Business, and Management and Organizational Leadership at SPC)**

**Dr. Sharon Setterlind, Dean, SP/G (727) 341-4724 or**

**Nancy Russell, Academic Coordinator, SP/G (727) 341-4620**

**COURSES IN THE PROGRAM ARE OFFERED IN ALL MODALITIES (FACE-TO-FACE, BLENDED, ONLINE)  
AND IN 8, 10 AND 16 WEEK FORMATS.**

#### **\*\*\*\*GENERAL EDUCATION COURSES (21 credits)**

ENC	1101	Composition I or (Honors)	3
ENC	1102	Composition II <b>OR</b> (any approved Literature course)	3
SPC	1017	Introduction to Speech Communication <b>OR</b> (SPC 1065, 1017H, 1608 or 1608H)	3
Humanities/Fine Arts Approved Course ****			3
MAC	1105	<sup>a</sup> College Algebra	3
ECO	2013	<sup>a</sup> Principles of Macroeconomics or (Honors)	3
PHI	1631	Studies in Professional Ethics <b>OR</b> (PHI 1600, 1602H, 2635 or 2649)	3
Computer/Information Literacy Competency Requirement			

## MINUTES OF THE SPECIAL MEETING OF MARCH 16, 2010

### BOARD OF TRUSTEES OF ST. PETERSBURG COLLEGE

#### CORE AND SUPPORT COURSES (43 CREDITS) SUGGESTED SEQUENCING IS AS FOLLOWS:

##### YEAR 1 TERM I (9 credits)

ACG	2021	<sup>a</sup> Financial Accounting	3
ACG	2071	<sup>a</sup> Managerial Accounting	3
CGS	1100	<sup>a, b</sup> Microcomputer Applications	3

##### YEAR 1 TERM II (12 credits)

ECO	2023	<sup>a</sup> Principles of Microeconomics or (Honors)	3
MAC	2233	<sup>a</sup> Applied Calculus I	3
BRC	2001	Principles of Financial Services Banking	3
MKA	2021	Sales	3

##### YEAR 1 TERM III (3 credits)

STA	2023	<sup>a</sup> Elementary Statistics or (Honors)	3
-----	------	--	---

##### YEAR 2 TERM I (12 credits)

BRC	2062	Introduction to Financial Markets and Money	3
BUL	2241	Business Law I	3
MAN	2021	Principles of Management	3
FIN	2000	Principles of Finance	3

##### YEAR 2 TERM II (7 credits)

OST	2335	Professional Communication Skills	3
BRC	2940	Internship <b>OR</b>	4
BRC	2940	Co-Op Work Experience	(4)

**TOTAL PROGRAM HOURS** **64**

<sup>a</sup> This course is a prerequisite for admission to the BS or BAS program.

<sup>b</sup> Satisfies general education requirement.

\*\*\*\* To provide students with an enhanced world view in light of an increasingly globalized economy, students must include at least one of the following courses as part of the general education requirements for the Associate in Science degree:

LIT	2110	World Literature I
LIT	2110H	Honors World Literature I
LIT	2120	World Literature II
LIT	2120H	Honors World Literature II
HUM	2270	Humanities (East-West Synthesis)
HUM	2270H	Honors Humanities (East-West Synthesis)
REL	2300	World Religions
INR	2002	International Relations
INR	2002H	Honors International Relations
WOH	2040	The Twentieth Century
WOH	2040H	Honors The Twentieth Century

### **PROGRAM CHANGE – AS DEGREE**

### **INSURANCE SERVICES (INSVS-AS)**

**ASSOCIATE IN SCIENCE DEGREE**

<http://www.spcollege.edu/program/INSVS-AS>

# MINUTES OF THE SPECIAL MEETING OF MARCH 16, 2010

## BOARD OF TRUSTEES OF ST. PETERSBURG COLLEGE

(Transferable to Bachelor's Degree in Banking, Business Administration, International Business, and Management and Organizational Leadership at SPC)

Dr. Sharon Setterlind, Dean, SP/G (727) 341-4724 or

Nancy Russell, Academic Coordinator, SP/G (727) 341-4620

**COURSES IN THE PROGRAM ARE OFFERED IN ALL MODALITIES (FACE-TO-FACE, BLENDED, ONLINE) AND IN 8, 10 AND 16 WEEK FORMATS.**

### **\*\*\*\*GENERAL EDUCATION COURSES (21 credits)**

ENC	1101	Composition I or (Honors)	3
ENC	1102	Composition II <b>OR</b> (any approved Literature course)	3
SPC	1017	Introduction to Speech Communication <b>OR</b> (SPC 1065, 1017H, 1608 or 1608H)	3
Humanities/Fine Arts Approved Course****			3
MAC	1105	<sup>a</sup> College Algebra	3
ECO	2013	<sup>a</sup> Principles of Macroeconomics or (Honors)	3
PHI	1631	Studies in Professional Ethics <b>OR</b> (PHI 1600, 1602H, 2635 or 2649)	3
Computer/Information Literacy Competency Requirement			

### **CORE AND SUPPORT COURSES (43 CREDITS) SUGGESTED SEQUENCING IS AS FOLLOWS:**

#### **YEAR 1 TERM I (9 credits)**

ACG	2021	<sup>a</sup> Financial Accounting	3
ACG	2071	<sup>a</sup> Managerial Accounting	3
CGS	1100	<sup>a, b</sup> Microcomputer Applications	3

#### **YEAR 1 TERM II (12 credits)**

ECO	2023	<sup>a</sup> Principles of Microeconomics or (Honors)	3
MAC	2233	<sup>a</sup> Applied Calculus I	3
RMI	1112	Fundamentals of Insurance Planning	3
MKA	2021	Sales	3

#### **YEAR 1 TERM III (3 credits)**

STA	2023	<sup>a</sup> Elementary Statistics or (Honors)	3
-----	------	--	---

#### **YEAR 2 TERM I (12 credits)**

RMI	1200	* Principles of Property and Liability Insurance	3
BUL	2241	Business Law I	3
RMI	2117	* Personal Insurance	3
GEB	1011	Introduction to Business	3

#### **YEAR 2 TERM II (7 credits)**

RMI	2211	* Commercial Insurance	3
RMI	2940	Internship <b>OR</b>	4
RMI	2949	Co-Op Work Experience	(4)

**TOTAL PROGRAM HOURS 64**

\* Not submitted to C&I

<sup>a</sup> This course is a prerequisite for admission to the BAS program.

<sup>b</sup> Satisfies the general education requirement.

\*\*\*\* To provide students with an enhanced world view in light of an increasingly globalized economy, students must include at least one of the following courses as part of the general education requirements for the Associate in Science degree:

LIT	2110	World Literature I
LIT	2110H	Honors World Literature I
LIT	2120	World Literature II
LIT	2120H	Honors World Literature II
HUM	2270	Humanities (East-West Synthesis)
HUM	2270H	Honors Humanities (East-West Synthesis)

# MINUTES OF THE SPECIAL MEETING OF MARCH 16, 2010

## BOARD OF TRUSTEES OF ST. PETERSBURG COLLEGE

REL	2300	World Religions
INR	2002	International Relations
INR	2002H	Honors International Relations
WOH	2040	The Twentieth Century
WOH	2040H	Honors The Twentieth Century

### PROGRAM CHANGE – AS DEGREE

## WEB SITE DESIGN & MANAGEMENT (WEBSDM-AS)

### ASSOCIATE IN SCIENCE DEGREE

<http://www.spcollege.edu/program/WEBSDM-AS>

(Transferable to Technology Management BAS program at SPC)

Dr. Sharon Setterlind, Dean, SP/G (727) 341-4724 or Roberto Fernandez, Academic Chair, TS (727) 712-5770

**COURSES IN THE PROGRAM ARE OFFERED IN ALL MODALITIES (FACE-TO-FACE, BLENDED, ONLINE)  
AND IN 8, 10 AND 16 WEEK FORMATS.**

#### **\*\*\*\*GENERAL EDUCATION COURSES (18 credits)**

ENC	1101	Composition I or (Honors)	3
SPC	1065	Business and Professional Speaking <b>OR</b> (SPC 1017, 1017H, 1608 or 1608H)	3
Humanities/Fine Arts Approved Course ****			3
Mathematics	One college-level course with an MAC, MAP, MAS, MGF, MTG or STA prefix		3
Social and Behavioral Sciences Approved Course ****			3
PHI	1631	Studies in Professional Ethics <b>OR</b> (PHI 1600, 1602H, 2635 or 2649)	3
Computer/Information Literacy Competency Requirement			

#### **CORE AND SUPPORT COURSES (45 CREDITS) SUGGESTED SEQUENCING IS AS FOLLOWS:**

##### **SUBPLAN A: WEB SITE DESIGN (WSD) (45 credits)**

###### **YEAR 1 TERM I (9 credits)**

COP	1822	Introduction to Web Page Creation (Topic: HTML)	1
CGS	1822	Web Site Essentials	2
CGS	1100	<sup>a</sup> Microcomputer Applications	3
COP	2823	Advanced Web Page Creation	3

###### **YEAR 1 TERM II (12 credits)**

COP	1826	Web Graphics Design I	3
CGS	1000	Introduction to Computers and Programming	3
COP	1827	Web Graphics Design II	3
GEB	1011	Introduction to Business <b>OR</b>	3
CTS	1120	Introduction to Network Security Foundations <b>OR</b>	(3)
ACG	2021	Financial Accounting	(3)

###### **YEAR 1 TERM III (3 credits)**

COP	2801	JavaScript	3
-----	------	------------	---

###### **YEAR 2 TERM I (12 credits)**

Elective	See List Below		3
Elective	See List Below		3
CIS	2321	System Analysis and Design	3
CGS	1545	Database Techniques and Programming	3

###### **YEAR 2 TERM II (9 credits)**

CNT	1000	Local Area Network Concepts	3
-----	------	-----------------------------	---

## MINUTES OF THE SPECIAL MEETING OF MARCH 16, 2010

### BOARD OF TRUSTEES OF ST. PETERSBURG COLLEGE

CGS	2823	Advanced Website Development	3
CGS	2940	Internship <del>OR</del>	<u>3</u>
CGS	2949	Co-Op Work Experience	<del>(3)</del>

#### ELECTIVES (6 Credits)

CGS	1178	Web Scripting with CGI/PERL and Java Script	(3)
CGS	1874	Introduction to Flash	(3)
CGS	2402	Programming in C++ for Business	(3)
CGS	2XXX	* <b>Flash/Action Scripting</b>	<b>(3)</b>
COP	2250	Java Programming I	(3)
COP	2837	Visual Basic.Net Programming I	(3)

OR

#### SUBPLAN B: WEB SITE MANAGEMENT (WSM) (45 credits)

##### YEAR 1 TERM I (9 credits)

COP	1822	Introduction to Web Page Creation (Topic: HTML)	1
CGS	1822	Web Site Essentials	2
CGS	1100	<sup>a</sup> Microcomputer Applications	3
COP	2823	Advanced Web Page Creation	3

##### YEAR 1 TERM II (12 credits)

CGS	1172	E-Commerce Site Designer I	3
CGS	2173	E-Commerce Site Designer II	3
CGS	1000	Introduction to Computers and Programming	3
GEB	1011	Introduction to Business <b>OR</b>	3
CTS	1120	Introduction to Network Security Foundations <b>OR</b>	(3)
ACG	2021	Financial Accounting	(3)

##### YEAR 1 TERM III (3 credits)

CGS	1846	Web Site Marketing and Usability	3
-----	------	----------------------------------	---

##### YEAR 2 TERM I (12 credits)

CGS	2ZZZ	* <b>Introduction to Content Management Systems</b>	<b>3</b>
MAN	2582	Introduction to Project Management	3
CGS	1545	Database Techniques and Programming	3
CNT	1000	Local Area Network Concepts	3

##### YEAR 2 TERM II (9 credits)

CIS	2321	System Analysis and Design	3
CGS	2823	Advanced Web Site Development	3
CGS	2940	Internship <del>OR</del>	<u>3</u>
CGS	2949	Co-Op Work Experience	<del>(3)</del>

#### **TOTAL PROGRAM HOURS**

**63**

\* **Not submitted to C&I**

<sup>a</sup> Satisfies general education computer literacy requirement.

\*\*\*\* To provide students with an enhanced world view in light of an increasingly globalized economy, students must include at least one of the following courses as part of the general education requirements for the Associate in Science degree:

LIT	2110	World Literature I
LIT	2110H	Honors World Literature I
LIT	2120	World Literature II
LIT	2120H	Honors World Literature II
HUM	2270	Humanities (East-West Synthesis)
HUM	2270H	Honors Humanities (East-West Synthesis)
REL	2300	World Religions
INR	2002	International Relations
INR	2002H	Honors International Relations
WOH	2040	The Twentieth Century

**MINUTES OF THE SPECIAL MEETING OF MARCH 16, 2010**

**BOARD OF TRUSTEES OF ST. PETERSBURG COLLEGE**

WOH 2040H Honors The Twentieth Century

**PROGRAM CHANGE – AAS DEGREE**

**BUSINESS ADMINISTRATION AND MANAGEMENT**  
**MANAGEMENT OPTION (MGMT-AAS) OR**  
**MARKETING OPTION (MKT-AAS)**

**ASSOCIATE IN APPLIED SCIENCE DEGREE**

<http://www.spcollege.edu/program/MGMT-AAS>

<http://www.spcollege.edu/program/MKT-AAS>

**Dr. Sharon Setterlind, Dean, SP/G (727) 341-4724 or Dr. Holly Hoopes, Academic Chair, CL (727) 791-2530 or Nancy Russell, Academic Coordinator, SP/G (727) 341-4724**

**COURSES IN THE PROGRAM ARE OFFERED IN ALL MODALITIES (FACE-TO-FACE, BLENDED, ONLINE) AND IN 8, 10 AND 16 WEEK FORMATS.**

**\*\*\*\*GENERAL EDUCATION REQUIREMENTS (24 credits)**

ENC	1101	Composition I or (Honors)	3
ENC	1102	Composition II or (Honors)	3
SPC	1065	Business and Professional Speaking <b>OR</b> (SPC 1017, 1017H, 1608 or 1608H)	3
Humanities/Fine Arts Approved Course****			3
Mathematics One college-level course with a MAC, MAP, MAS, MAT, MGF, MTG or STA prefix			3
ECO	2013	Principles of Macroeconomics or (Honors)	3
PHI	1631	Studies in Professional Ethics <b>OR</b> (PHI 1600, 1602H, 2635 or 2649)	3
CGS	1100	Microcomputer Applications	3

**CORE AND SUPPORT COURSES (40 CREDITS) SUGGESTED SEQUENCING IS AS FOLLOWS:**

**OPTION A: MANAGEMENT (MGMT) (40 credits)**

**YEAR 1 TERM I (9 credits)**

ACG	2021	Financial Accounting	3
ACG	2071	Managerial Accounting	3
ECO	2023	Principles of Microeconomics or (Honors)	3

**YEAR 1 TERM II (9 credits)**

BUL	2241	Business Law I	3
GEB	1011	Introduction to Business	3
MAN	2021	Principles of Management	3

**YEAR 1 TERM III (3 credits)**

OST	2335	Professional Communication Skills	3
-----	------	-----------------------------------	---

**YEAR 2 TERM I (9 credits)**

MAR	2011	Principles of Marketing	3
CGS	2103	Advanced Microcomputer Applications	3
GEB	2350	Survey of International Business	3

**YEAR 2 TERM II (10 credits)**

MAN	2340	Human Factors in Supervision	3
MAN	2582	Introduction to Project Management	3
MAN	2940	Internship <b>OR</b>	4
MAN	2949	Co-Op Work Experience	(4)

**OR**

**OPTION B: MARKETING (MKT) (40 credits)**

## MINUTES OF THE SPECIAL MEETING OF MARCH 16, 2010

### BOARD OF TRUSTEES OF ST. PETERSBURG COLLEGE

#### YEAR 1 TERM I (9 credits)

ACG	2021	Financial Accounting	3
ACG	2071	Managerial Accounting	3
ECO	2023	Principles of Microeconomics or (Honors)	3

#### YEAR 1 TERM II (9 credits)

BUL	2241	Business Law I	3
GEB	1011	Introduction to Business	3
MAN	2021	Principles of Management	3

#### YEAR 1 TERM III (3 credits)

OST	2335	Professional Communication Skills	3
-----	------	-----------------------------------	---

#### YEAR 2 TERM I (9 credits)

MAR	2011	Principles of Marketing	3
MAR	1142	Global Marketing	3
MAR	2321	Advertising	3

#### YEAR 2 TERM II (10 credits)

MKA	2021	Sales	3
MKA	2512	Sales Promotion and Public Relations	3
MKA	2940	Internship <del>OR</del>	<u>4</u>
MKA	2949	Co-Op Work Experience	4

### **TOTAL PROGRAM HOURS**

**64**

\*\*\*\*To provide students with an enhanced world view in light of an increasingly globalized economy, students must include at least one of the following courses as part of the general education requirements for the Associate in Science degree:

LIT	2110	World Literature I
LIT	2110H	Honors World Literature I
LIT	2120	World Literature II
LIT	2120H	Honors World Literature II
HUM	2270	Humanities (East-West Synthesis)
HUM	2270H	Honors Humanities (East-West Synthesis)
REL	2300	World Religions
INR	2002	International Relations
INR	2002H	Honors International Relations
WOH	2040	The Twentieth Century
WOH	2040H	Honors The Twentieth Century

### **PROGRAM CHANGE – AAS DEGREE**

## **INDUSTRIAL MANAGEMENT TECHNOLOGY (INMG-AAS)**

### **ASSOCIATE IN APPLIED SCIENCE DEGREE**

<http://www.spcollege.edu/program/INMG-AAS>

The Industrial Management Technology program is an articulated program with the Pinellas County School System designed to provide opportunities for students who have completed postsecondary certificate programs, registered apprenticeship programs, or state certification to receive credit in the Industrial Management Technology program. This degree provides persons currently working in industry an opportunity to pursue college level education that is appropriate for management roles and upward mobility in their respective fields. Credit will be awarded on the basis of a 75 clock hours: 1 college credit ratio with a maximum of 24 credits.

#### **\*\*\*\*GENERAL EDUCATION REQUIREMENTS (21 credits)**

ENC	1101	Composition I or (Honors)	3
SPC	1065	Business and Professional Speaking <b>OR</b> (SPC 1017, 1017H, 1608 or 1608H)	3



## MINUTES OF THE SPECIAL MEETING OF MARCH 16, 2010

### BOARD OF TRUSTEES OF ST. PETERSBURG COLLEGE

Humanities/Fine Arts Approved Course****	3
Mathematics One college-level course with a MAC, MAP, MAS, MAT, MGF, MTG or STA prefix	3
Social & Behavioral Sciences Approved Course****	3
PHI 1631 Studies in Professional Ethics <b>OR</b> (PHI 1600, 1602H, 2635 or 2649)	3
CGS 1100 Microcomputer Applications	3

#### **PROGRAM REQUIREMENTS: Select 15 credits**

ACG 2001 Applied Financial Accounting I	3
ETI 1701 Industrial Safety	3
GEB 1011 Introduction to Business	3
MAN 2021 Principles of Management	3
MAN 2340 Human Factors in Supervision	3
MAN 2582 Introduction to Project Management	3
OST 2335 Professional Communication Skills	3
SBM 1000 Small Business Entrepreneurship	3

**TOTAL SPC CREDITS 36**

**PTEC CERTIFICATE / REGISTERED APPRENTICESHIP / STATE CERTIFICATION \*24**

**\* ELECTIVES: Students awarded less than 24 credits must satisfy the difference with elective credits**

BUL 2241 Business Law I	(3)
CGS 1000 Introduction to Computers and Programming	(3)
CGS 1515 Spreadsheet Techniques and Programs	(3)
CNT 1000 Local Area Network Concepts	(3)
COP 1822 Introduction to Web Page Creation	(1)
MAN 2940 Internship <b>OR</b>	(1-3)
MAN 2949 Co-op Work Experience	(1-3)

**TOTAL PROGRAM HOURS 60**

\*\*\*\*To provide students with an enhanced world view in light of an increasingly globalized economy, students must include at least one of the following courses as part of the general education requirements for the Associate in Science degree:

LIT 2110	World Literature I
LIT 2110H	Honors World Literature I
LIT 2120	World Literature II
LIT 2120H	Honors World Literature II
HUM 2270	Humanities (East-West Synthesis)
HUM 2270H	Honors Humanities (East-West Synthesis)
REL 2300	World Religions
INR 2002	International Relations
INR 2002H	Honors International Relations
WOH 2040	The Twentieth Century
WOH 2040H	Honors The Twentieth Century

#### **PINELLAS TECHNICAL EDUCATION CENTER (PTEC)**

##### **24 Credit (1800 – 1900 Hour) Certificate Program**

- Architectural Drafting
- Automotive Service Technology
- Medium & Heavy Duty Truck & Bus Technician

##### **22 Credit (1650 – 1680 Hour) Certificate Program + \*2 Elective Credits**

- Commercial Photography Technology
- Computer Systems Technology
- Jewelry Making & Repair

##### **20 Credit (1500 Hour) Certificate Program + \*4 Elective Credits**

- Commercial Art Technology
- Commercial Foods & Culinary Arts
- Digital Video Production
- Machining

## MINUTES OF THE SPECIAL MEETING OF MARCH 16, 2010

### BOARD OF TRUSTEES OF ST. PETERSBURG COLLEGE

#### **18 Credit (1350 – 1400 Hour) Certificate Program + \*6 Elective Credits**

- Air Conditioning, Refrigeration & Heating Technology
- Automotive Collision Repair & Refinishing
- Electronics Technology
- Marine Service Technology

#### **16 Credit (1170 or 1200 Hour) Certificate Program + \*8 Elective Credits**

- Applied Welding Technology (1170 Hours)
- Cabinet Making and Millwork (1200 Hours)
- Culinary Operations (Restaurant Mgmt) (1200 hours)
- Electricity (1200 Hours)

#### **14 Credit (1050 Hour) Certificate Program + \*10 Elective Credits**

- Building Construction Technology

#### **12 Credit (960 Hour) Certificate Program + \*12 Elective Credits**

- Plumbing Technology

#### **8 Credit (600 Hour) Certificate Program + \*16 Elective Credits**

- Telecommunications Technology

### **REGISTERED APPRENTICESHIP PROGRAMS**

#### **24 Credits Awarded (Four or Five Year Registered Apprenticeship Program)**

- Automotive Collision Repair & Refinishing
- Automotive Service Technology
- Electrician
- Industrial Machinery Maintenance
- Industrial Pipefitter
- Machining
- Plumbing Technology
- Refrigeration Technology

#### **18 Credits Awarded (Three Year Registered Apprenticeship Program) + \*6 Elective Credits**

- Brick & Block Masonry
- Industrial Pipefitter
- Fire Fighter II

#### **12 Credits Awarded (Two Year Registered Apprenticeship Program) + \*12 Elective Credits**

- Automotive Service Technology
- Building Construction Technology
- Nursery Technician
- Roadway Technician

### **STATE CERTIFICATION PROGRAMS**

#### **24 Credits Awarded**

- Class A Water or Wastewater Treatment Operator Certificate Issued by the State of Florida
- Class A Water Distribution, Wastewater Collection or Stormwater Management System Operator Certificate Issued by the Florida Water and Pollution Control Operator Association
- International Municipal Signal Association (IMSA) Signs and Markings Specialist and Traffic Signal Technician Certificate Program – Level 3
- Florida Department of Transportation Maintenance of Traffic – Advanced

#### **12 Credits Awarded + \*12 Elective Credits**

- Class B Water or Wastewater Treatment Operator Certificate Issued by the State of Florida
- Class B Water Distribution, Wastewater Collection or Stormwater Management System Operator Certificate Issued by the Florida Water and Pollution Control Operator Association
- Stormwater Management System Operator Certificate Issued by the Florida Stormwater Association –Level 2
- International Municipal Signal Association (IMSA) Signs and Markings Specialist and Traffic Signal Technician Certificate Program – Level 2
- Florida Department of Transportation Maintenance of Traffic – Intermediate

#### **6 Credits Awarded + \*18 Elective Credits**

- Class C Water or Wastewater Treatment Operator Certificate Issued by the State of Florida
- Class C Water Distribution, Wastewater Collection or Stormwater Management System Operator Certificate Issued by the Florida Water and Pollution Control Operator Association
- Stormwater Management System Operator Certificate Issued by the Florida Stormwater Association – Level 1
- International Municipal Signal Association (IMSA) Signs and Markings Specialist and Traffic Signal Technician Certificate Program – Level 1
- Florida Department of Transportation Maintenance of Traffic – Basic

**MINUTES OF THE SPECIAL MEETING OF MARCH 16, 2010**

**BOARD OF TRUSTEES OF ST. PETERSBURG COLLEGE**

**PROGRAM CHANGE – CT PROGRAM**

**BUSINESS ADMINISTRATION  
(BUSADM-CT)**

**CERTIFICATE**

<http://www.spcollege.edu/program/BUSADM-CT>

**Dr. Sharon Setterlind, SP/G (727) 341-4724 or Nancy Russell, SP/G (727) 341-4724**

The business courses identified in this Certificate program will apply towards the Business Administration AS degree. These courses will cover the areas of personnel, accounting and finance, marketing, legal requirements and budgeting and planning.

**PROGRAM REQUIREMENTS**

ACG	2021	Financial Accounting	3
BUL	2241	Business Law I	3
CGS	1100	Microcomputer Applications	3
GEB	1011	Introduction to Business	3
MAN	2021	Principles of Management	3
MAN	2340	Human Factors in Supervision	3
MAR	2011	Principles in Marketing	3
Any Business Co-op Work Experience Course <b>OR</b> Internship			3

**TOTAL CERTIFICATE HOURS** **24**

**PROGRAM CHANGE – CT PROGRAM**

**COMPUTER/WEB PROGRAMMING SPECIALIST CERTIFICATE  
(CWPS-CT)**

**Dr. Sharon Setterlind, SP/G (727) 341-4724 or Dr. Holly Hoopes, CL (727) 791-2530**

**Job Related Opportunities:**

- Application Developer
- Application and Computer Programmer
- Client/Server Developer
- Internet/Intranet Administrator
- Internet/Intranet Developer
- Internet/Intranet Master
- Internet/Intranet Technician
- Software Developer
- Web Administrator
- Web Master
- Web Systems Architect
- Web Technician
- Web Site Developer
- Web Programmer

## MINUTES OF THE SPECIAL MEETING OF MARCH 16, 2010

### BOARD OF TRUSTEES OF ST. PETERSBURG COLLEGE

This certificate is designed to develop student proficiency in programming and to introduce the student to the variety of skills necessary to create dynamic Web content and transaction-based Web systems. On completion of the program the student will be expected to enter the job market as an entry-level programmer.

#### **PROGRAM REQUIREMENTS (9 credits)**

CGS	1000	Introduction to Computers and Programming	3
CGS	1822	Web Site Essentials	2
COP	1822	Introduction to Web Page Creation (Topic: HTML)	1
COP	2823	Advanced Web Page Creation	3

#### **Complete any two of four computer/web programming languages below (18 credits):**

##### **Computer/Web Programming Language A: PHPL (9 credits)**

CGS	1178	Web Scripting with CGI/PERL & JavaScript	(3)
COP	1842	Developing Web Sites using PHP/MySQL	(3)
COP	2843	Advanced PHP/MySQL	(3)

##### **Computer/Web Programming Language B: C/C++/C# (9 credits)**

CGS	2402	Programming in C++ for Business	(3)
COP	2360	Introduction to C# Programming	(3)
COP	2362	Advanced Programming with C#	(3)

##### **Computer/Web Programming Language C: Java (9 credits)**

COP	2250	Java Programming I	(3)
COP	2800	Java Programming II	(3)
COP	2806	Java Server Pages and Servlets	(3)

##### **Computer/Web Programming Language D: VB.NET (9 credits)**

COP	2837	Visual Basic.Net Programming I	(3)
COP	2838	Visual Basic.Net Programming II	(3)
COP	2839	ASP.NET Programming With VB.NET	(3)

#### **ELECTIVES – Select 8 credits:**

CGS	1874	Introduction to Flash	(3)
CGS	2823	Advanced Web Site Development	(3)
<b>CGS</b>	<b>2XXX</b>	<b>* Flash/ActionScripting</b>	<b>(3)</b>
CNT	1000	Local Area Network Concepts	(3)
COP	2801	JavaScript	(3)
COP	2940	Internship OR	(1-3)
<del>COP</del>	<del>2940</del>	<del>Co-op Work Experience</del>	<del>(1-3)</del>
CTS	1120	Introduction to Network Security Foundations	(3)
MAN	2582	Introduction to Project Management	(3)

**TOTAL CERTIFICATE HOURS 35**

\* Not submitted to C&I

### **PROGRAM CHANGE – AS DEGREE**

### **HUMAN SERVICES SOCIAL SERVICES (HSDIS-AS) OR ALCOHOL/SUBSTANCE ABUSE (HSM-AS)**

#### **ASSOCIATE IN SCIENCE DEGREE**

<http://www.spcollege.edu/program/HSDIS-AS>

<http://www.spcollege.edu/program/HSM-AS>

## MINUTES OF THE SPECIAL MEETING OF MARCH 16, 2010

### BOARD OF TRUSTEES OF ST. PETERSBURG COLLEGE

Cheryl Kerr, Program Director (727) 341-3736

General education and support courses do not have to be taken in the order listed. Please see a counselor or advisor.

#### **\*\*\*\*GENERAL EDUCATION COURSES (18 credits)**

ENC	1101	Composition I or (Honors)	3
ENC	1102	Composition II <b>OR</b> (any approved Literature course) ****	3
SPC	1017	Introduction to Speech Communication <b>OR</b> (SPC 1017H, 1065, 1608 or 1608H)	3
Humanities/Fine Arts Approved Course (HUM 2270, HUM 2270H or REL 2300) ****			3
Mathematics	<sup>a, b</sup>	One college-level course with MAC, MAP, MAS, MGF, MTG or STA prefix	3
Social and Behavioral Sciences Approved Course (PSY 1012 or Honors)			(3)
PHI	1600	Studies in Applied Ethics <b>OR</b> (PHI 1602H, 1631, 2635 or 2649)	3
Computer/Information Literacy Competency Requirement			

#### **SUPPORT COURSES (9 credits) - A grade of "C" or higher is required**

BSC	XXXX	Any college-level Biology course	3
PSY	1012	<sup>1</sup> General Psychology or (Honors)	3
DEP	2004	<sup>1</sup> Developmental Psychology of the Life Span <b>OR</b>	3
DEP	2102	Child Development <b>OR</b>	(3)
DEP	2302	Adolescent Development	(3)

#### **MAJOR COURSES (31 credits) - A grade of "C" or higher is required**

HUS	1001	<sup>1</sup> Principles and Strategies for Human Services	3
SYG	2324	<sup>2</sup> Principles of Substance Abuse	3
HUS	1111	<sup>1, 2</sup> Introduction to Intra- and Inter-Personal Processes	3
HUS	1320	Theories and Foundations of Crisis Intervention	1
HUS	1013	Self-Esteem in Human Services	3
HUS	2200	<sup>2</sup> Dynamics of Groups and Group Counseling	3
HUS	2302	<sup>2</sup> Basic Counseling Skills	3
HUS	2315	Studies in Behavior Modification	3
HUS	2540	<sup>1</sup> Building Stronger Families and Communities	3
HUS	2550	<sup>1</sup> Social Services and the Disenfranchised	3
HUS	2949	<sup>1</sup> Co-op Work Experience	3

#### **OPTION A: SOCIAL SERVICES (HSDIS) (7 credits) - A grade of "C" or higher is required**

HUS	1530	Survey of Developmental Disabilities	3
HUS	1445	Practices for Working with Dysfunctional Family Systems	2
HUS	XXXX	<sup>2, c</sup> HUS electives	2

**TOTAL PROGRAM HOURS 65**

**OR**

#### **OPTION B: ALCOHOL/SUBSTANCE ABUSE (HSM) (15 credits) - A grade of "C" or higher is required**

HUS	2403	<sup>2</sup> Abused Substances and Their Effects	3
HUS	2420	<sup>2</sup> Evaluation of Treatment Environments	3
HUS	2421	<sup>2</sup> Methods for Identification & Intervention in Substance Abuse	3
HUS	2428	<sup>2</sup> Treatment & Resources in Substance Abuse	3
HUS	XXXX	<sup>1, c</sup> HUS electives	3

**TOTAL PROGRAM HOURS 73**

<sup>a</sup> ~~If you take MAT 1033, your degree will be an AAS instead of an AS. Transferability is not guaranteed with the AAS degree.~~

<sup>b</sup> Students pursuing a four-year degree are encouraged to take MAC 1105 or a higher Math course.

<sup>c</sup> Any course with a HUS prefix not already taken including HUS 2949.

<sup>1</sup> Applies to the Youth Development Professional and/or Maternal Child Health ATD programs.

<sup>2</sup> Applies to the Associate Addiction Professional ATD program.

## MINUTES OF THE SPECIAL MEETING OF MARCH 16, 2010

### BOARD OF TRUSTEES OF ST. PETERSBURG COLLEGE

\*\*\*\*To provide students with an enhanced world view in light of an increasingly globalized economy, students must include at least one of the following courses as part of the general education requirements for the Associate in Science degree:

LIT	2110	World Literature I
LIT	2110H	Honors World Literature I
LIT	2120	World Literature II
LIT	2120H	Honors World Literature II
HUM	2270	Humanities (East-West Synthesis)
HUM	2270H	Honors Humanities (East-West Synthesis)
REL	2300	World Religions
INR	2002	International Relations
INR	2002H	Honors International Relations
WOH	2040	The Twentieth Century
WOH	2040H	Honors The Twentieth Century

**10-077.** President Furlong provided a legislative update under Item IX-I. He noted he would be heading to Tallahassee this week to cover the Council of Presidents meeting and then again in two weeks. He further noted that he and Mr. Ed Woodruff, SPC's legislative liaison, are getting feedback from the staff on a number of substantive, yet slow-moving, issues (i.e., 911 bill, retirement bill, nursing accreditation bill, etc.) that may impact the College. He reported on the recent naming of three new State Board of Education members, who have all now been contacted and have expressed interest in SPC. He provided a revenue update, noting that Mr. John Andrew Smith, who is contracted to monitor SPC's budget in the Legislature, is this Monday briefing the presidents and staff from SPC, the University of South Florida, and the State College of Florida, Manatee-Sarasota, to determine what can realistically be done in the budget. He further noted that SPC's share of PECO funds this year will all be renovation and remodeling money, which is being handled by former SPC Facilities employee Lisa Cook, now Director of Facilities Planning & Budgeting for the Florida College System.

President Furlong reported on the following highlights from an e-mail received from Dr. John Holdnak, Vice Chancellor for Financial Policy, Florida College System, regarding House and Senate budget proposals:

- The allocations from legislative leadership to the Senate and House appropriation committees for higher education began \$300 million apart, with the Senate committee authorized for the larger amount.
- Tuition increases are being proposed on both sides at 8 percent.
- Overall, the Senate proposal (including federal funds) would result in a 5.4 percent increase in funding for the system over 2009-10 funding, while the House proposal results in a decrease of 5.8 percent.
- The Senate proposal fully funds operation costs for new facilities, while the House proposal only funds the annualized portion of that.
- There is no matching money for the Philip Benjamin Matching Program or for the Facilities Challenge Grant Program at this point. When funds become available, matches should occur.

## MINUTES OF THE SPECIAL MEETING OF MARCH 16, 2010

### BOARD OF TRUSTEES OF ST. PETERSBURG COLLEGE

- Both sides, at this point, in very different ways, are proposing covering an increase in FRS retirement.

In summary, President Furlong stated though it is too early to determine outcomes, based on today, he would anticipate no new money except for revenue from tuition increases. He said the College is positioned well with reserves going into the budget process, and the big drop off next year will be the federal stimulus funds going away.

In response to Mr. Gibbons, the president said the Governor's budget, in terms of increase, reflected no tuition increase and a significant increase in new state money. Mr. Johnston sought the president's thoughts on when the state budget might turn around. The president said he anticipates no dramatic changes and when the economy does improve, enrollment would most likely drop. He shared lower-division and upper-division scenarios and noted that arguments continue for SPC to be exempt from a moratorium on new baccalaureate programs unless universities are subject to the same. Dr. Furlong noted the need for SPC to be a strong voice with the Council of 100, as SPC's bachelor degree issues are very different from those at the other 27 colleges because of the scope of our many majors. Mr. Gibbons shared feedback from legislators who want to look out for SPC since it has been a national model in the baccalaureate effort. He said he feels the College should be rewarded for these efforts and should be pressing for some of the Governor's budget to come to SPC.

President Furlong noted a forthcoming *St. Petersburg Times* article on the Baccalaureate Master Plan resulting from an interview regarding the SPC model.

Mr. Burke inquired as to the proposed retirement bill, since it was his understanding a majority of it would affect the calculation of retirement benefits for SPC's current employees if it passes in its current form. He asked if there has been an effort on the College's part to educate employees of the bill's effects so they can voice concerns to legislators. Dr. Furlong responded that SPC employees are not considered state employees and are, therefore, not currently affected by the bill unless it is amended. He noted that statewide Human Resources staff are exchanging e-mails on this issue. At Mr. Burke's request, he agreed to communicate the effects of this bill to College staff and state the College's position should the bill affect all FRS employees.

*Following this item, Mr. Burke ended his conference phone participation.*

**10-078.** The chairman opened the meeting for other business, including items of interest from the Board members.

Dr. Tonjua Williams, Vice President of Academic & Student Affairs, was joined by Mr. Pat Rinard, Associate Vice President of Enrollment Management, in presenting an overview of SPC's Student Affairs Model, which addressed many aspects of the student services process, including enrollment, recruitment, access, delivery of student services, etc. The Board

## **MINUTES OF THE SPECIAL MEETING OF MARCH 16, 2010**

### **BOARD OF TRUSTEES OF ST. PETERSBURG COLLEGE**

discussed efforts made to address problem developmental areas, such as math, and adequate staffing to handle the many student needs on campus. Dr. Furlong reported that SPC was granted the WorkNet funds for short-term positions to assist with understaffing, an opportunity approved previously by the Board, and those funds have been matched.

On behalf of the Board, Chairman Brett commended those involved in the presentation. He asked Dr. Williams and Mr. Rinard what two best practices seen at other statewide community colleges could be implemented at SPC if the budget was not a concern. Mr. Rinard responded that his vision would be to have a robust back office process that can electronically meet the needs of remote students. He said Florida State College at Jacksonville is currently a model in this initiative. Dr. Williams responded that, although expensive, she would like to see one building on campus where all support services are located. In follow up to previous Board discussions and campus forums on textbook costs, Mr. Brett further asked what percentage of the Student Services budget is from textbook revenue. Dr. Furlong responded that this percentage is minimal, mostly funding student assistants. *(A copy of the PowerPoint presentation is included as **Attachment B – 10-078.**)*

**10-079.** On behalf of Ms. Ulmer, President Furlong distributed to the Board brochures featuring SPC Midtown's Women on the Way Resource Center.

**10-080.** President Furlong provided a status report on the Consular Corps College (CCC). He shared the staff's conclusion that, subject to Board agreement, the College would be better served to not continue the contract with CCC, which has been a tough model for success from its inception. He said only 7 members have been recruited toward the goal of 500, and an Executive Director has not yet been hired due to the uncertainty of this initiative going forward and the difficulty of SPC being a state-funded entity with a formal diversity-oriented hiring process and CCC being a private sector entity. He said it is overall a difficult time for the College's budget to support CCC becoming a unit of SPC. In consideration of the budget and other factors, the Board expressed their support of the president's recommendation to terminate the agreement, in cooperation with the General Counsel's office, and to instead consider a partnership with the Department of State, who has sought to possibly offer training courses at the Allstate Center for the consuls through SPC's Corporate Training program. He said this would prove to be a more cost effective, long-term model. He noted the new SPC bachelors program in Public Policy and the UPC graduate options with USF are also moving forward.

**10-081.** President Furlong announced the upcoming departure of Mr. Brian Fettig, Associate General Counsel, who has taken a position elsewhere. He noted the outstanding role



**MINUTES OF THE SPECIAL MEETING OF MARCH 16, 2010**

**BOARD OF TRUSTEES OF ST. PETERSBURG COLLEGE**

Mr. Fettig has played as an SPC staff member. The Board wished him well in his future endeavors.

**10-082.** The president noted that International Education has moved from being under Dr. Anne Cooper, Senior Vice President of Academic & Student Affairs, to now being under Dr. Karen White, St. Petersburg/Gibbs Campus Provost, and that Ms. Violetta Sweet, International Programs Director, is, therefore, now reporting to Dr. White. He further noted that the Downtown/Midtown sites are now under Ms. Yvonne Ulmer, as approved by the Board in today's Personnel Report.

**10-083.** The Board confirmed its next regular meeting as Wednesday, April 21, 8:30 a.m., at the EpiCenter.

**10-084.** Having no further business to come before the Board, Chairman Brett adjourned the meeting at 10:30 a.m.

---

**Thomas E. Furlong, Jr.**

**Secretary, Board of Trustees**  
St. Petersburg College  
FLORIDA

---

**Terrence E. Brett**

**Chairman, Board of Trustees**  
St. Petersburg College  
FLORIDA